

Product List

Please note

This product list includes all parts necessary for most applications.
For parts required for special applications, please refer to the MEVA price list. Dimensions are in centimetres (cm) unless a different unit is shown.

Contents

Brace frame 250	43
Cotter pin 4	45
Double-jointed foot plate.....	44
Flange screw 18.....	43
Formwork-prop connector.....	43
Head bolt 16/90 galv.	45
Ladder fixture panel SB.....	42
Ladder fixture railing SB.....	42
Lifting hook 60	46
Linchpin 4.5.....	45
M crane hook	45
MIS front railing post.....	41
MIS handrail	41
MIS lifting arm M 1750.....	46
MIS linkage.....	37
MIS linkage extension.....	38
MIS platform 125	37
MIS platform 250	36
MIS platform 250 with hatch.....	36
MIS platform extension 300 left.....	40
MIS platform extension 300 right	39
MIS platform extension 500 left.....	39
MIS platform extension 500 right	38
MIS side railing	40
Push-pull prop R	44
SRL brace.....	44

Safety System

MIS – MEVA Integrated Safety

MIS platform 250

Galvanized with aluminium flooring. Foldable platform for secure attachment to the Mammut XT panel with a width of 250 cm. With formwork-prop connectors for push-pull props and brace frames as well as integrated assembly lock holders and tie rod holders. Working width 90 cm. Permissible loading 150 kg/m².

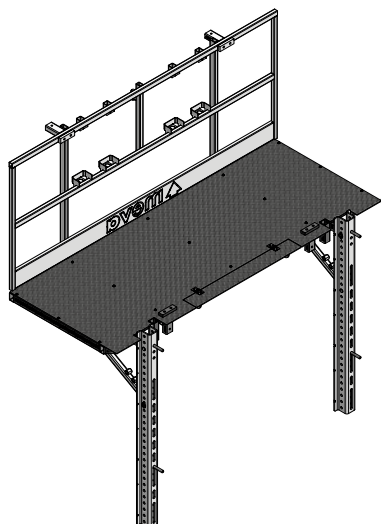

Ref. No.	Description / Application	m ²	kg
X22-0029 MIS platform 250.....		195.00

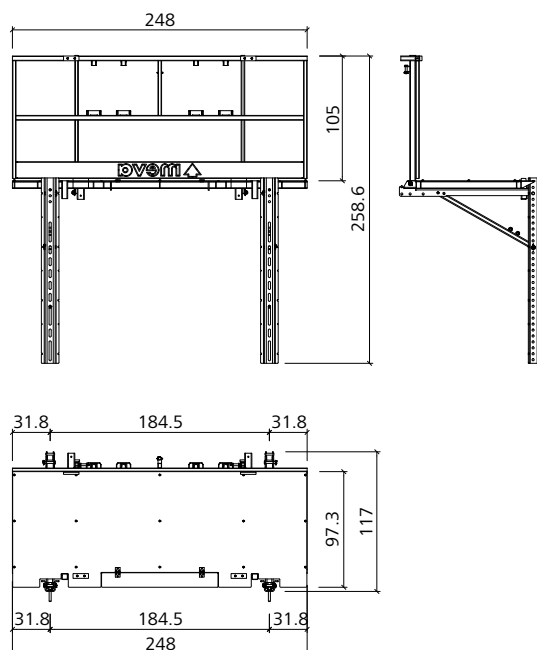

MIS platform 250 with hatch

Galvanized with aluminium flooring. Foldable platform with hatch and integrated ladder for secure attachment to the Mammut XT panel with a width of 250 cm. With formwork-prop connectors for push-pull props and brace frames as well as integrated assembly lock holders and tie rod holders. Working width 90 cm. Permissible loading 150 kg/m².

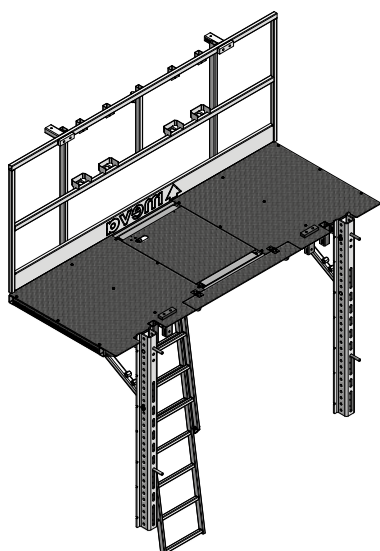

Ref. No.	Description / Application	m ²	kg
X22-0030 MIS platform 250 with hatch		230.00

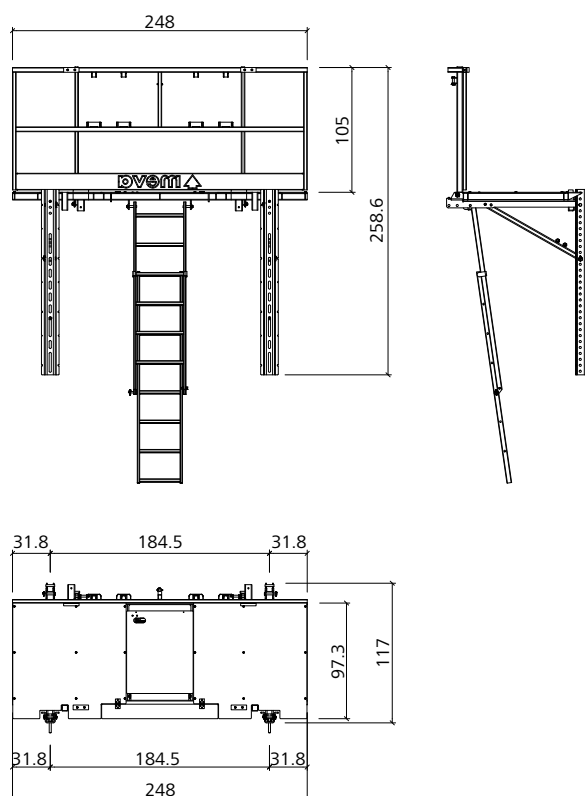

MIS platform 125

Galvanized with aluminium flooring. Foldable platform for secure attachment to the Mammut XT panel with a width of 125 cm. With form-work-prop connectors for push-pull props and brace frames as well as integrated assembly lock holders and tie rod holders. Working width 90 cm. Permissible loading 150 kg/m².

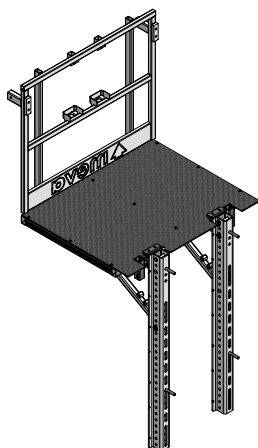

Ref. No.	Description / Application	m ²	kg
X22-0031	MIS platform 125		153.03

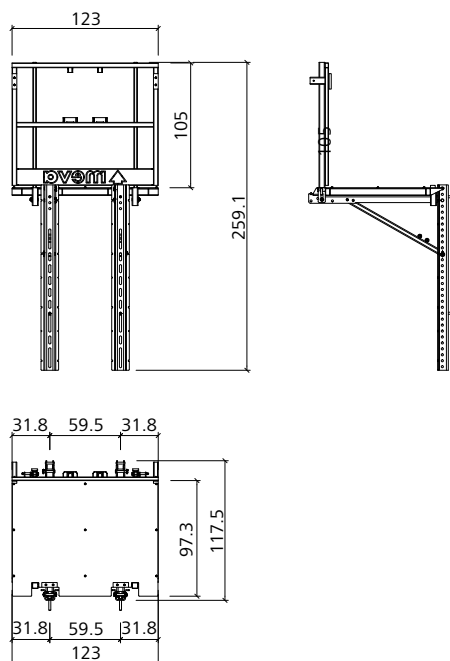

MIS linkage

Galvanized. Connects the MIS platform to the Mammut XT panel with two integrated screws 100 DW15/SW30. The position of the platform can be defined by selecting the attachment points. The MIS linkage is already installed on the MIS platform upon delivery.



Ref. No.	Description / Application	m ²	kg
X22-0041	MIS linkage		27.25

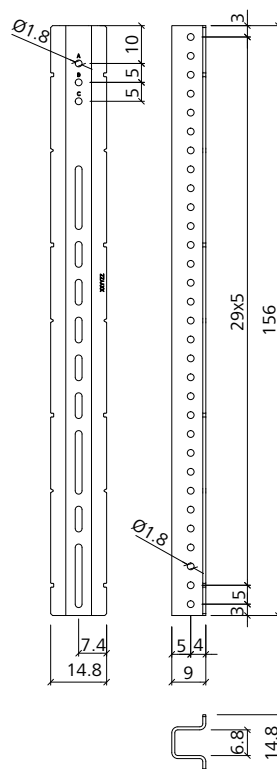

MIS linkage extension

Galvanized. Serves as an extension of the linkage with connecting coupling. Always use two linkage extensions. Two screws 100 DW15/SW30 must be ordered separately for each linkage extension.



Ref. No.	Description / Application	m ²	kg
X22-0042	MIS linkage extension	27.60	
31-312-05	Screw 100 DW15/SW30	0.28	

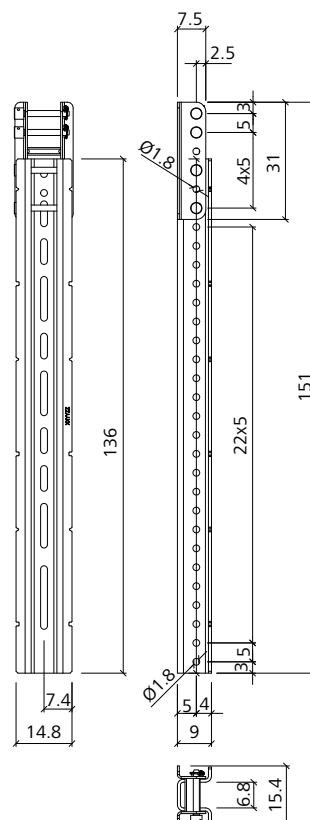

MIS platform extension 500 right

Galvanized with aluminium flooring. Inserted in the platform from the right-hand side and overlaps the platform flooring. It extends the MIS platform by 5 cm to 50 cm and can be locked in place in 2.5 cm steps. For length compensation the MIS side railing can be used as a rear railing.

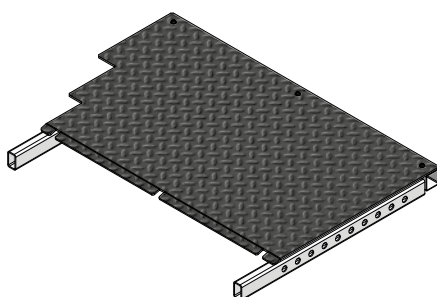

Ref. No.	Description / Application	m ²	kg
X22-0034	MIS platform extension 500 right	16.30	

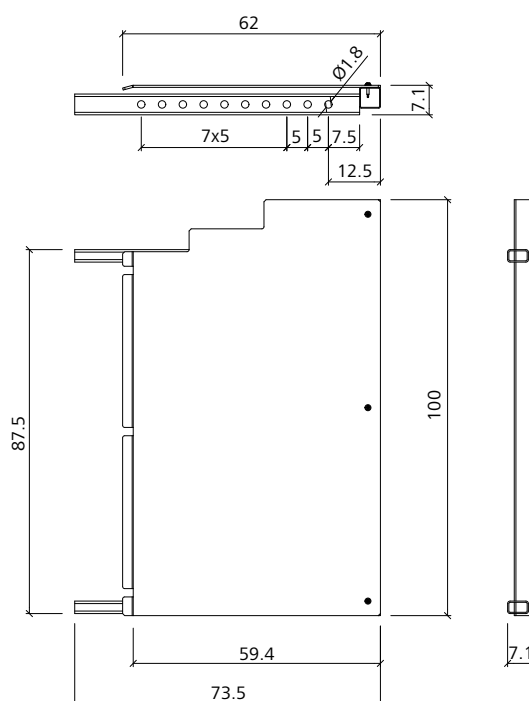

MIS platform extension 500 left

Galvanized with aluminium flooring. Inserted in the platform from the left-hand side and overlaps the platform flooring. It extends the MIS platform by 5 cm to 50 cm and can be locked in place in 2.5 cm steps. For length compensation the MIS side railing can be used as a rear railing.

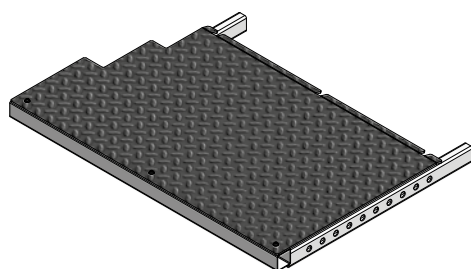

Ref. No.	Description / Application	m ²	kg
X22-0036	MIS platform extension 500 left		16.30

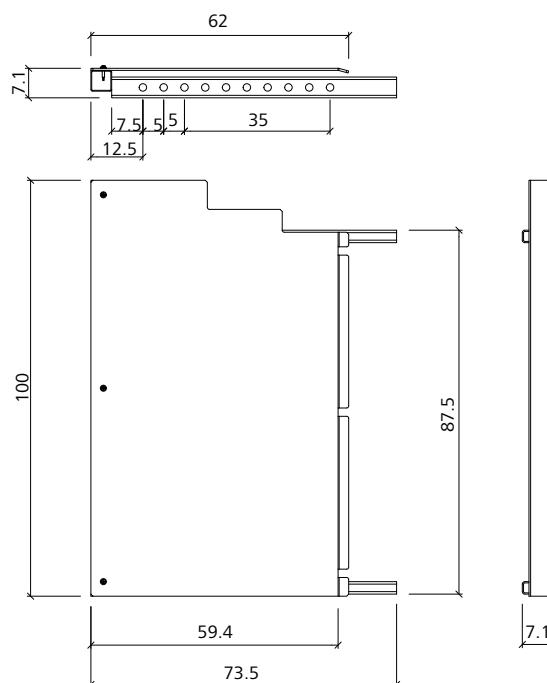

MIS platform extension 300 right

Galvanized with aluminium flooring. Inserted in the platform from the right-hand side and overlaps the platform flooring. It extends the MIS platform by 5 cm to 30 cm and can be locked in place in 2.5 cm steps. For length compensation the MIS side railing can be used as a rear railing.

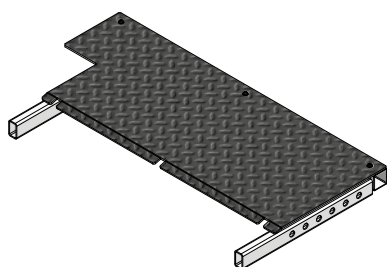

Ref. No.	Description / Application	m ²	kg
X22-0037	MIS platform extension 300 right		12.10

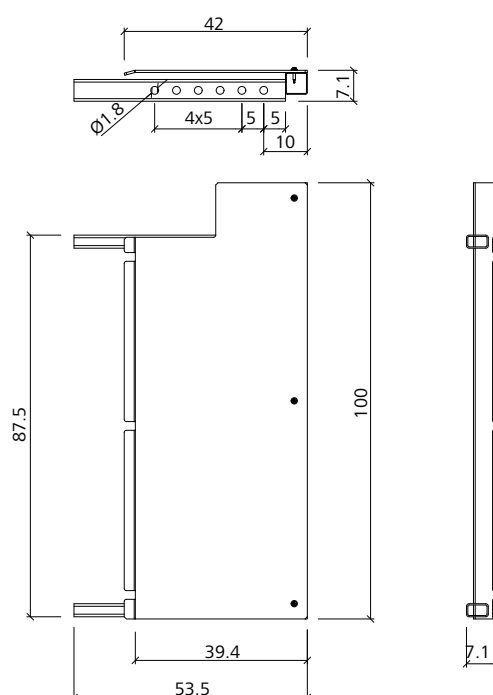

Safety System

MIS – MEVA Integrated Safety

MIS platform extension 300 left

Galvanized with aluminium flooring. Inserted in the platform from the left-hand side and overlaps the platform flooring. It extends the MIS platform by 5 cm to 30 cm and can be locked in place in 2.5 cm steps. For length compensation the MIS side railing can be used as a rear railing.

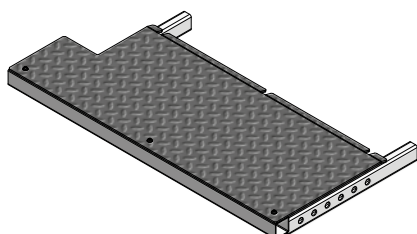

Ref. No.	Description / Application	m ²	kg
X22-0038	MIS platform extension 300 left		12.10

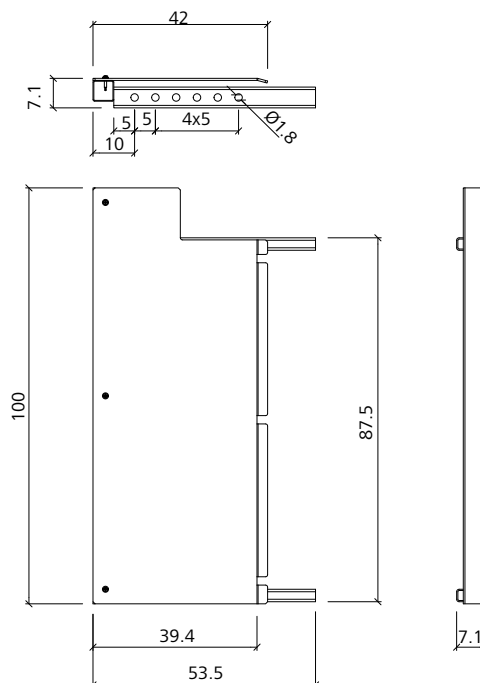

MIS side railing

Galvanized. Foldable. Can be locked in three positions and extended by 44 cm. Attached to the cross stiffener of the rear railing frame using the wedge connection. Serves as lateral fall protection on the MIS platform or as rear protection for the platform extension.

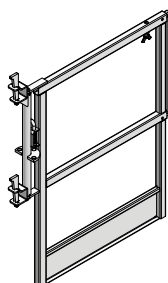

Ref. No.	Description / Application	m ²	kg
X22-0032	MIS side railing		14.50

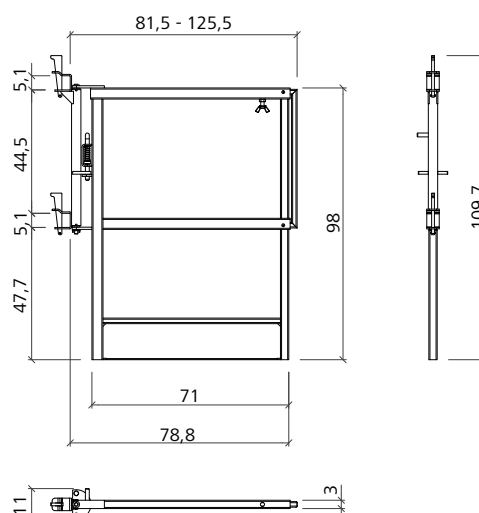

MIS front railing post

Galvanized. In connection with the MIS handrail, it serves as fall protection on the formwork side. The front railing must be configured to suit the formwork panel width. Two MIS front railing posts and two MIS handrails are always required.



Ref. No.	Description / Application	m ²	kg
X22-0033	MIS front railing post		6.73

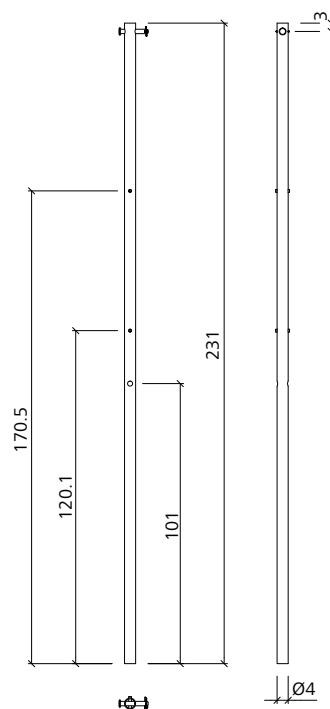

MIS handrail

Galvanized. It serves as fall protection on the formwork side in connection with the MIS front railing post. The front railing must be configured to suit the formwork panel width. Two MIS front railing posts and two MIS handrails are always required.

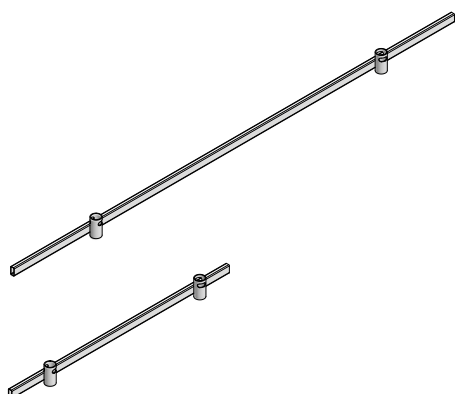

Ref. No.	Description / Application	m ²	kg
X22-0046	MIS handrail 250		4.83
X22-0047	MIS handrail 125		2.67

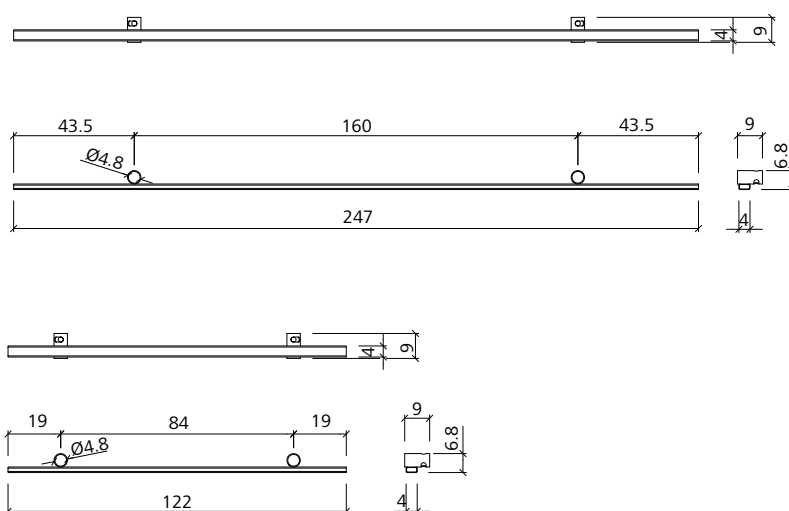

Ladder fixture railing SB

Galvanized. Used to attach the telescopic ladder to the uppermost handrail when a formwork unit is height-extended.

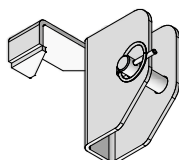

Ref. No.	Description / Application	m ²	kg
79-603-75 Ladder fixture railing SB.....		1.05

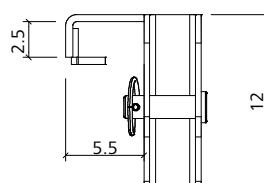
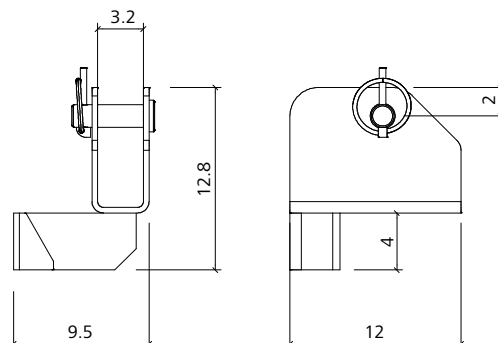

Ladder fixture panel SB

Galvanized. Used to attach the integrated ladder to the formwork panel. One flange screw 18 must be ordered separately.

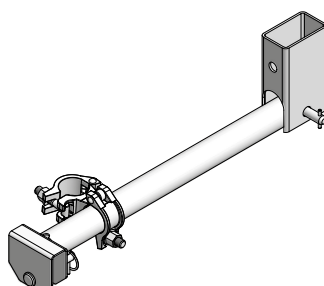

Ref. No.	Description / Application	m ²	kg
29-603-80 Ladder fixture panel SB		5.30

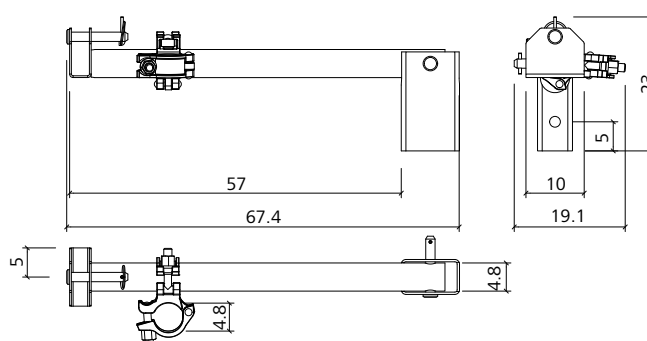

Brace frame 250

Galvanized. Used to align and brace the formwork and MIS platform. Consists of a push-pull prop R 250 (190 – 320), a brace SRL 120 (90 – 150) and a double-jointed foot plate. It is attached to the rails of the MIS platform using the head bolt 16/90 and the linchpin.

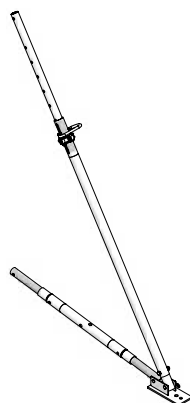

Ref. No.	Description / Application	m ²	kg
29-109-25	Brace frame 250		27.50

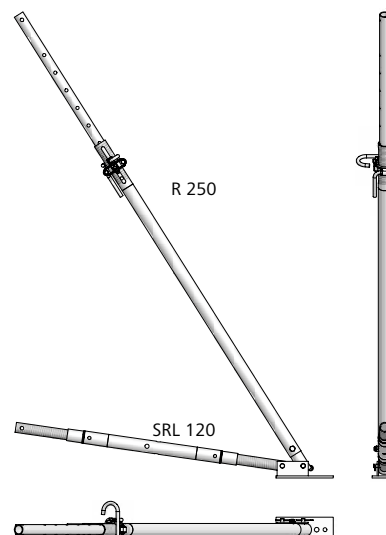

Formwork-prop connector

Galvanized. Including head bolt 16/90 and cotter pin 4. Used to connect brace frames, braces and push-pull props to the multi-function profile with flange screw 18. The maximum tube diameter of the braces and push-pull props is 48 mm.

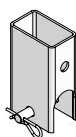

Ref. No.	Description / Application	m ²	kg
29-804-85	Formwork-prop connector		1.65

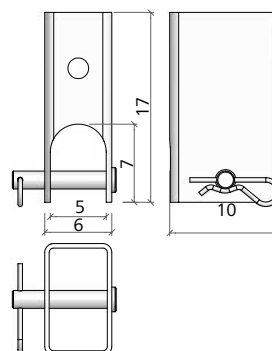

Flange screw 18

Galvanized. Used to attach accessories such as brace frames, push-pull props, alignment rails, etc. Thread length 18 cm.

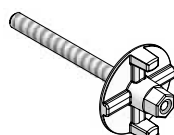

Ref. No.	Description / Application	m ²	kg
29-401-10	Flange screw 18		1.02

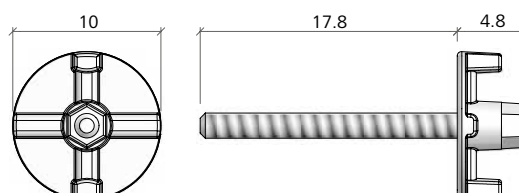

Push-pull prop R

Galvanized; guarantees tensile and compression strength. Used to align and support wall formwork. Length of thread 20.6 cm. The foot plate and formwork-prop connectors must be ordered separately.

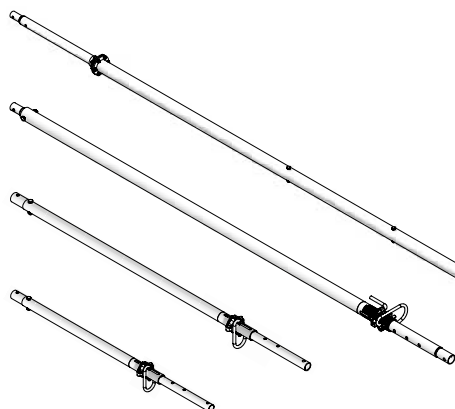

Ref. No.	Description / Application	m ²	kg
29-109-40 Push-pull prop R 160.....(135–200)		12.60
29-109-60 Push-pull prop R 250.....(190–320)		17.20
29-109-80 Push-pull prop R 460.....(340–520)		34.00
29-109-85 Push-pull prop R 630.....(510–760)		57.00

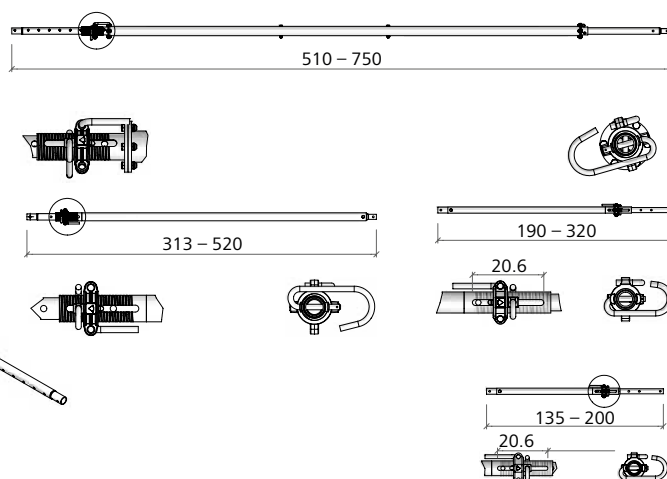

SRL brace

Galvanized; guarantees tensile and compression strength. Consists of a right- and left-hand threaded spindle as well as a rotating central section. Serves to additionally brace MIS platforms diagonally above a formwork height of 9.0 m. The foot plate and formwork-prop-connectors must be ordered separately.

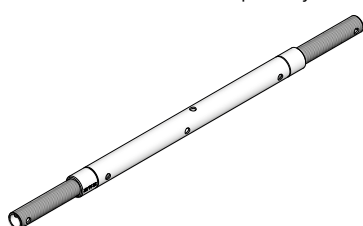

Ref. No.	Description / Application	m ²	kg
29-108-80 Brace SRL 120.....(90–150)		8.79

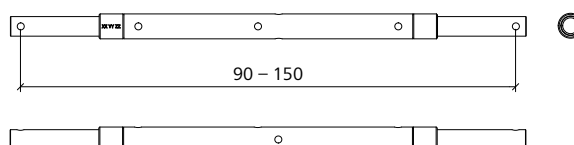

Double-jointed foot plate

Galvanized. Including head bolt 16/90 and cotter pin 4. Foot plate for the brace frame 250. The maximum tube diameter of the braces and push-pull props is 57 mm.

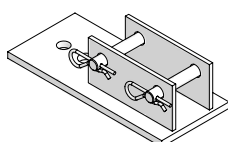

Ref. No.	Description / Application	m ²	kg
29-402-32 Double-jointed foot plate (prop diam. up to 57 mm)		4.00
79-427-50 Foot plate 60 (prop diam. up to 57 mm)		3.00

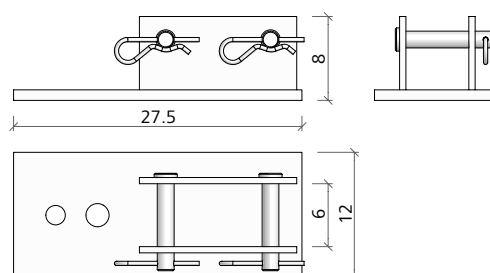

Safety System

MIS – MEVA Integrated Safety

Head bolt 16/90 galv.

Galvanized. Used to attach push-pull props and braces to foot plates and formwork-prop connectors.



Ref. No.	Description / Application	m ²	kg
42-413-50	Head bolt 16/90 galv.....		0.17

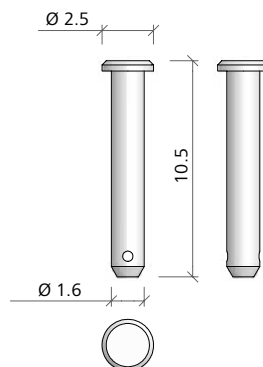

Cotter pin 4

Galvanized. Secures the head bolt.

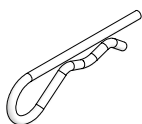

Ref. No.	Description / Application	m ²	kg
62-010-04	Cotter pin 4.....		0.02

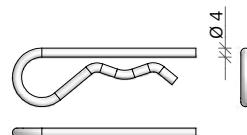

Linchpin 4.5

Not shown. Galvanized. Secures the head bolt.

Ref. No.	Description / Application	m ²	kg
62-010-03	Linchpin 4.5		0.01

M crane hook

Used to move panels. Self-locking; load capacity 15 kN (1.5 tons). Each gang requires two crane hooks. Refer to the operating instructions for use and safety inspection.

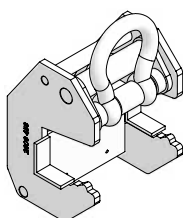

Ref. No.	Description / Application	m ²	kg
29-401-21	M crane hook.....		9.63

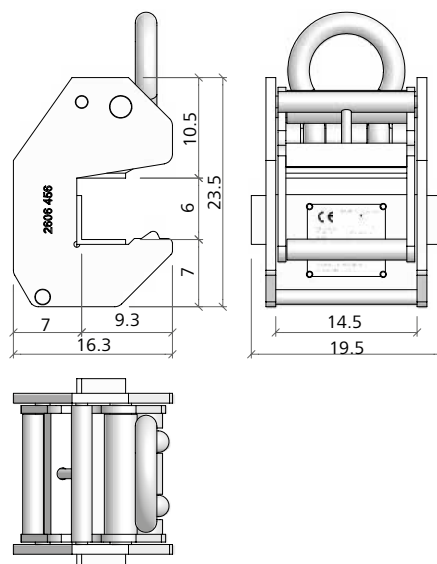

Safety System

MIS – MEVA Integrated Safety

MIS lifting arm M 1750

Galvanized. Use to erect, position and relocate the formwork with the MIS platform installed. The load capacity of each lifting arm is 17.5 kN (1.75 t). Two lifting arms are always required per transport unit.

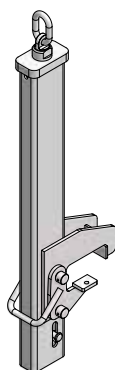

Ref. No.	Description / Application	m ²	kg
X22-0040	MIS lifting arm M 1750		25.20

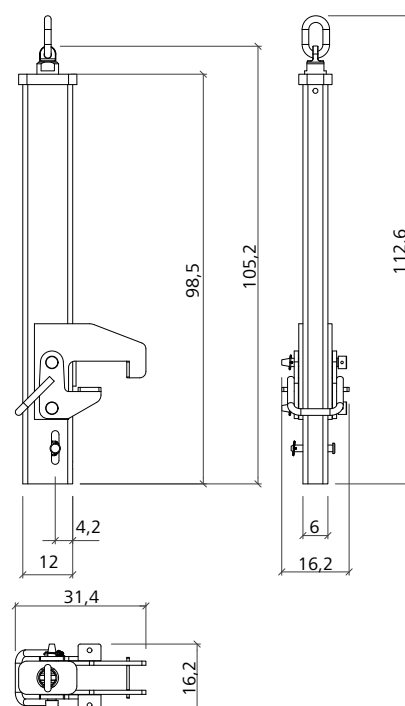

Lifting hook 60

Galvanized. Allows any 4-rope crane sling available on-site to be used to move panel stacks (always use four hooks at a time). Load capacity 10 kN (1 ton) per lifting hook, max. weight of a panel stack 2 tons. Refer to the operating instructions for use and safety inspection.

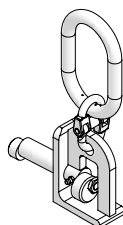

Ref. No.	Description / Application	m ²	kg
29-401-40	Lifting hook 60		1.70

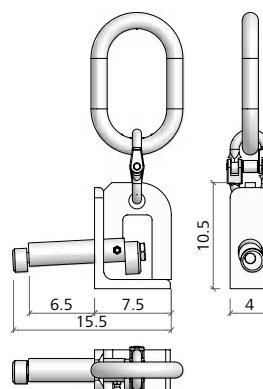



MEVA Schalungs-Systeme GmbH

Industriestrasse 5 Tel. +49 7456 692-01
72221 Haiterbach Fax +49 7456 692-66
Germany info@meva.net

www.meva.net