

Circular formwork

Product list

Please note

This product list includes all parts necessary for most applications. For parts required for special applications, please refer to the MEVA price list. Dimensions are in centimetres (cm) unless a different unit is shown.

Contents

Additional spindle 270-390 RS.....	43
Alignment rail RS	43
Alignment rails.....	45
Anchor rail RS.....	42
Articulated flange nut 20/140.....	47
Brace frame 250.....	48
Chamfer strip magnet RS.....	46
Combi-lock with coupling.....	41
Double-jointed foot plate.....	48
Flange screw.....	42
Foot spindle RS.....	44
Formwork-prop connector.....	48
Guardrailing post.....	49
Guardrailing post 48.....	50
Magnet RS 360 x 60 mm.....	46
Magnet RS d = 60/80.....	46
M-assembly lock.....	40
Radius panels.....	28
Ratchet removable RS.....	44
RS-assembly lock.....	40
Shoe for anchor rail RS.....	42
Spanner SW 36.....	47
Stop-end claw RS.....	44
Stop-end fixture RS.....	45
Tie rod DW 20/120.....	47
Top tie claw RS.....	43
Uni-assembly lock.....	41
Walkway bracket RS.....	49
Water stop 20.....	47

Circular formwork

Radius panels

Support profiles made of steel, galvanized, with steel facing. The integrated spindle-system of the pre-assembled panels allows for a stepless adjustment of the radii, starting with 2.50 m. The Radius panels have a Mammut edge profile for panel connection (12 cm high, 6 cm wide). Amount of tie points per panel height: 3x at panel height 350, 2x at panel height 300, 1x at panel height 150. M-assembly locks and Uni-assembly locks as well as the continuous groove guarantee for a stepless, tight and aligned panel connection. The welded-in DW threaded nuts allow for an easy, quick and safe attachment of accessory parts.

Ref.-No.	Description / Application	m ²	kg
23-805-05	RS-outside panel 350/250	8.75	780.0
23-805-30	RS-outside panel 300/250	7.50	678.0
23-805-70	RS-outside panel 150/250	3.75	369.5
23-805-20	RS-outside panel 350/125	4.38	419.0
23-805-40	RS-outside panel 300/125	3.75	364.0
23-805-80	RS-outside panel 150/125	1.88	198.0
23-806-05	RS-inside panel 350/240	8.40	761.0
23-806-30	RS-inside panel 300/240	7.20	662.5
23-806-70	RS-inside panel 150/240	3.60	361.0
23-806-20	RS-inside panel 350/120	4.20	409.5
23-806-40	RS-inside panel 300/120	3.60	356.0
23-806-80	RS-inside panel 150/120	1.80	193.5

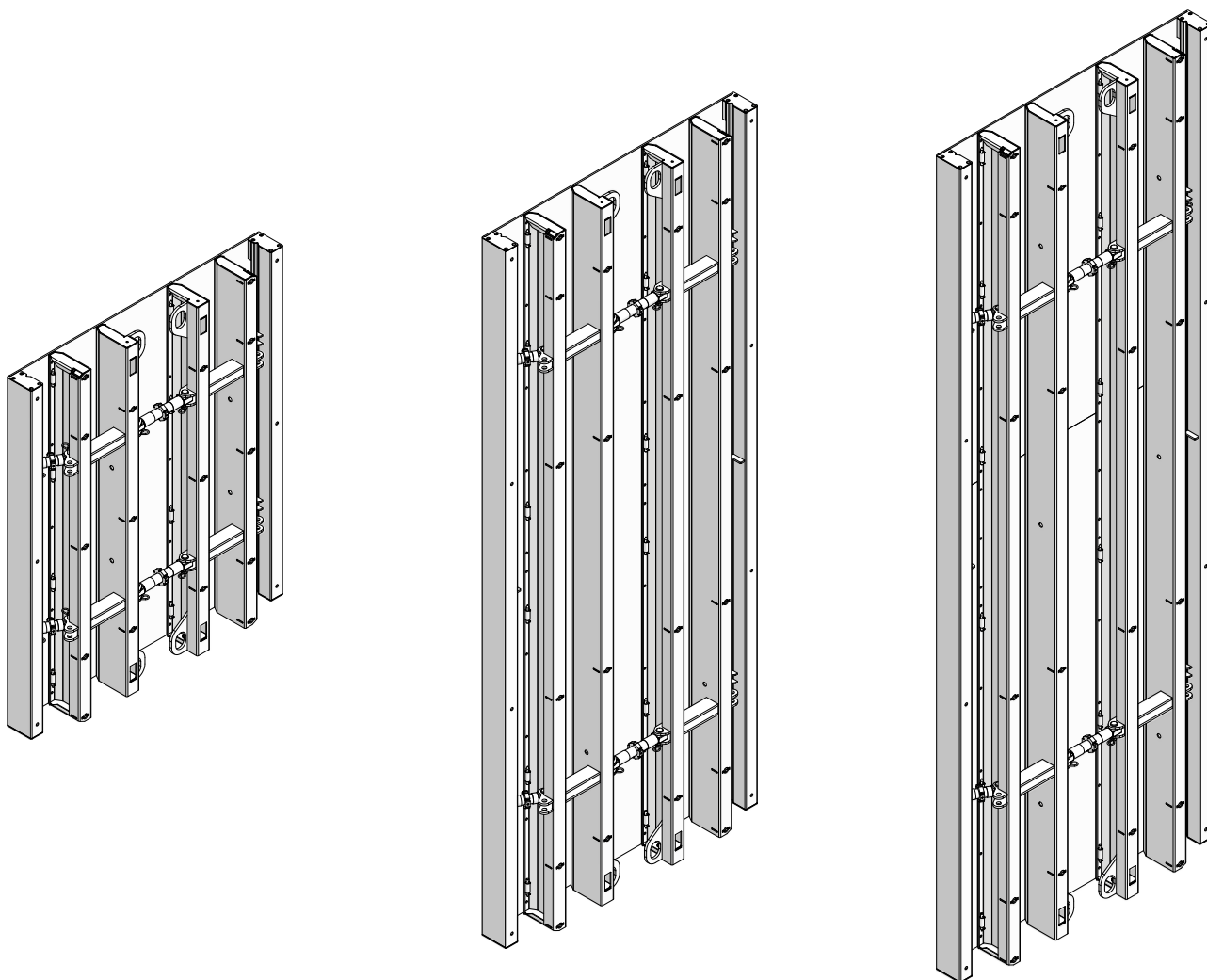

Circular formwork

Radius

Panel height 150 cm

- 2 vertical C-profile pairs
- 5 levels of welded-in DW thread nuts
- 2 levels of spindles
- 1 level of tie points
- 4 crane eyes

M-assembly locks and Uni-assembly locks as well as the continuous groove guarantee for a stepless, tight and aligned panel connection.

The welded-in DW threaded nuts allow for an easy, quick and safe attachment of accessory parts.

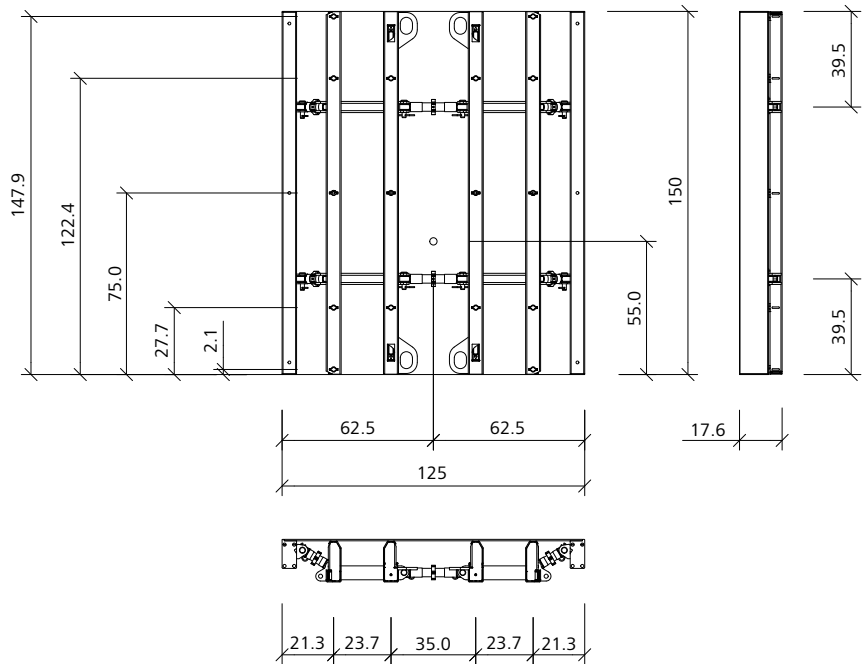
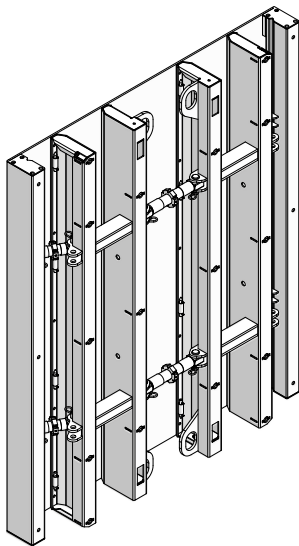

Ref.-No.	Description / Application	m ²	kg	
23-805-80 RS-outside panel	150/125	1.88	198.0

Ref.-No.	Description / Application	m ²	kg	
23-806-80 RS-inside panel	150/120	1.80	193.5

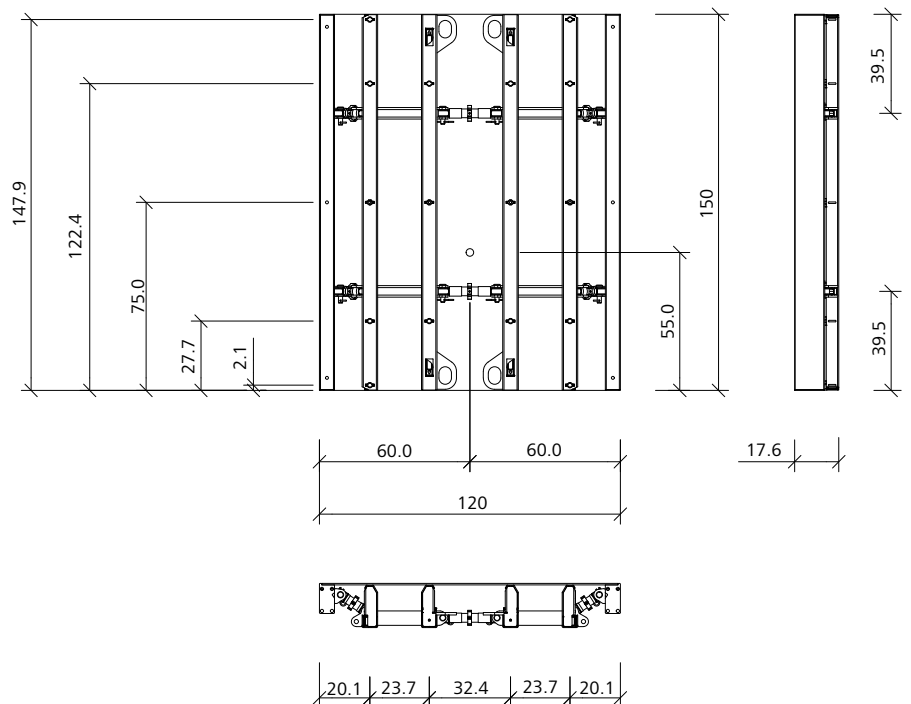
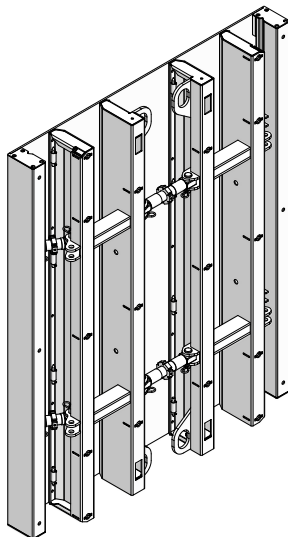

Circular formwork

Radius

Panel height 150 cm

- 4 vertical C-profile pairs
- 5 levels of welded-in DW thread nuts
- 2 levels of spindles
- 1 level of tie points
- 8 crane eyes

M-assembly locks and Uni-assembly locks as well as the continuous groove guarantee for a stepless, tight and aligned panel connection.

The welded-in DW threaded nuts allow for an easy, quick and safe attachment of accessory parts.

Ref.-No.	Description / Application	m ²	kg
23-805-70	RS-outside panel 150/250	3.75	369.5

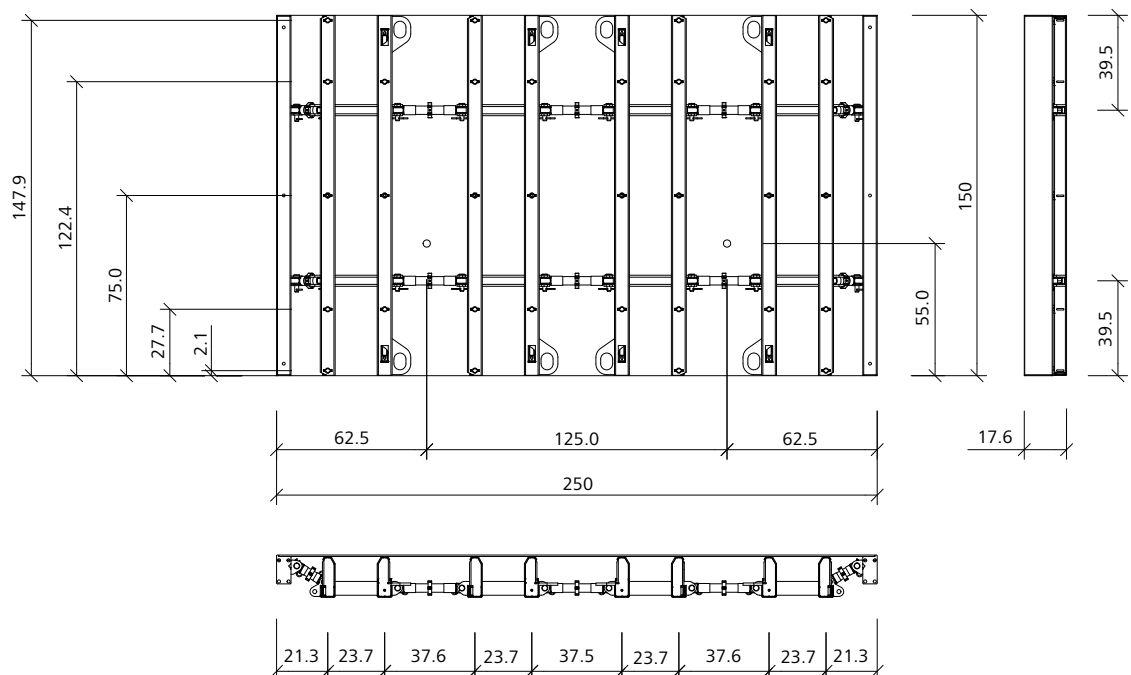
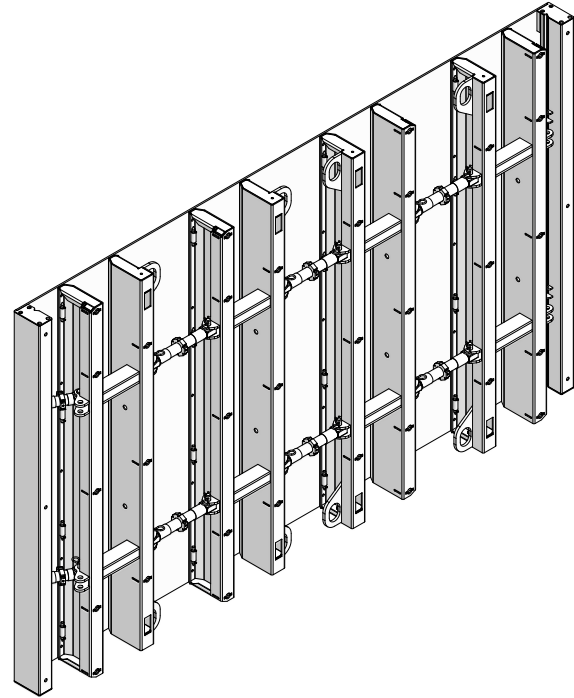

Circular formwork

Radius

Panel height 150 cm

- 4 vertical C-profile pairs
- 5 levels of welded-in DW thread nuts
- 2 levels of spindles
- 1 level of tie points
- 8 crane eyes

M-assembly locks and Uni-assembly locks as well as the continuous groove guarantee for a stepless, tight and aligned panel connection.

The welded-in DW threaded nuts allow for an easy, quick and safe attachment of accessory parts.

Ref.-No.	Description / Application	m ²	kg
23-806-70	RS-inside panel..... 150/240	3.60	361.0

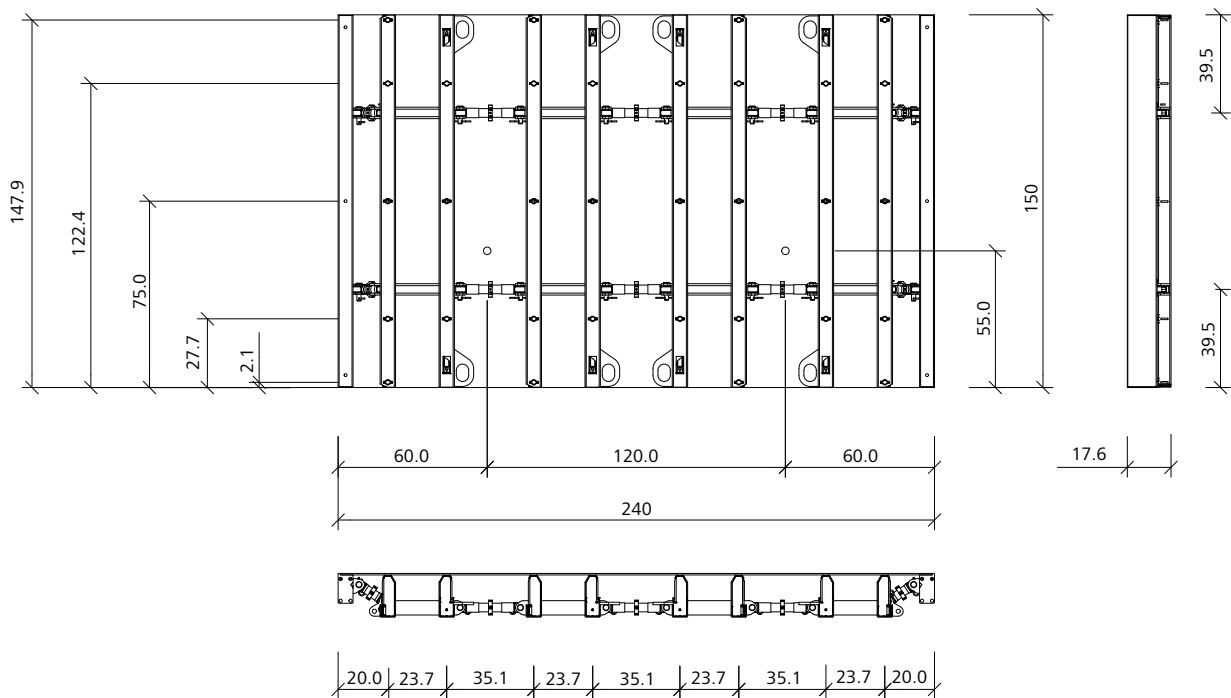
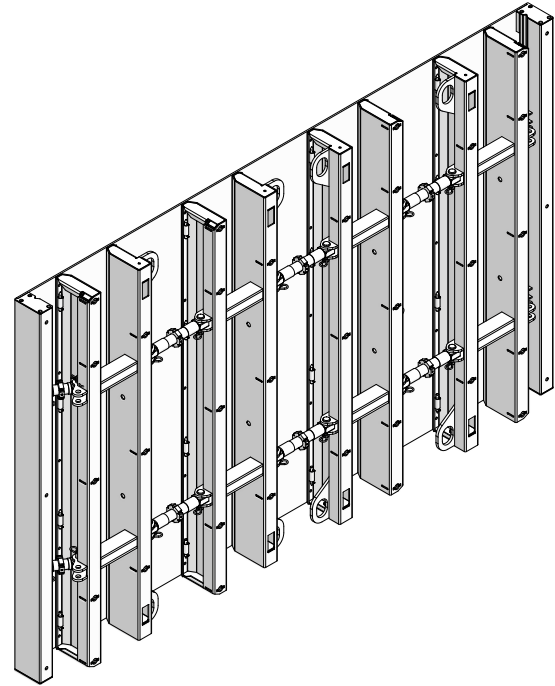

Circular formwork

Radius

Panel height 300 cm

- 2 vertical C-profile pairs
- 6 levels of welded-in DW thread nuts
- 2 levels of spindles
- 2 levels of tie points
- 4 crane eyes

M-assembly locks and Uni-assembly locks as well as the continuous groove guarantee for a stepless, tight and aligned panel connection.

The welded-in DW threaded nuts allow for an easy, quick and safe attachment of accessory parts.

Ref.-No.	Description / Application	m ²	kg
23-805-40	RS-outside panel 300/125	3.75	364.0

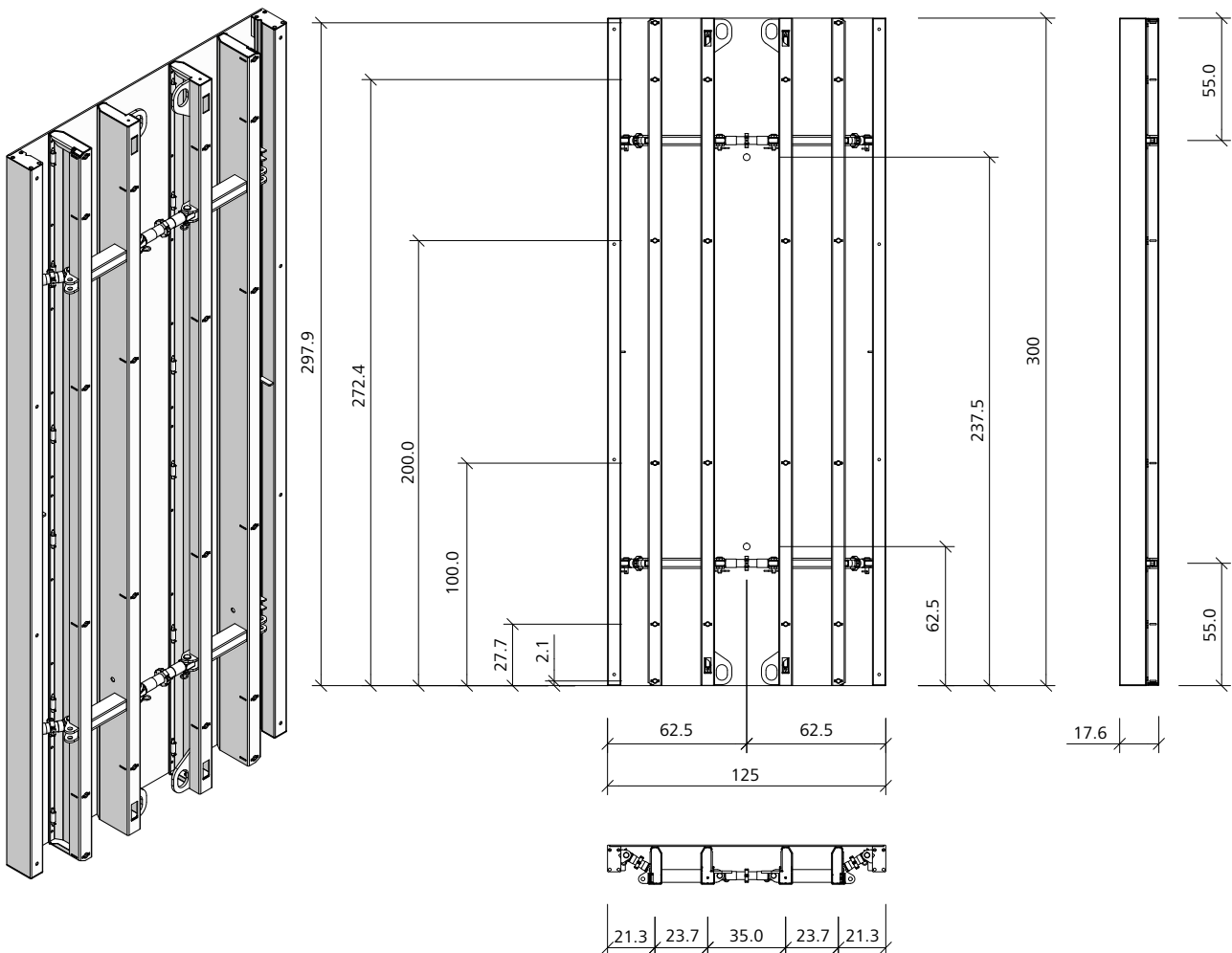

Circular formwork

Radius

Panel height 300 cm

- 2 vertical C-profile pairs
- 6 levels of welded-in DW thread nuts
- 2 levels of spindles
- 2 levels of tie points
- 4 crane eyes

M-assembly locks and Uni-assembly locks as well as the continuous groove guarantee for a stepless, tight and aligned panel connection.

The welded-in DW threaded nuts allow for an easy, quick and safe attachment of accessory parts.

Ref.-No.	Description / Application	m ²	kg
23-806-40	RS-inside panel.....300/120	3.60	356.0

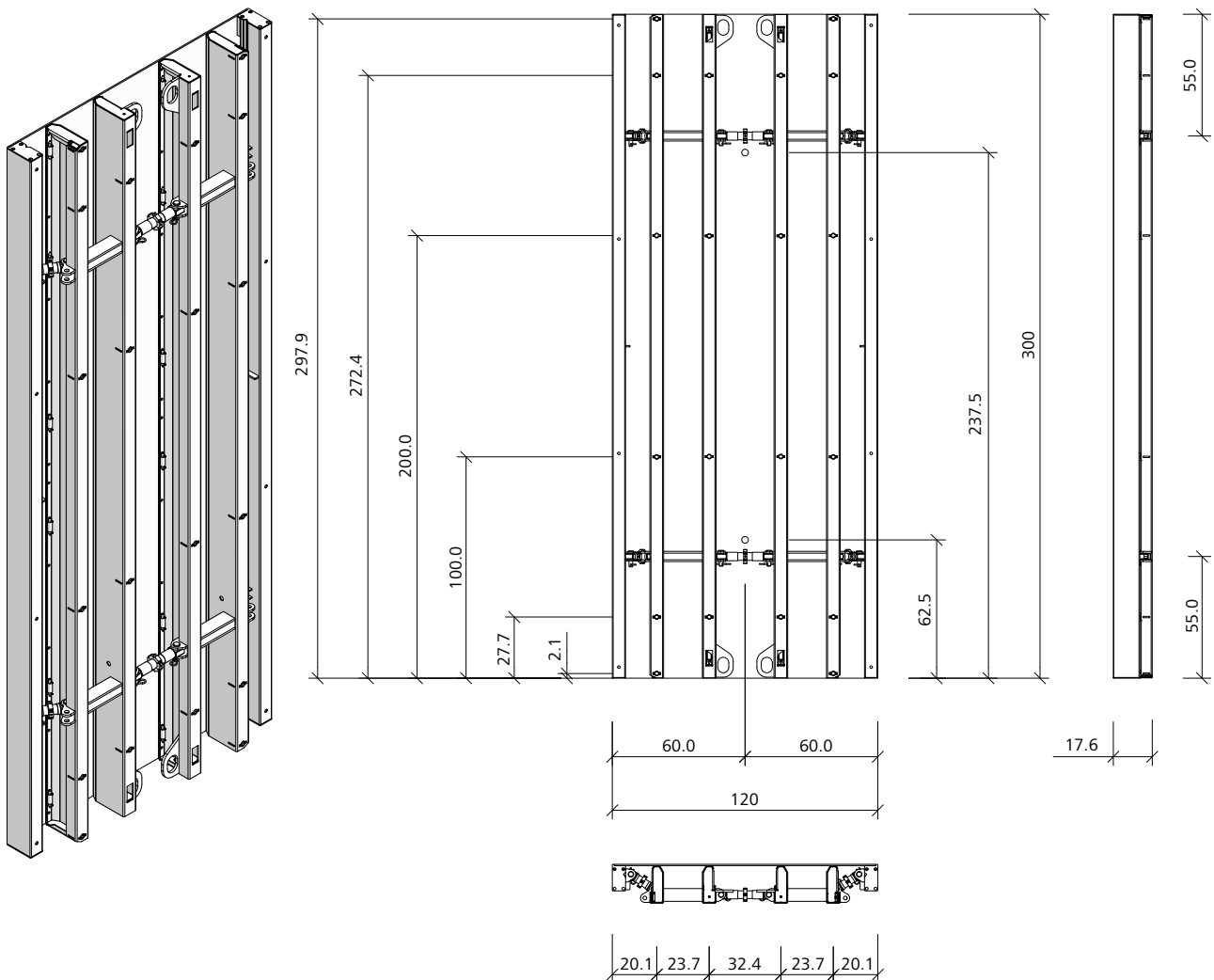

Circular formwork

Radius

Panel height 300 cm

- 4 vertical C-profile pairs
- 6 levels of welded-in DW thread nuts
- 2 levels of spindles
- 2 levels of tie points
- 8 crane eyes

M-assembly locks and Uni-assembly locks as well as the continuous groove guarantee for a stepless, tight and aligned panel connection.

The welded-in DW threaded nuts allow for an easy, quick and safe attachment of accessory parts.

Ref.-No.	Description / Application	m ²	kg
23-805-30	RS-outside panel 300/250	7.50	678.0

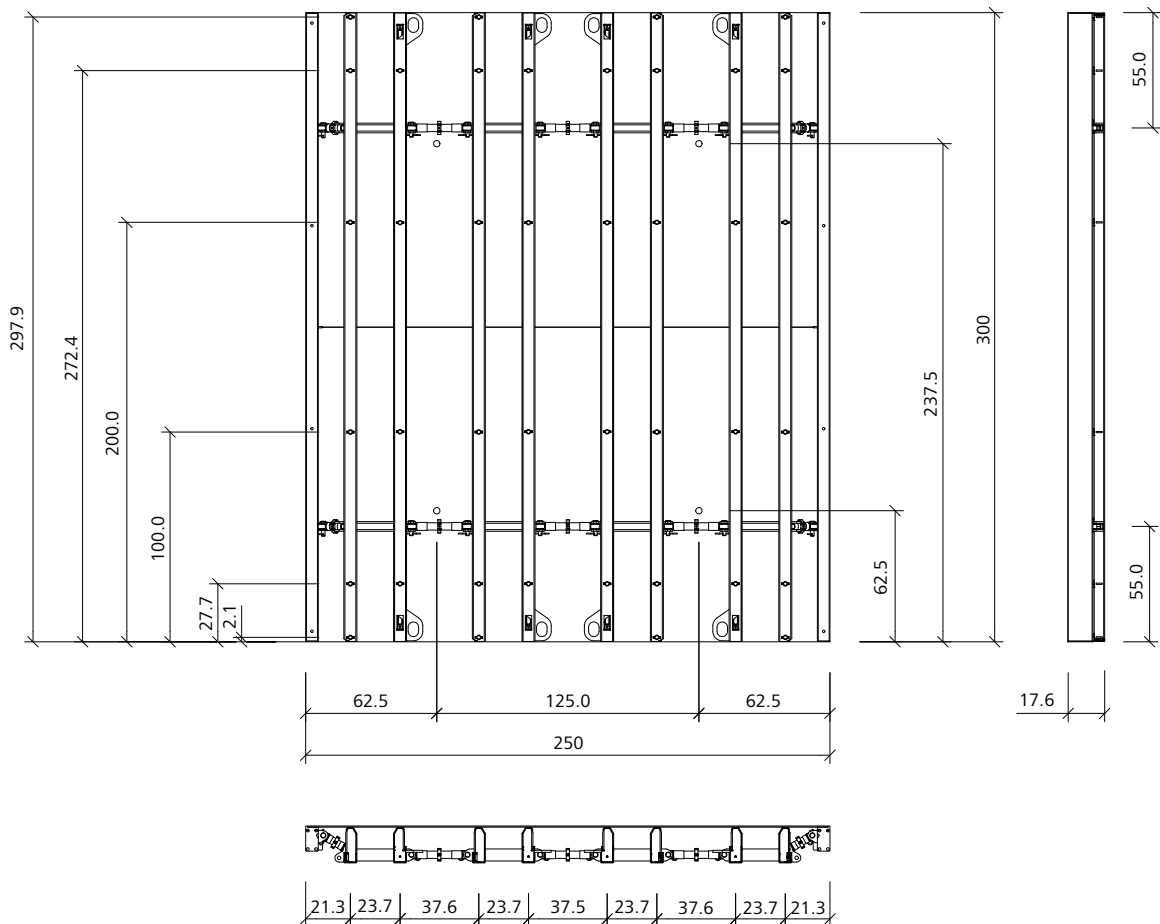
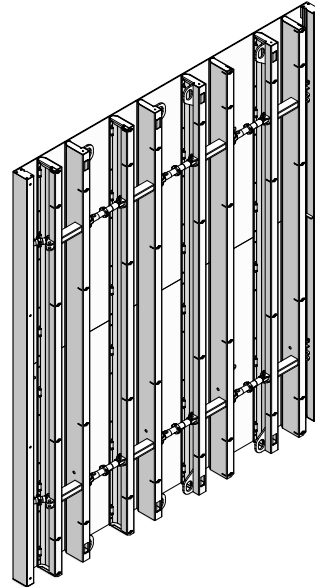

Circular formwork

Panel height 300 cm

- 4 vertical C-profile pairs
- 6 levels of welded-in DW thread nuts
- 2 levels of spindles
- 2 levels of tie points
- 8 crane eyes

M-assembly locks and Uni-assembly locks as well as the continuous groove guarantee for a stepless, tight and aligned panel connection.

The welded-in DW threaded nuts allow for an easy, quick and safe attachment of accessory parts.

Ref.-No.	Description / Application	m ²	kg
23-806-30	RS-inside panel.....300/240	7.20	662.5

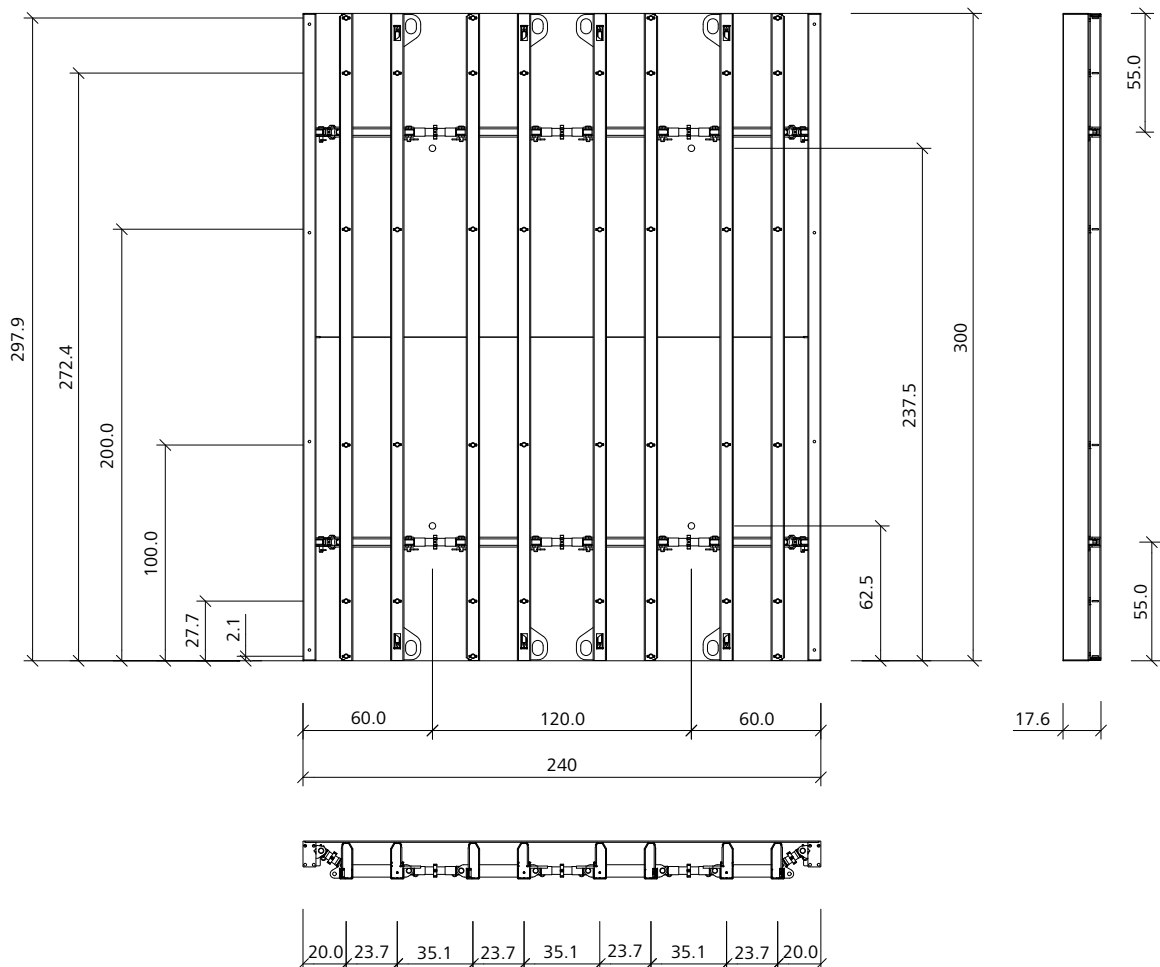
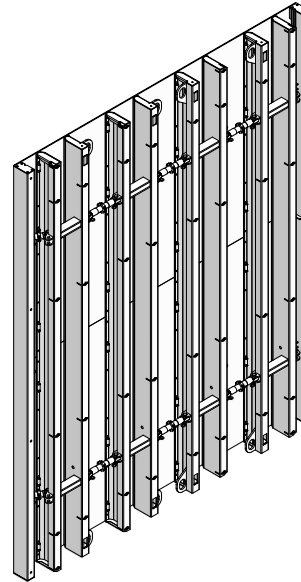

Circular formwork

Radius

Panel height 350 cm

- 2 vertical C-profile pairs
- 5 levels of welded-in DW thread nuts
- 2 levels of spindles
- 3 levels of tie points
- 4 crane eyes

M-assembly locks and Uni-assembly locks as well as the continuous groove guarantee for a stepless, tight and aligned panel connection.

The welded-in DW threaded nuts allow for an easy, quick and safe attachment of accessory parts.

Ref.-No.	Description / Application	m ²	kg
23-805-20	RS-outside panel 350/125	4.38	419.0

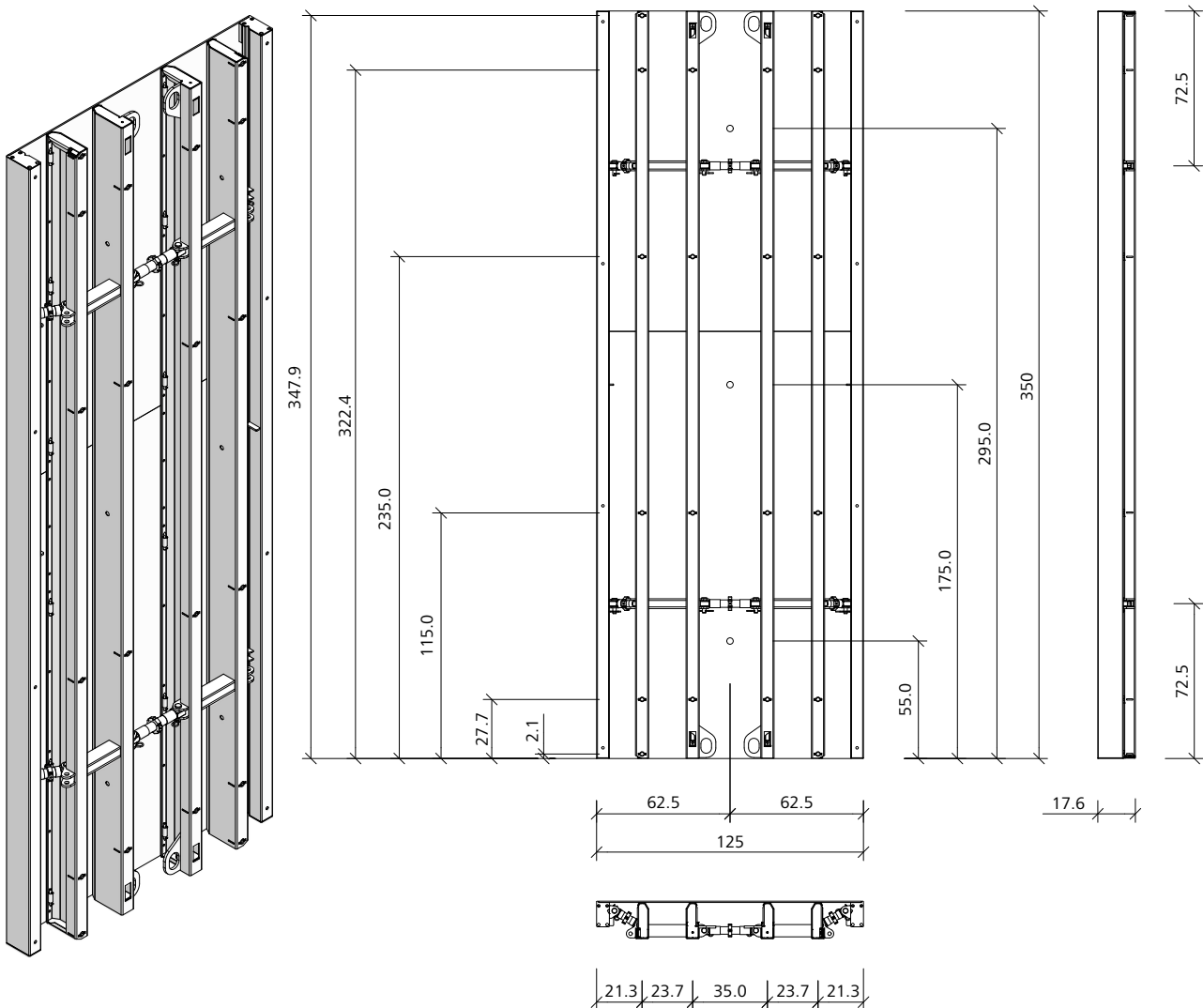

Circular formwork

Radius

Panel height 350 cm

- 2 vertical C-profile pairs
- 5 levels of welded-in DW thread nuts
- 2 levels of spindles
- 3 levels of tie points
- 4 crane eyes

M-assembly locks and Uni-assembly locks as well as the continuous groove guarantee for a stepless, tight and aligned panel connection.

The welded-in DW threaded nuts allow for an easy, quick and safe attachment of accessory parts.

Ref.-No.	Description / Application	m ²	kg
23-806-20	RS-inside panel.....350/120	4.20	409.5

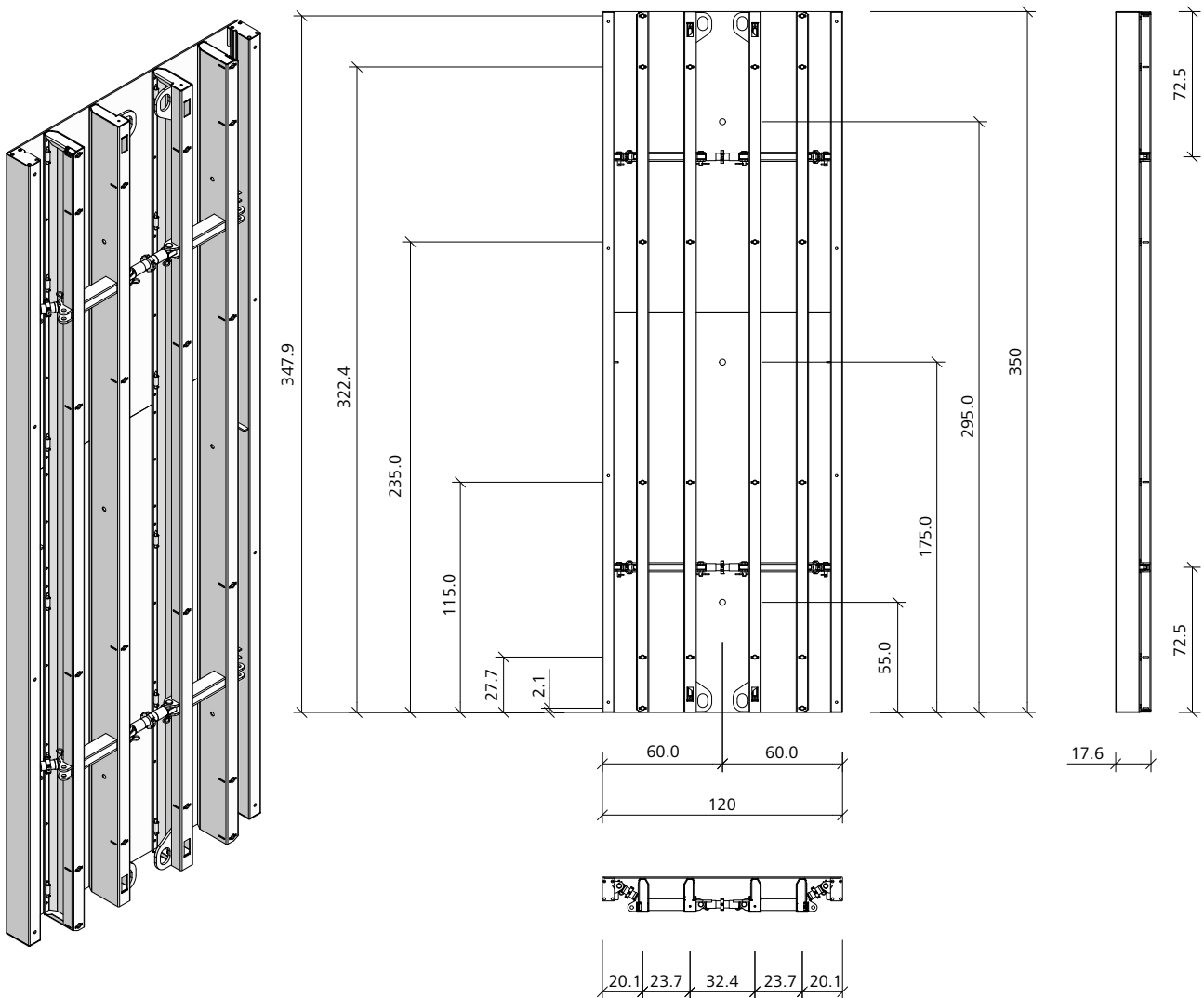

Circular formwork

Radius

Panel height 350 cm

- 4 vertical C-profile pairs
 - 5 levels of welded-in DW thread nuts
 - 2 levels of spindles
 - 3 level of tie points
 - 8 crane eyes
- M-assembly locks and Uni-assembly locks as well as the continuous groove guarantee for a stepless, tight and aligned panel connection.
- The welded-in DW threaded nuts allow for an easy, quick and safe attachment of accessory parts.

Ref.-No.	Description / Application	m ²	kg
23-805-05	RS-outside panel 350/250	8.75	780.0

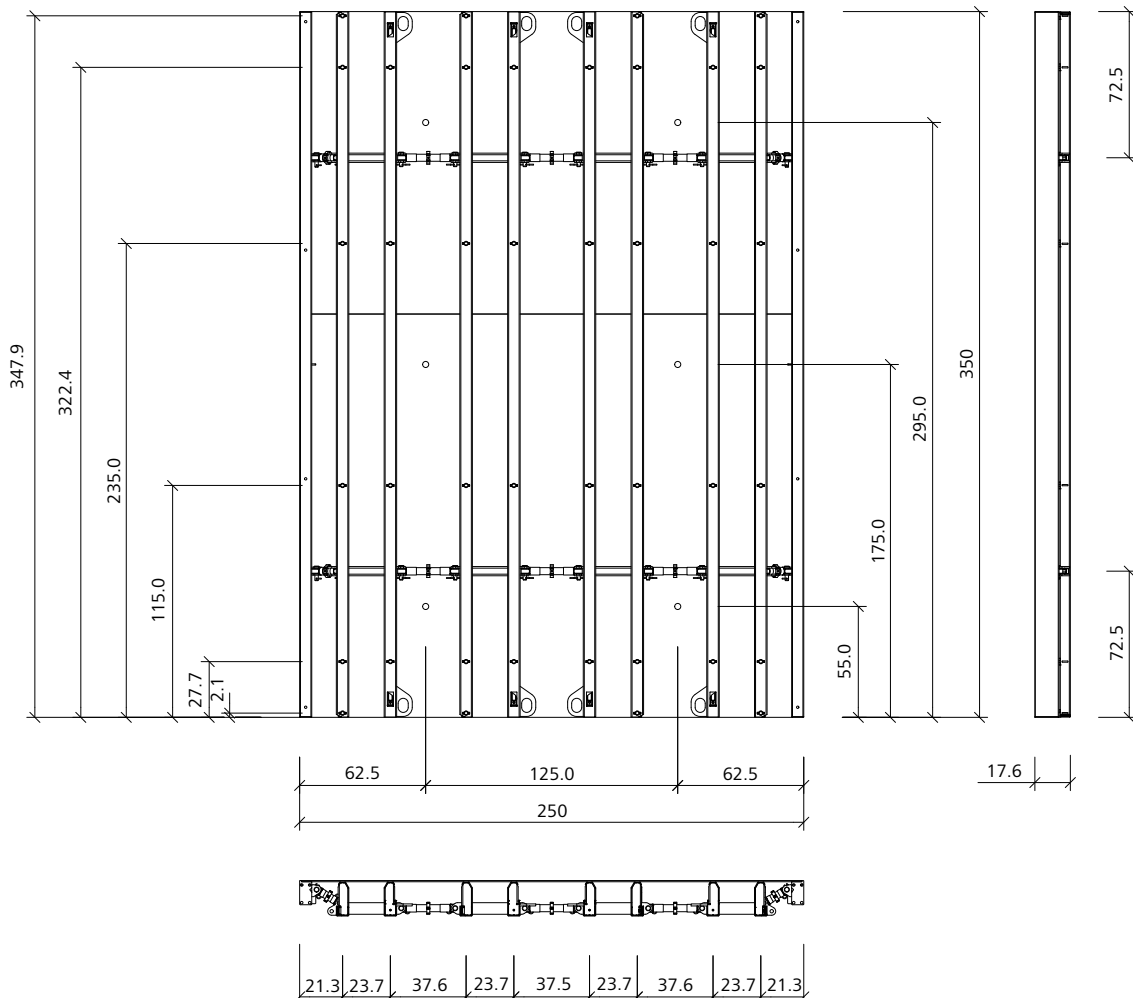
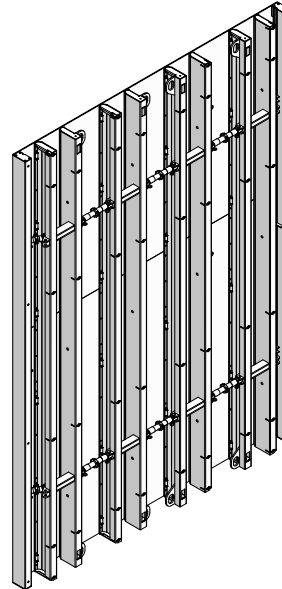

Circular formwork

Panel height 350 cm

- 4 vertical C-profile pairs
- 5 levels of welded-in DW thread nuts
- 2 levels of spindles
- 3 level of tie points
- 8 crane eyes

M-assembly locks and Uni-assembly locks as well as the continuous groove guarantee for a stepless, tight and aligned panel connection.

The welded-in DW threaded nuts allow for an easy, quick and safe attachment of accessory parts.

Ref.-No.	Description / Application	m ²	kg
23-806-05	RS-inside panel.....350/240	8.40	761.0

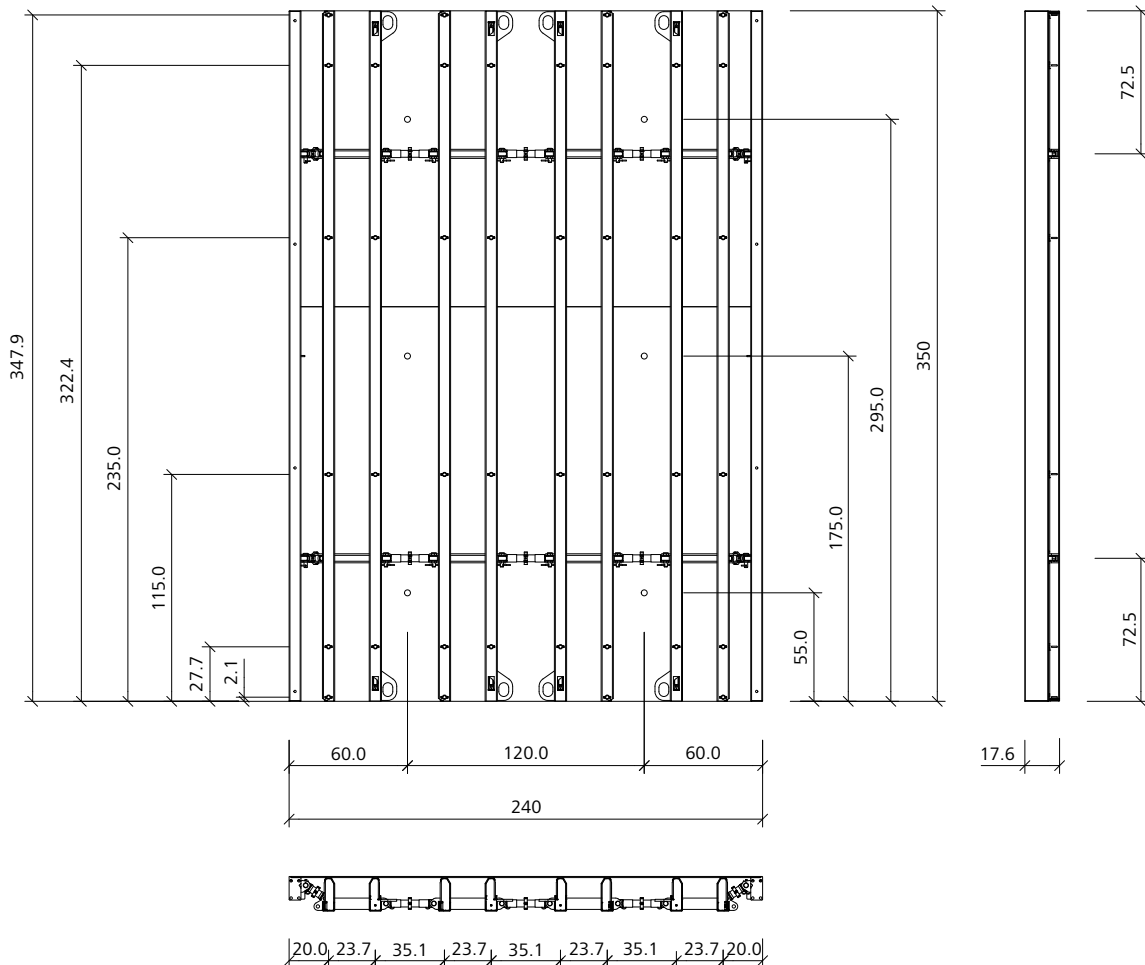
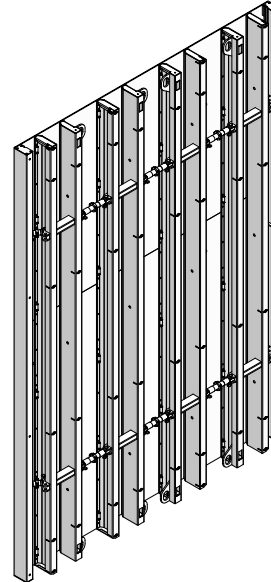

Circular formwork

Radius

RS-assembly lock

Galvanized, to tightly connect and align Radius panels. Clamping length is 119 to 205 mm for stepless compensation. 2 assembly locks are required per panel joint for a panel height up to 300 cm; 3 assembly locks are required per panel joint for a panel height up to 350 cm.

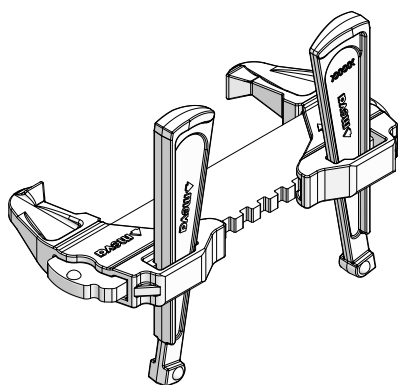

Ref.-No.	Description / Application	m ²	kg
23-807-70 RS-assembly lock		4.7

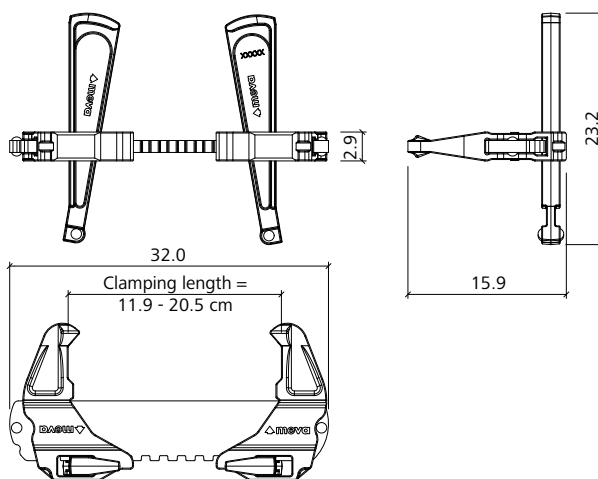

M-assembly lock

Galvanized, to tightly connect and align Radius panels. Clamping length 12 cm. 2 assembly locks are required per panel joint for a panel height up to 300 cm; 3 assembly locks are required per panel joint for a panel height up to 350 cm.

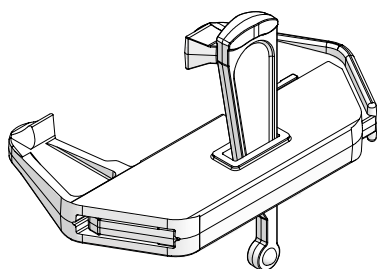

Ref.-No.	Description / Application	m ²	kg
29-400-71 M-assembly lock		3.0

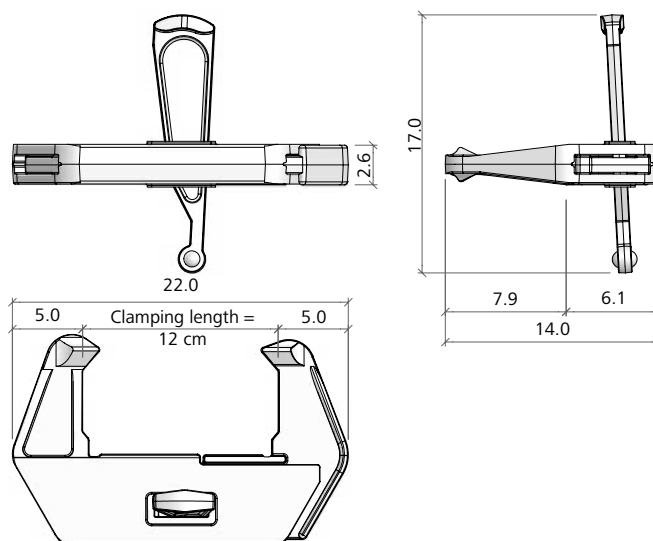

Circular formwork

Radius

Combi-lock with coupling

Galvanized. Is used to attach the push-pull props at the panel joint of the wall formwork profile widths of 40 and 60 mm. Clamping length 8, 10 and 12 cm.

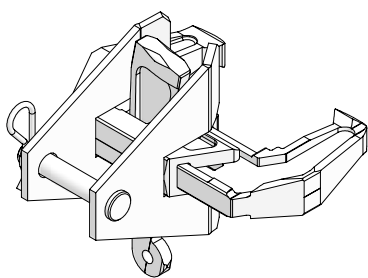

Ref.-No.	Description / Application	m ²	kg
29-804-60 Combi-lock with coupling		3.7

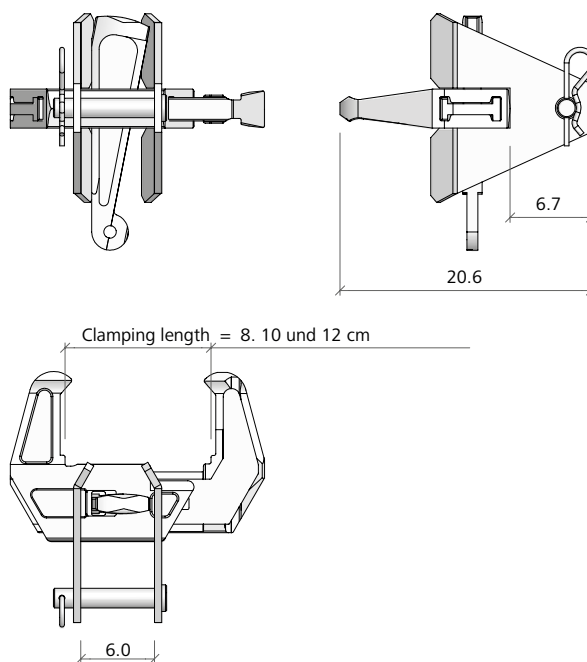

Uni-assembly lock

Galvanized. For stepless compensation. Clamping length 22 or 28 cm.

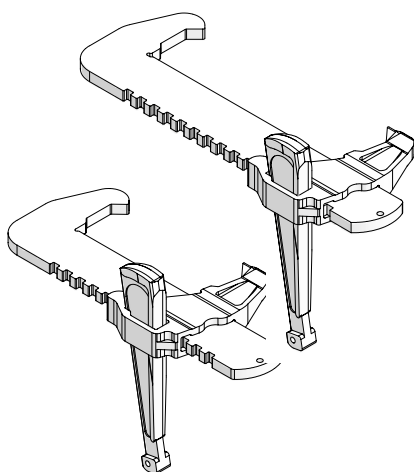

Ref.-No.	Description / Application	m ²	kg
29-400-85 Uni-assembly lock 22		3.6
29-400-90 Uni-assembly lock 28		3.9

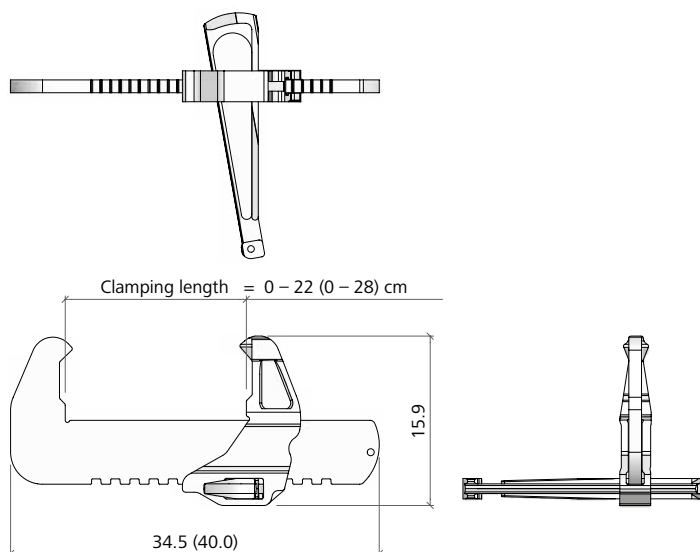

Circular formwork

Radius

Flange screw

Galvanized. DW thread \varnothing 15 mm. Is used to attach accessories, e.g. alignment rails, brace frames, push-pull props, etc. Length of thread 18 cm.

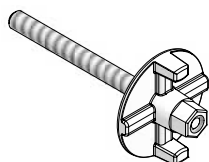

Ref.-No.	Description / Application	m ²	kg
29-401-10	Flange screw 18		1.1

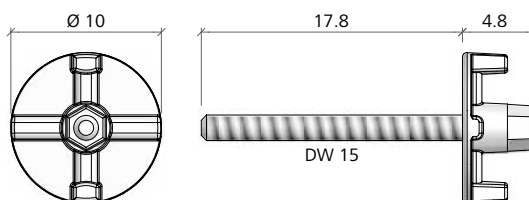

Anchor rail RS

The rail serves to tie the Radius formwork. Together with the shoe the rail is the support for the tying. The rail can be moved sideways on the shoes. The rail transfers the concrete load equally into the panel profiles.

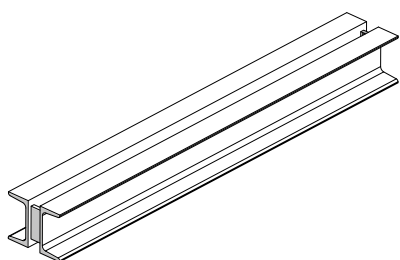

Ref.-No.	Description / Application	m ²	kg
23-807-30	Anchor rail RS		20.5

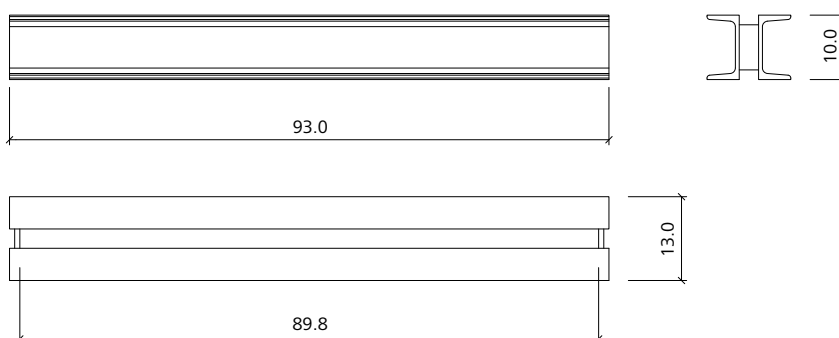

Shoe for anchor rail RS

Galvanized. The shoe serves to hold the anchor rail and is plugged into two openings of the panel frame by using two pins which have to be pushed together. The pins stay in place due to a spring. They need to be pushed together until they snap into the openings.

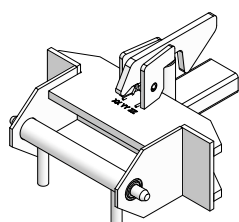

Ref.-No.	Description / Application	m ²	kg
23-807-25	Shoe for anchor rail RS		5.8

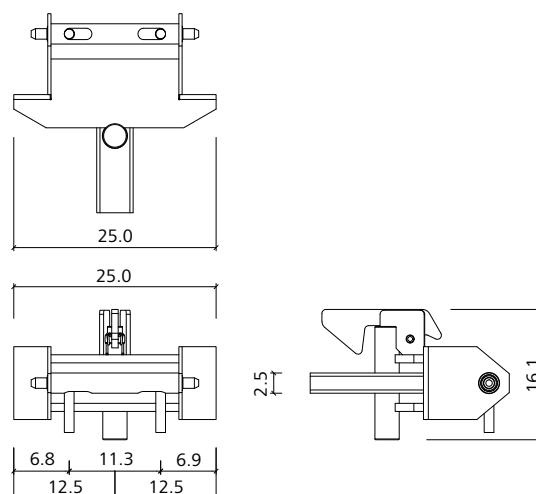

Circular formwork

Radius

Top tie claw RS

Galvanized. Is pressure-resistant and guarantees tensile strength. Is used to tie above the panels and suspended over the panels between their double profiles. Adjustment range: 150-500 mm.

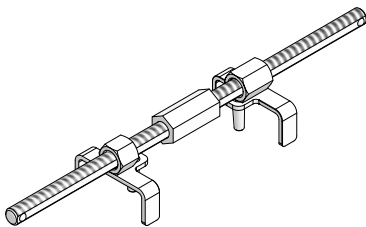

Ref.-No.	Description / Application	m ²	kg
23-807-50 Top tie claw RS.....		3.1

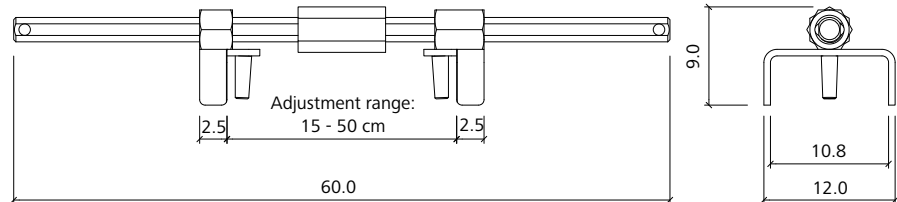

Alignment rail RS

Galvanized. The alignment rail RS is only used when Radius panels are extended with each other. The amount of rails needed, is given by the openings in the steel profiles of the panels (4 at panel width 240 and 250; 2 at panel width 125 and 120). The claw of the integrated assembly locks reaches into the openings of the frame profile and connects the panels. Additionally a flange screw 18 is used on each side of the joint to support the alignment.

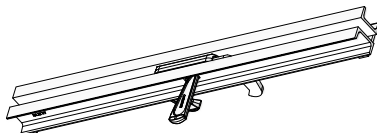

Ref.-No.	Description / Application	m ²	kg
23-807-15 Alignment rail RS.....		12.2

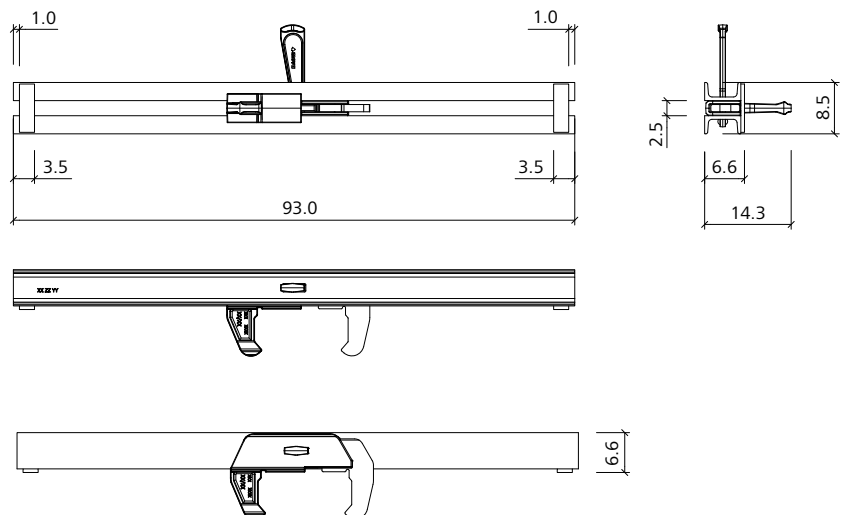

Additional spindle 270-390 RS

With a radius greater than 5 m a additional spindle RS 270 - 390 RS is required at the panel joint. The additional spindle is attached at the standard spindle elevation at the plate of the last spindle of the panel with a bolt and a cotter pin.

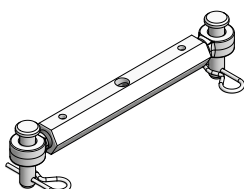

Ref.-No.	Description / Application	m ²	kg
23-807-60 Additional spindle 270-390 RS		1.8

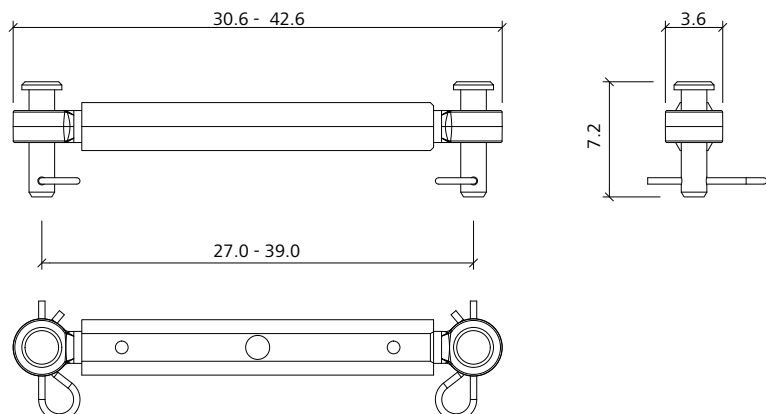

Circular formwork

Radius

Foot spindle RS

Is attached to a DW threaded nut of the panel frame by using a flange screw 18. It serves to adjust the Radius panels in height.

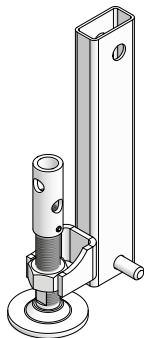

Ref.-No.	Description / Application	m ²	kg
23-807-35 Foot spindle RS		2.5

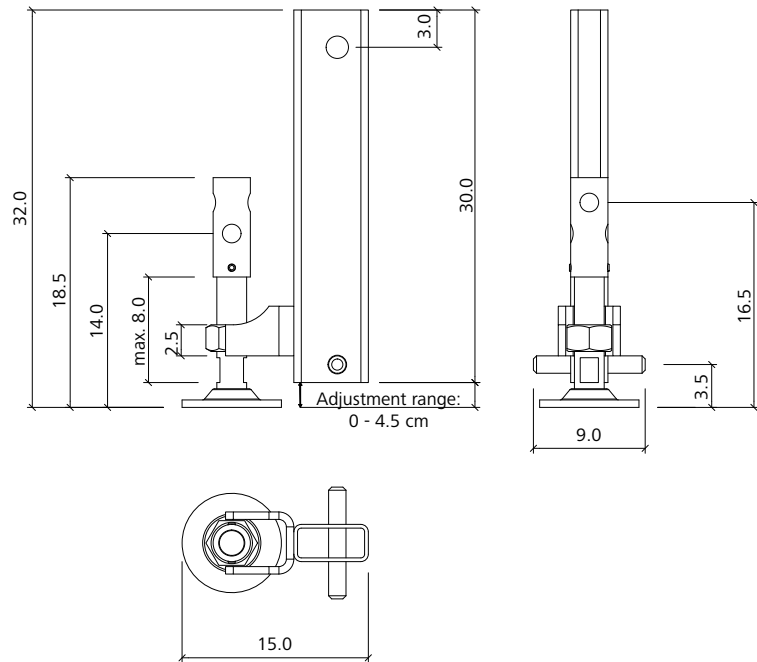

Ratchet removable RS

The detachable ratchet is used in combination with the spindles of the Radius panels to adjust the different radii. The ratchet fits all spindles of the Radius panels.

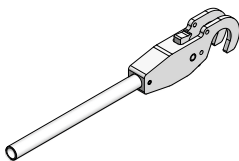

Ref.-No.	Description / Application	m ²	kg
23-807-40 Ratchet removable		1.5

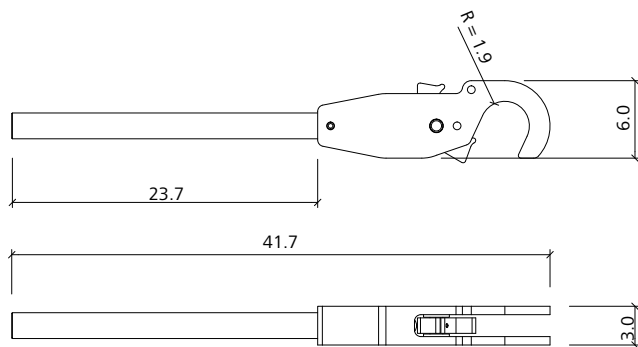

Stop-end claw RS

Galvanized. To form stop-ends of pouring cycles together with tie rods, stop-end fixtures, alignment rails and flange nuts/articulated flange nuts.

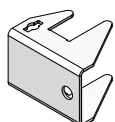

Ref.-No.	Description / Application	m ²	kg
23-807-10 Stop end clamp RS		3.1

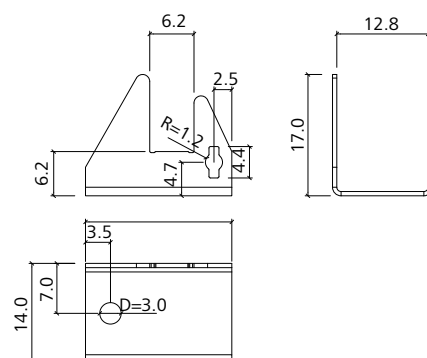

Circular formwork

Radius

Stop-end fixture RS

The stop-end fixture RS is used to form a stop end. It is either attached to the openings of the edge profile of the Radius panel or inserted into the stop-end claw.

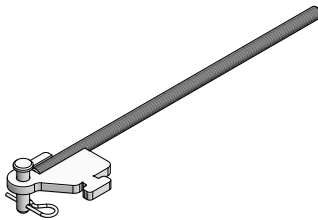

Ref.-No.	Description / Application	m ²	kg
23-807-55 Stop end fixture RS.....		1.7

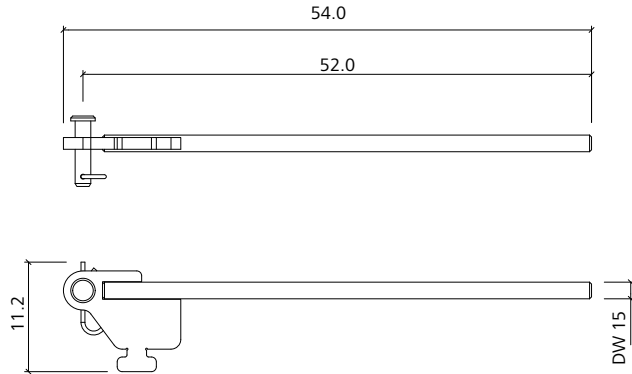

Alignment rails

Galvanized, for stop ends in combination with the stop-end fixtures RS.

Ref.-No.	Description / Application	m ²	kg
29-400-92 M-alignment rail 180, galv.....		24.8
29-201-75 AS-alignment rail 125, galv.....		10.5

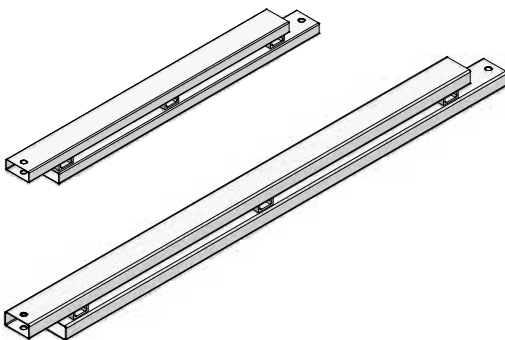
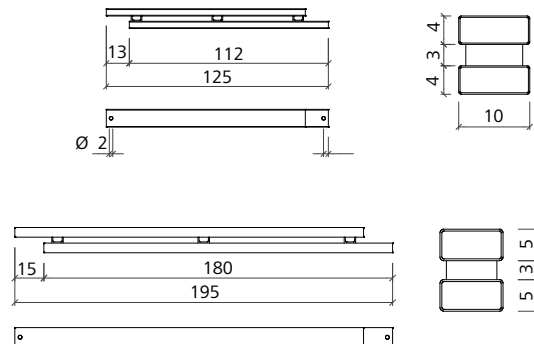

Static values of alignment rails

Description	A [cm ²]	W [cm ³]	I [cm ⁴]	E*I [kNm ²]
QR 44	18	45	224	470
MRS 180	18	45	224	470
ASR 125	12	27	136	286

A = area
 W = modulus of resistance
 I = moment of inertia
 E = modulus of elasticity

Circular formwork

Radius

Magnet RS 360 x 60 mm

Not shown. The magnets are used to position the boxouts and are designed in a way that the boxouts can be firmly attached to them. Note that magnets only position the boxouts and make sure the boxouts are so stable that they withstand the fresh concrete pressure without deforming or moving along the facing.

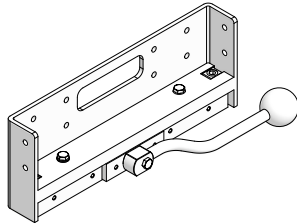

Ref.-No.	Description / Application	m ²	kg
23-807-65	Magnet RS 360 x 360		5.4

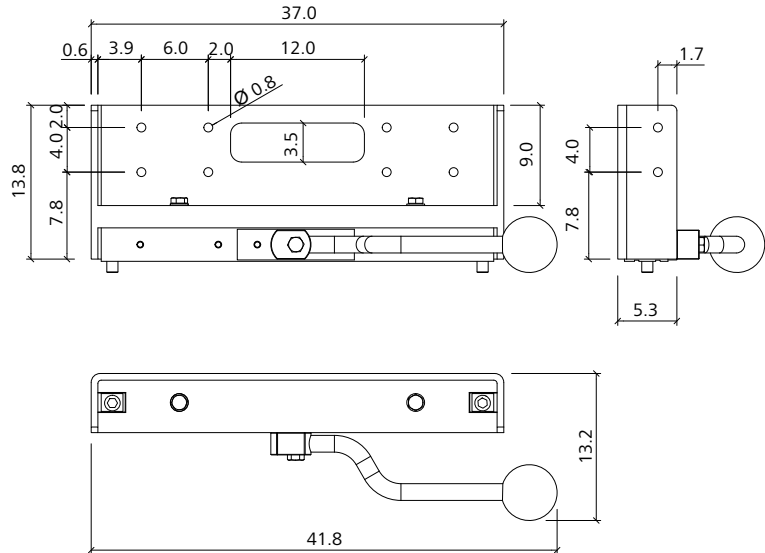

Magnet RS d = 60/80

Used to position small box-outs or electrical sockets. Several magnets are used for box-outs up to 40 cm. The full clamping force is only transmitted when pressed against the facing.

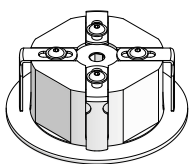

Ref.-No.	Description / Application	m ²	kg
23-807-67	Magnet RS d=60/80		1.0

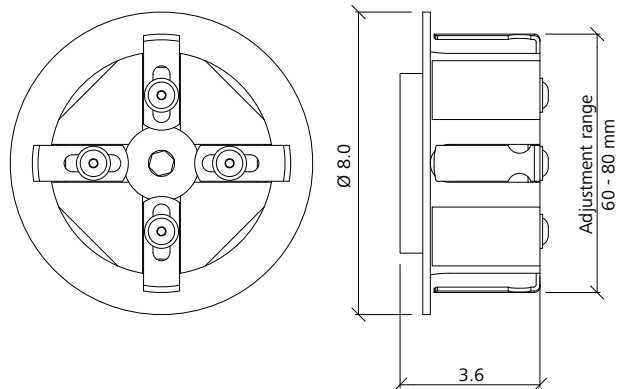

Chamfer strip magnet RS

Is used on steel facing, e.g. on the facing of the Radius circular system.

Ref.-No.	Description / Application	m ²	kg
29-903-00	Chamfer strip magnet RS 15/15 L=1.00 m		0.9
29-903-02	Chamfer strip magnet RS 15/15 L=2.00 m		2.2
29-903-05	Chamfer strip magnet RS 20/20 L=1.00 m		1.6
29-903-07	Chamfer strip magnet RS 20/20 L=2.00 m		3.2

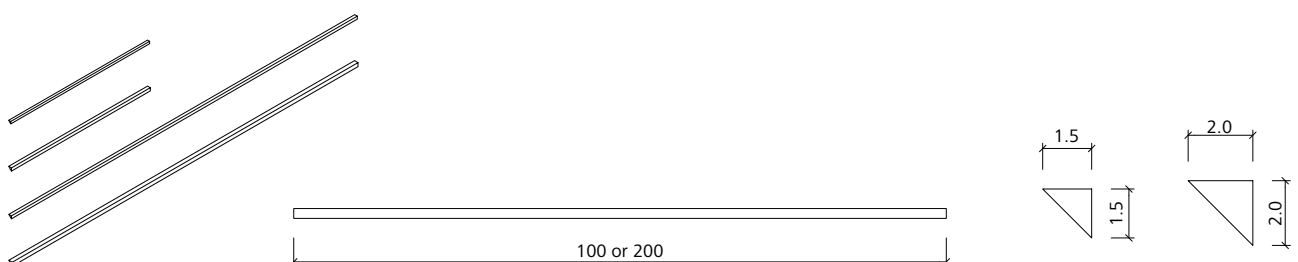

Circular formwork

Radius

Tie rod DW 20/120

Uncoated, with DW-thread $\varnothing 20$, DIN 18216, not weldable, to tie panels of a double sided formwork; admissible load capacity 160 kN.

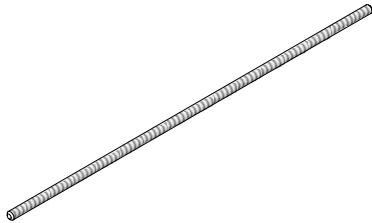

Ref.-No.	Description / Application	m ²	kg
29-900-97	Tie rod DW 20/120		3.0

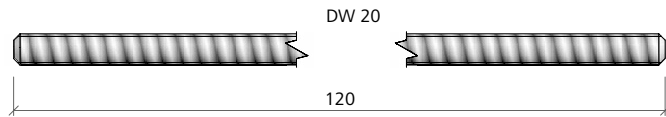

Articulated flange nut 20/140

Forged, galvanized. DIN 18216. DW thread $\varnothing 20$ mm, plate $\varnothing 140$ mm, max. inclination 10° , SW 36 mm. Max. load capacity 160 kN. Reduces wear of panel coating.

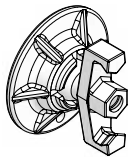

Ref.-No.	Description / Application	m ²	kg
29-900-05	Articulated flange nut 20/140		2.4

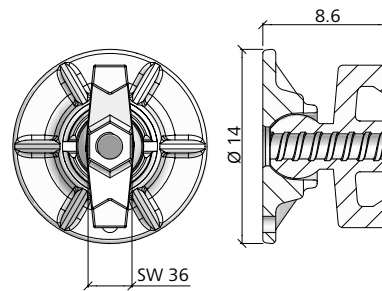

Spanner SW 36

Inset yellow chromated; spanner width 36 mm. To tighten and loosen articulated flange nuts 20/140.

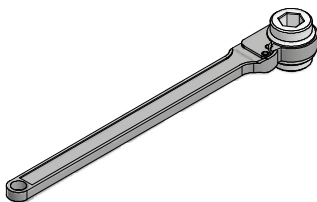

Ref.-No.	Description / Application	m ²	kg
29-800-15	Spanner SW 36		3.3

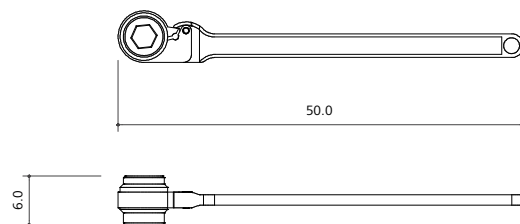

Water stop 20

Uncoated, lost part; is used with tie rods DW 20 to produce watertight tie points. Max load capacity: 160 kN.

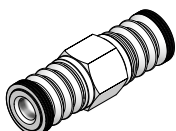

Ref.-No.	Description / Application	m ²	kg
29-903-30	Water stop DW 20		1.4

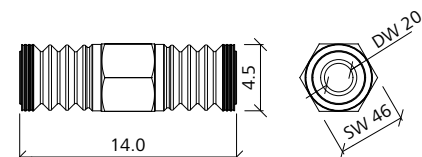

Circular formwork

Radius

Brace frame 250

Galvanized. Available with formwork-prop connector. Is used to align and brace the formwork. Consists of a push-pull prop R 250 (190–320 cm), a brace SRL 120 (90–150 cm) and a double-jointed footplate. The formwork-prop connectors are attached to the formwork with flange screws 18.

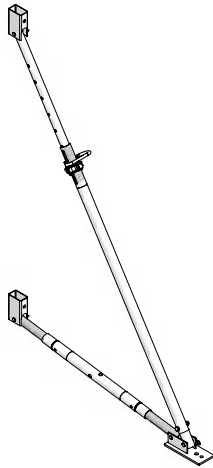

Ref.-No.	Description / Application	m ²	kg
29-109-20	Brace frame 250 with formwork-prop connector	31.5	

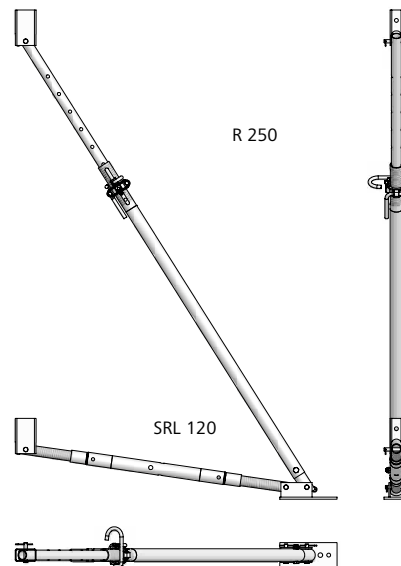

Formwork-prop connector

Galvanized; to connect braces, brace frames and push-pull props (maximum Ø 48 mm) to the DW threaded nuts of the Radius profile by means of a flange screw 18. Delivery includes head bolt 16/90 and cotter pin 4.

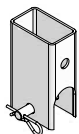

Ref.-No.	Description / Application	m ²	kg
29-804-85	Formwork-prop connector	1.7	

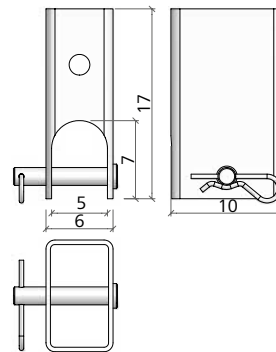

Double-jointed foot plate

Galvanized. Delivery includes head bolt 16/90 and cotter pin 4. Serves as foot plate for brace frames 250 and as connector for braces and push-pull props up to Ø 57 mm.

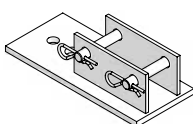

Ref.-No.	Description / Application	m ²	kg
29-402-32	Double-jointed foot plate (RS Ø to 57 mm)	4.0	

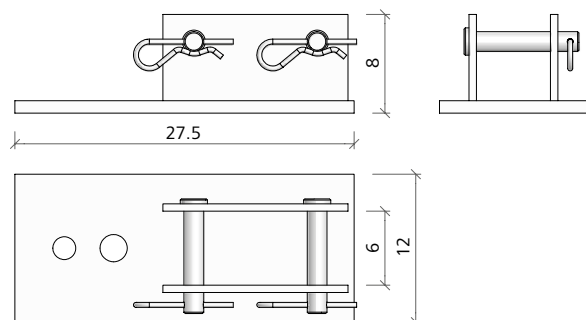

Circular formwork

Radius

Walkway bracket RS

Galvanized, pluggable, is used as working and safety scaffold. On the top end the bracket is attached to a DW threaded nut of the frame profile. At the bottom it is secured with the clamps. The planking can be mounted to the brackets. The working width is approx. 90cm. In addition to the bracket a guardrailing post is required.

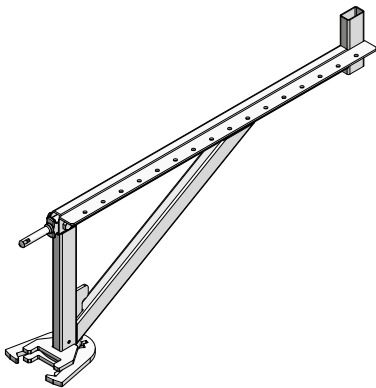

Ref.-No.	Description / Application	m ²	kg
23-807-20 Walkway bracket RS.....		6.7

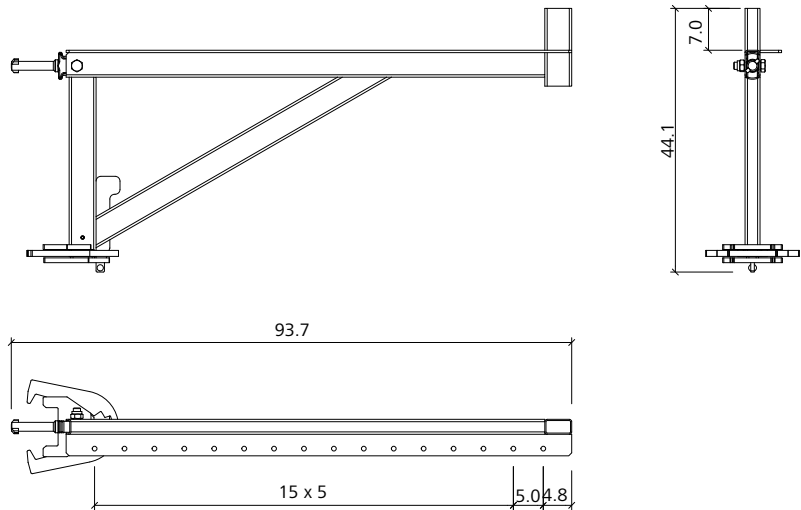

Guardrailing post

Galvanized. Is plugged into the walkway bracket.

Ref.-No.	Description / Application	m ²	kg
29-106-75 Guardrailing post 100.....		3.7
29-106-85 Guardrailing post 140.....		4.7

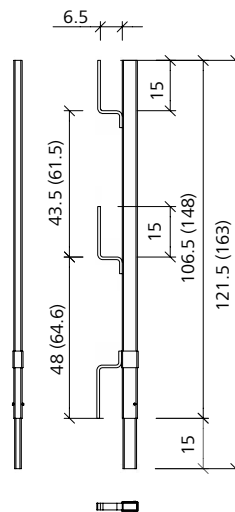
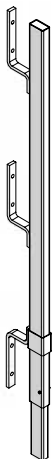

The numbers in parentheses refer to the Guardrailing post 140

Guardrailing post 48

Galvanized. With manifold to attach it to the walkway bracket and with tube \varnothing 48 mm to attach tube couplers.

Ref.-No.	Description / Application	m ²	kg
29-106-80	Guardrailing post 48/120 (UK)		5.5

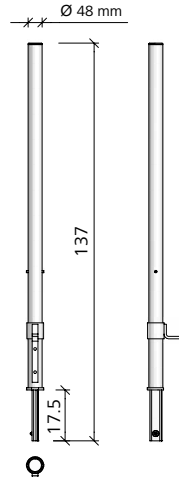

Notes

Grid of dots for notes



MEVA Schalungs-Systeme GmbH

Industriestrasse 5 Tel. +49 7456 692-01
72221 Haiterbach Fax +49 7456 692-66
Germany info@meva.net

www.meva.net