

Product list

Please note

This product list includes all parts necessary for most applications.
For parts required for special applications, please refer to the MEVA price list. Dimensions are in centimetres (cm) unless another measure is shown.

Contents

Adjustable spanner	36	Foundation tape	42	Quick anchor	36
Anchor loop	34	Guardrailing post	62	Quick-anchor fixture	37
Anchor plate	38	Guardrailing post 48	62	Quick-release belt fastener	61
Anchor sleeve	31	Hard-metal plates	64	Railing clamp	61
Anchor support DW 15 - DW 26.5	33	Head bolt 16/90	57	Rigid coupler 48/48	53
Articulated flange nut	39	Hexagonal nut	40	Safety clamp H20	28
Beam clamp H20	25	Holding plate	61	Safety mesh ... /2490	60
Beam clamp H20/H20	27	Joint coupler 48/48 (SW 22)	54	Scaffold tube	53
Bolt-on coupler 48/M14	54	MAB MEVA working platform	55	Shuttering panel 3S	24
Brace bracket 50 MFS	44	Magnet RS d = 60/80	43	Side protection net 200/1000	61
Brace bracket 80	45	MEVA alu-beam 20	26	Single anchor DW	33
Brace SRL	56	MEVA packing crate	66	Spacer	42
Chamfer strip magnet RS	43	MevaTrenn classic	65	Spanner	39
Clamp for Guardrailing post	63	MevaTrenn eco	65	Spare ledge	64
Concrete and rock anchor DW 15	41	MevaTrenn pro	65	Spiral anchor DW 15/100	36
Concrete scraper	64	MTT access hatch 257	51	Spiral spring	37
Concrete scraper – alku	64	MTT base collar	49	Sprayer	66
Concrete scraper – frame	64	MTT base spindle 60	49	Stacking rack	67
Cone for plastic tube	41	MTT base standard 221	47	Stainless steel jet	66
Connector Clip H20	26	MTT diagonal brace	48	Stop-end bracket MFS	45
Cotter pin 4	57	MTT hinged pin, D=12	50	Stop-end rail MFS	46
Counter plate	42	MTT internal stair rail	51	Stop-end spindle MFS	46
Coupling nut	40	MTT ledger	48	Storage box 120/100	66
Cross-bracing clamp	27	MTT ledger 190 wedge head	48	Swivel-joint coupler 48/48	53
Divinol Wax	65	MTT spigot	50	Swivel-joint coupler 48/63	53
Door spindle MFS	43	MTT spindle attachment with wedge head	49	Tap for can	66
Double anchor DW	34	MTT spindle holder	49	Tension belt	60
Double-headed ground nail 25/480	38	MTT stair rail	51	Tension belt clamp H20	27
Double-jointed foot plate	57	MTT stair rail adaptor	52	Tie rod DW	31
Drive nut 60	39	MTT stair railings circulation MTT	52	Tie wrench DW20/DW23	31
End plate connector DW15	57	MTT stair rail post 130	52	Top unit 73	59
End plate connector DW15	67	MTT stair with landing Alu(minium)	50	Trestle for beams 40/30	44
EuMax 20	30	MTT standard	47	Triplex intermediate pieces SB	59
EuMax 30	29	MTT steel deck 257/32	50	Triplex SB	58
Fair-faced concrete plug	32	MTT swivel nut M 16	52	Triplex SB-R Connector 76-48	58
Filling nozzle	68	MTT toe board	54	Tripod	24
Fix anchor	35	MTT wall tie 95	52	Trolley for foundation tape	42
Flange clamp 40	55	Nailable connector for fair-faced concrete	32	Tube connector 48	54
Flange nut 100	39	Nail plate DW 15 MFS	37	Universal shoe MFS	63
Flange Screw H20	25	Planing cap DW	35	Upstand bracket	35
Foot plate 73	60	Plastic tube	40	Washer plate	40
Forked prop head	25	Plug	32	Water stop	41
Formwork girder H20	24	Pressure gauge	42	Wobble anchor DW 26.5/80	31
Formwork-prop connector	55	Push-pull prop R	56	Z-connector 40	28

Formwork girder H20

Robust, all-purpose girder for different tasks.
High load-bearing capacity with only low weight, approved by building authorities; adm. Q = 11 kN; adm. M = 5 kNm.

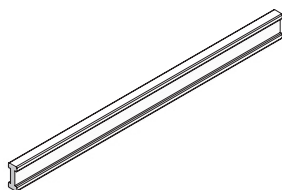

Ref. No.	Description / Application	m ²	kg
29-206-02	Formwork girder H20/245	12.30	
29-206-05	Formwork girder H20/290	14.50	
29-206-10	Formwork girder H20/330	16.50	
29-206-20	Formwork girder H20/390	19.50	
29-206-30	Formwork girder H20/450	22.50	
29-206-45	Formwork girder H20/490	24.50	
29-206-48	Formwork girder H20/590	29.50	

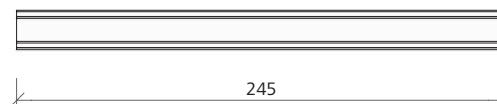

Shuttering panel 3S

Three-layer plywood, 21 mm thick. With resistant coating on both sides. Good pore structure of the concrete due to absorbent surface.



Ref. No.	Description / Application	m ²	kg
29-324-30	Shuttering panel 3S.....250/50	1.25	11.81
29-324-20	Shuttering panel 3S.....200/50	1.00	9.45

Tripod

Galvanized auxiliary to stabilize props with Ø 48 to 80 mm. The turnable legs allow the tripod in rooms, along walls or in corners.
The tripod can be attached to the aluminium profile of the MEP props with the MD safety claw.

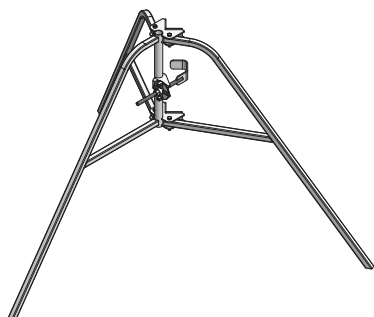

Ref. No.	Description / Application	m ²	kg
29-905-50	Tripod	8.00	
29-905-52	Tripod 120	17.70	

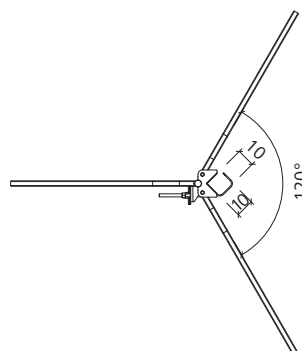
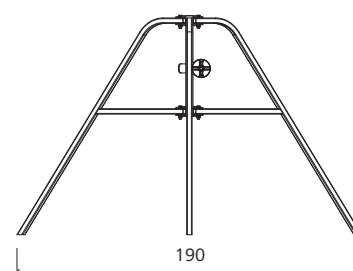
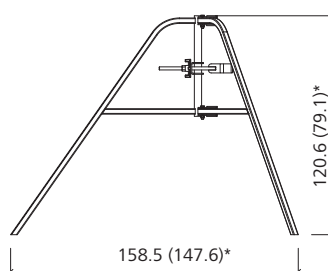

(...)* = 29-905-50

Forked prop head

Galvanized. Supports H20 formwork girders. Is attached to EuMax props with pin 14/90e or to MEP props with pin 14/135.

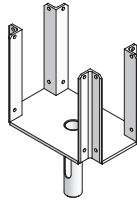

Ref. No.	Description / Application	m ²	kg
29-206-40	Forked prop head H20	3.00	

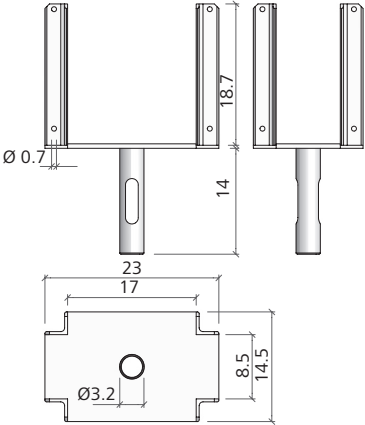

Beam clamp H20

Galvanized. Is used to position intermediate props below H20 girders. Is attached to Eumax props with pin 14/90e or to MEP props with pin 14/135.

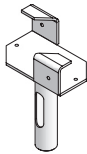

Ref. No.	Description / Application	m ²	kg
29-907-00	Beam clamp H20	0.80	

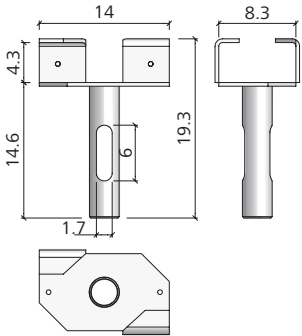

Flange Screw H20

Galvanised. For MGC-JF (Jumpform) and for fastening the H20-beams to the HC-support main beam. 4 pieces per Jumpform (Bracket)

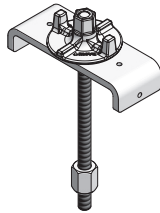

Ref. No.	Description / Application	m ²	kg
29-206-85	Flange screw H20	3.00	

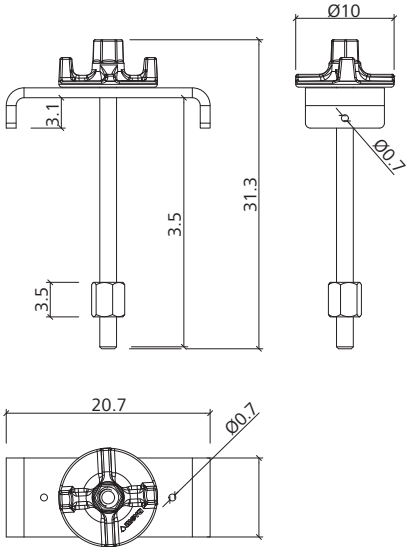

Connector Clip H20

Galvanized. Is used to connect wooden H20 girders to each other. The wedge locks the girdes into place and releases them.

Ref. No.	Description / Application	m ²	kg
29-930-85	Connector Clip H20.....		0.70

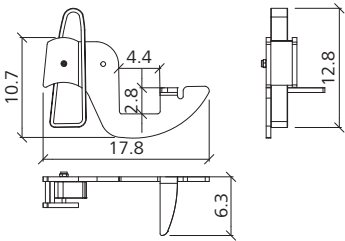
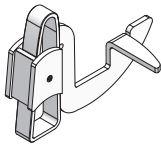

MEVA alu-beam 20

Robust aluminium girder with integrated plastic bar. Usable for different applications. High load capacity thanks to stable form.
Load: Q (cross force) = 39.73 kN, adm. M = 25.96 kN

Ref. No.	Description / Application	m ²	kg
29-216-15	MEVA alu-beam 20/245	26.20	
29-216-45	MEVA alu-beam 20/390	42.00	

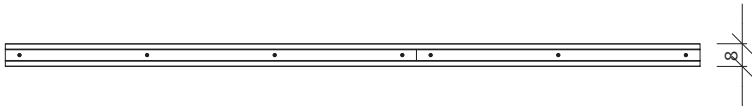
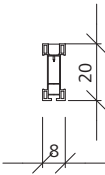
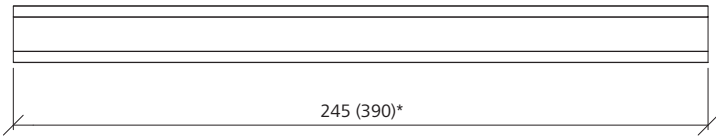
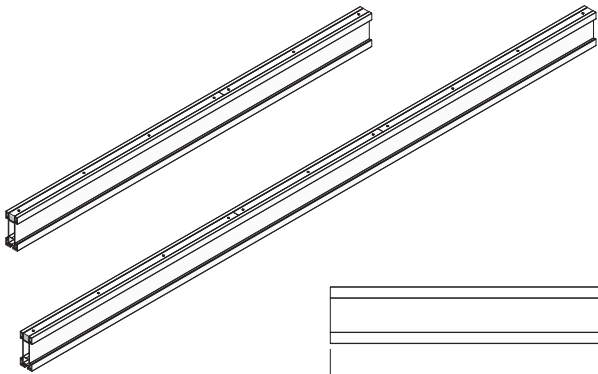

(...)*= 29-216-45

Beam clamp H20/H20

Galvanized. Is used to attach planks or cross beams to H20 beams when using slab tables.

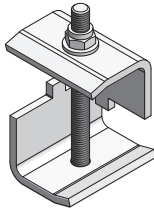

Ref. No.	Description / Application	m ²	kg
29-411-64 Beam clamp H20/H20		0.90

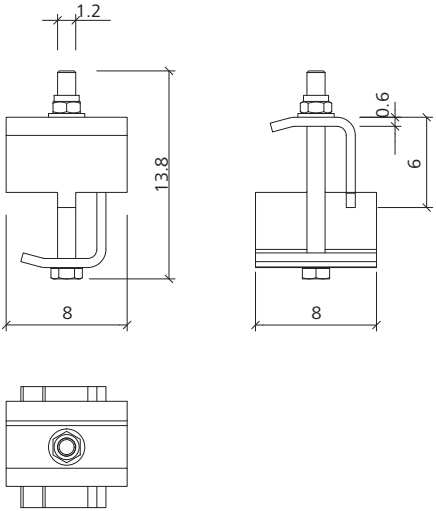

Cross-bracing clamp

Galvanized. Is used to brace steel props with boards when the forming height exceeds 3.00 m. Usable for all prop Øs from 48 to 76 mm.

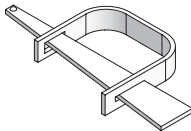

Ref. No.	Description / Application	m ²	kg
29-907-10 Cross-bracing clamp		1.00
29-907-11 Cross-bracing clamp Eumax D88.9		1.50

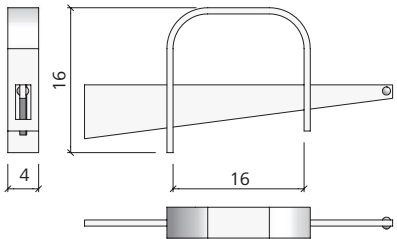

Tension belt clamp H20

Galvanized. Is attached to two wooden girders H20. With eyes to attach the tension belt.

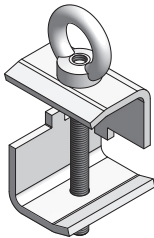

Ref. No.	Description / Application	m ²	kg
29-930-90 Tension belt clamp H20		1.00

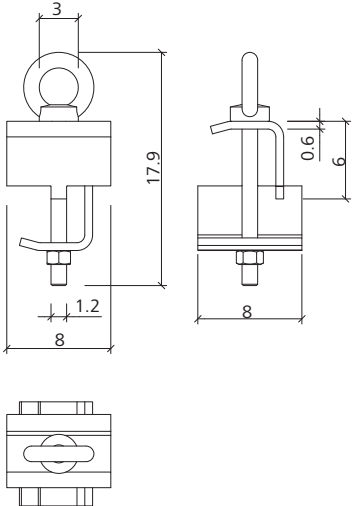

Z-connector 40

Galvanized. Connects H20 stringers to H20 joists (flange height 40 mm). We recommend using double-headed nails for attachment.

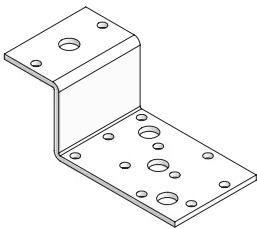

Ref. No.	Description / Application	m ²	kg
29-207-30 Z connector 40.....		0.19

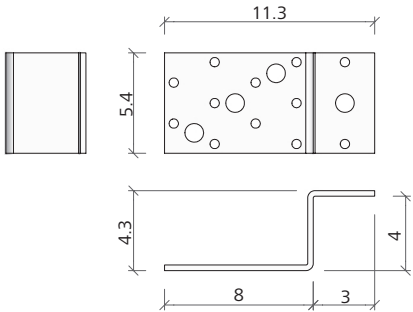

Safety clamp H20

Galvanized. DW thread Ø 15 mm. Connects wood girders with steel profiles, e.g. alignment rails. A flange nut 100 is also required. Thread 22 cm or 30 cm long.

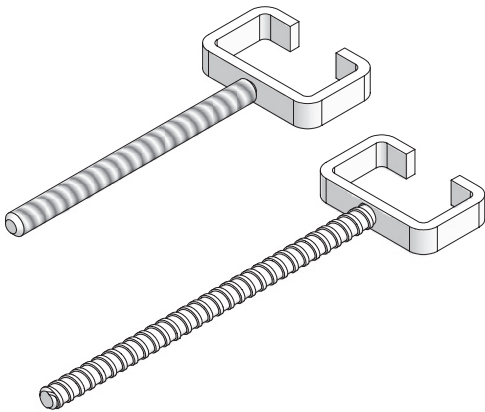

Ref. No.	Description / Application	m ²	kg
29-401-17 Safety clamp H20.....		0.70
29-401-18 Safety clamp H20/30.....		0.77

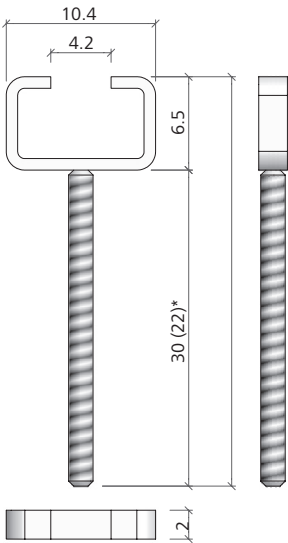

(...)* = 29-401-17

EuMax 30

Ref. No.	Description / Application	m ²	kg
29-907-46	EuMax 30/150 (98-150)	10.40	
29-907-51	EuMax 30/250 (152-250)	18.10	
79-907-50	ME prop 250/30 (150-250)	17.50	
29-907-61	EuMax 30/350 (202-350)	23.00	
79-907-60	ME prop 350/30 (200-350)	25.50	
29-907-62	EuMax 30/450 (252-450)	32.40	
X22-0073	EuMax Pro 30/150 (98-150)	11.50	
X22-0074	EuMax Pro 30/250 (152-250)	18.50	
X22-0075	EuMax Pro 30/350 (202-350)	23.40	
X22-0076	EuMax Pro 30/450 (252-450)	33.00	

EuMax 20

Galvanized. Complies with European Standard EN 1065, class D. The admissible load capacity is 20 kN at all extensions. Higher load capacities are admissible when used with MEVA formwork (see the MevaDec Technical Instruction Manual).

Ref. No.	Description / Application	m ²	kg
29-907-36	EuMax 20/300(177-300)	16.90	
79-907-35	MD prop 300/20(175-300)	17.70	
29-907-41	EuMax 20/400(232-400)	23.80	
79-907-40	MD prop 400/20(225-400)	25.60	
29-907-45	EuMax 20/550(302-550)	37.00	
X22-0070	EuMax Pro 20/300(177-300)	18.30	
X22-0071	EuMax Pro 20/400(232-400)	24.70	
X22-0072	EuMax Pro 20/550(302-550)	38.70	

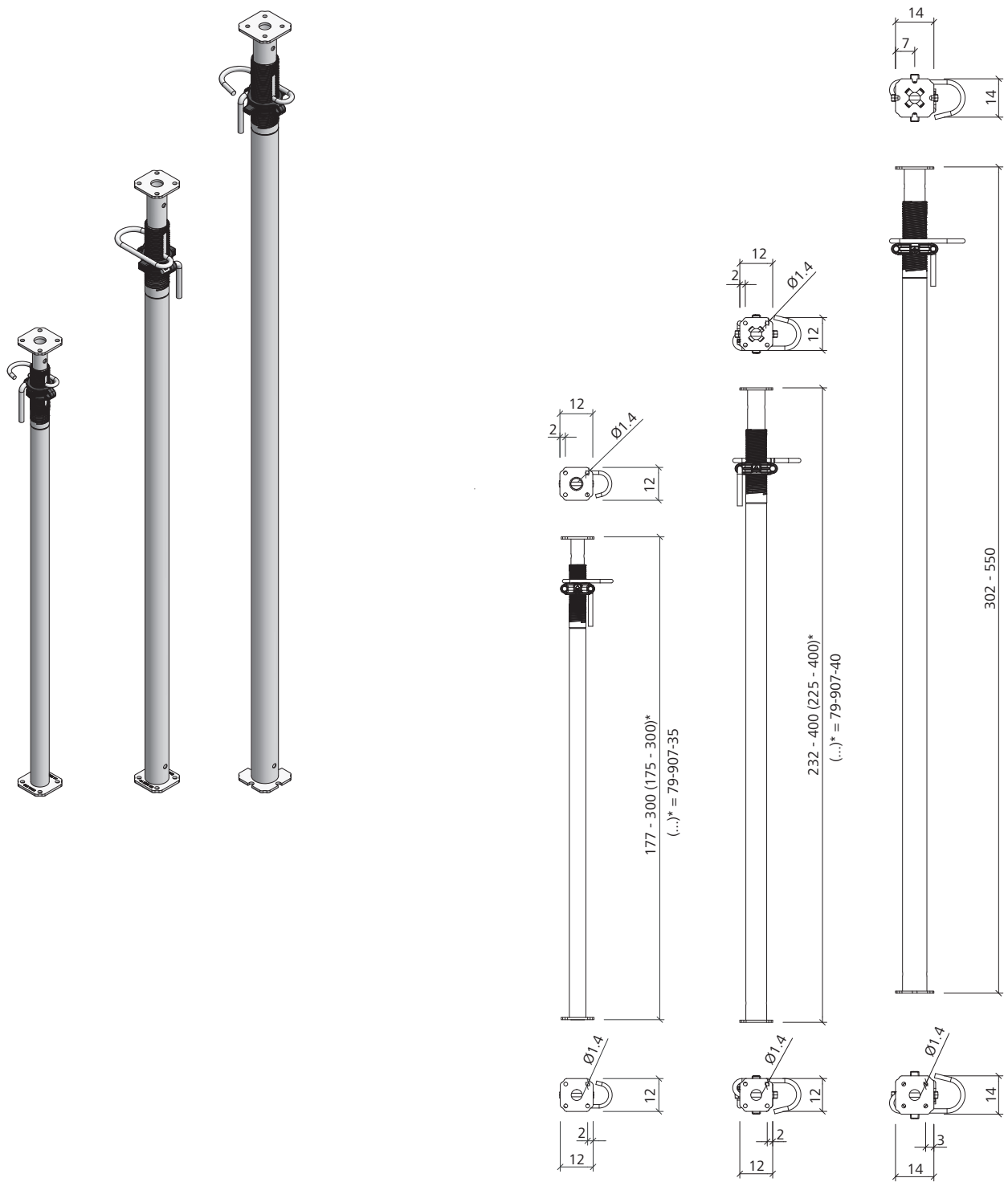

Tie rod DW

Uncoated, not weldable. With DW thread.
Must not be welded or heated. DIN 18216.
Ties panels of double-sided formwork and transfers the loads from the support frame into the bottom slab or foundation. Admissible load capacities: Ø 15 mm 90 kN, Ø 20 mm 160 kN, Ø 26.5 mm 250 kN.

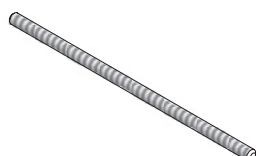

Ref. No.	Description / Application	m ²	kg
29-900-76 Tie rod DW 15/45.....		0.63
29-900-88 Tie rod DW 15/75.....		1.10
29-900-80 Tie rod DW 15/90.....		1.25
29-900-90 Tie rod DW 15/125.....		1.80
29-901-21 Tie rod DW 15/200.....		2.90
29-901-25 Tie rod DW 15/300.....		4.30
29-901-37 Tie rod DW 15/600.....		8.40
29-900-97 Tie rod DW 20/120.....		3.00
29-900-75 Tie rod DW 26.5/80.....		3.60

Tie wrench DW20/DW23

Made of steel, galvanized. Used to screw in, screw out and hold tie rods DW20 and DW23; length 640 mm.

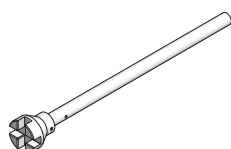

Ref. No.	Description / Application	m ²	kg
29-901-39 Tie wrench DW20/DW23.....		3.10

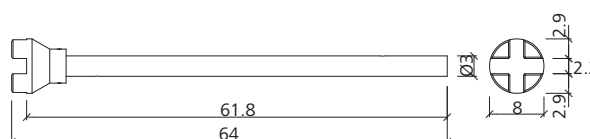

Wobble anchor DW 26.5/80

Raw, weldable, length 80 cm, for rear anchoring in the concrete, adm. load capacity: 240 kN.



Ref. No.	Description / Application	m ²	kg
29-900-72 Wobble anchor DW 26.5/80		3.64

Anchor sleeve

High-density plastic. With nail holder 18. Is pressed onto the nail holder that is nailed to the formwork. Extraction force 40 kN, admissible load 6.5 kN (DW 15). Required minimum concrete strength: 15 N/mm.

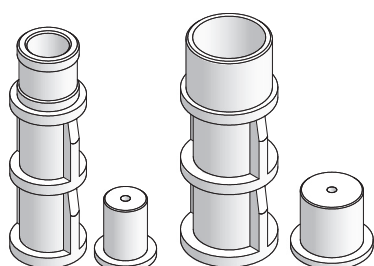

Ref. No.	Description / Application	m ²	kg
29-917-90 Anchor sleeve DW 15.....		0.05
29-917-95 Anchor sleeve DW 20.....		0.08

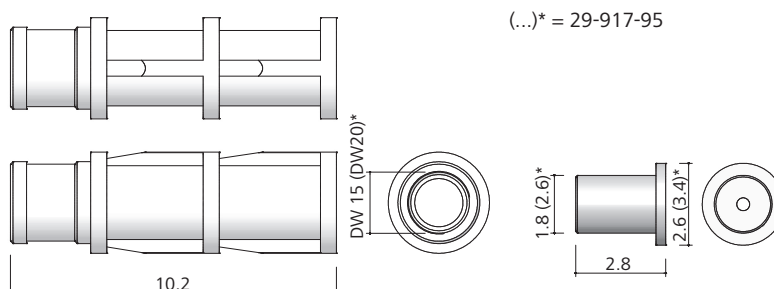

Plug

Plastic. Closes and seals stop-end sleeves and plastic tubes.



Ref. No.	Description / Application	m ²	kg
29-922-10 Plug 18	0.01
29-922-15 Plug 22	0.01
29-922-20 Plug 26.5	0.01

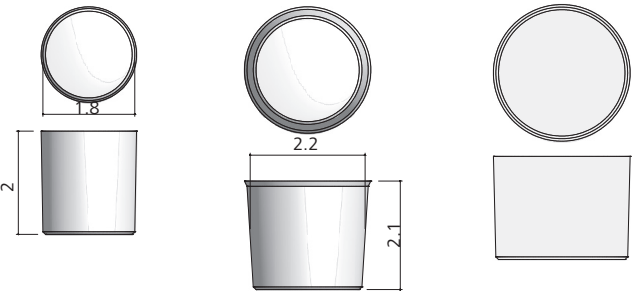

Nailable connector for fair-faced concrete

Plastic, red. For fair-faced concrete plugs DW 15. Is used to attach anchor sleeves DW 15 to the facing.

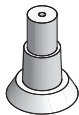

Ref. No.	Description / Application	m ²	kg
29-921-80 Nailable connector DW15	0.02

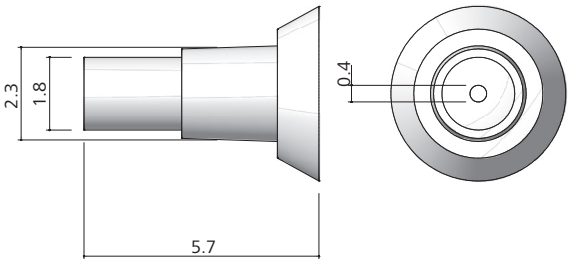

Fair-faced concrete plug

Made of concrete. Seals the nailable connector for fair-faced concrete. Is glued with concrete glue A+B.

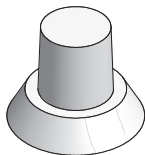

Ref. No.	Description / Application	m ²	kg
29-921-85 Fair-faced concrete plug DW 15	0.05

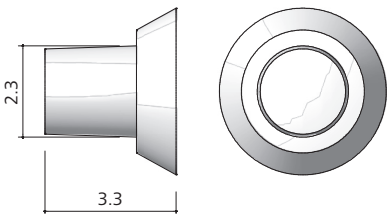

Anchor support DW 15 - DW 26.5

Steel, uncoated. Bottom bent by 45°. Supports DW 15, DW 20 and DW 26.5 tie rods. The tie rods are re-usable if PVC sleeves are used. The anchor support is always attached with the integrated adjusting screw.

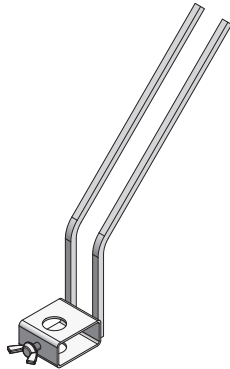

Ref. No.	Description / Application	m ²	kg
29-925-80	Anchor support DW 15 - DW 26.5		1.13

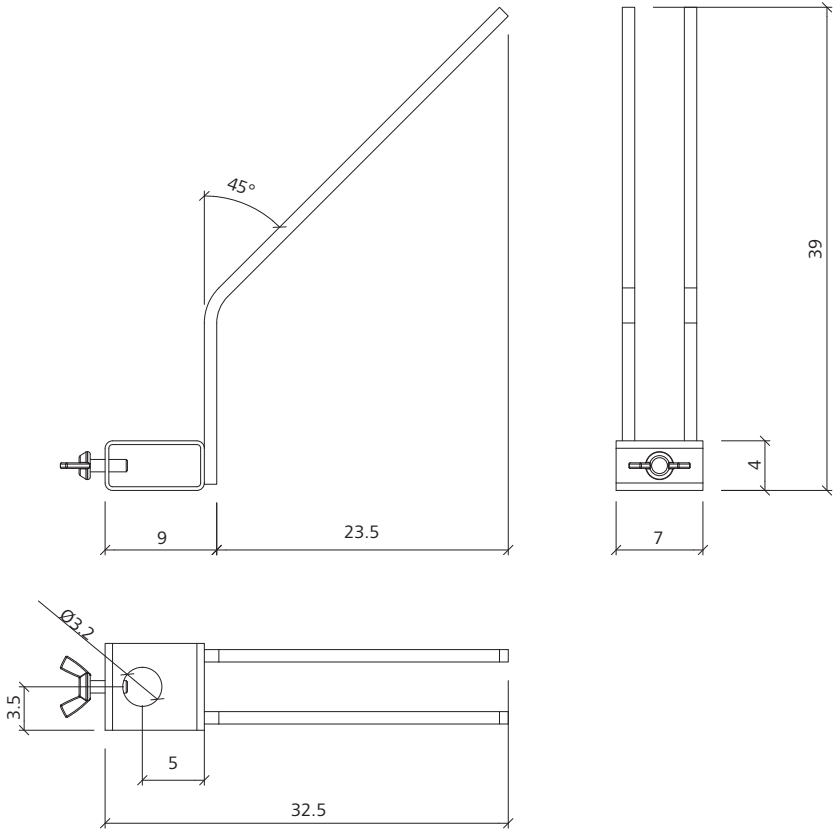

Single anchor DW

Steel, uncoated. Admissible load: DW 15 = 90 kN, DW 20 = 160 kN, DW 26.5 = 250 kN. Is used for 45° anchoring in the bottom slab when using support frames. Attachment at bottom rebar.

Ref. No.	Description / Application	m ²	kg
29-925-40	Single anchor DW15		0.80
29-925-45	Single anchor DW 20		1.30
29-925-50	Single anchor DW 26.5		2.40

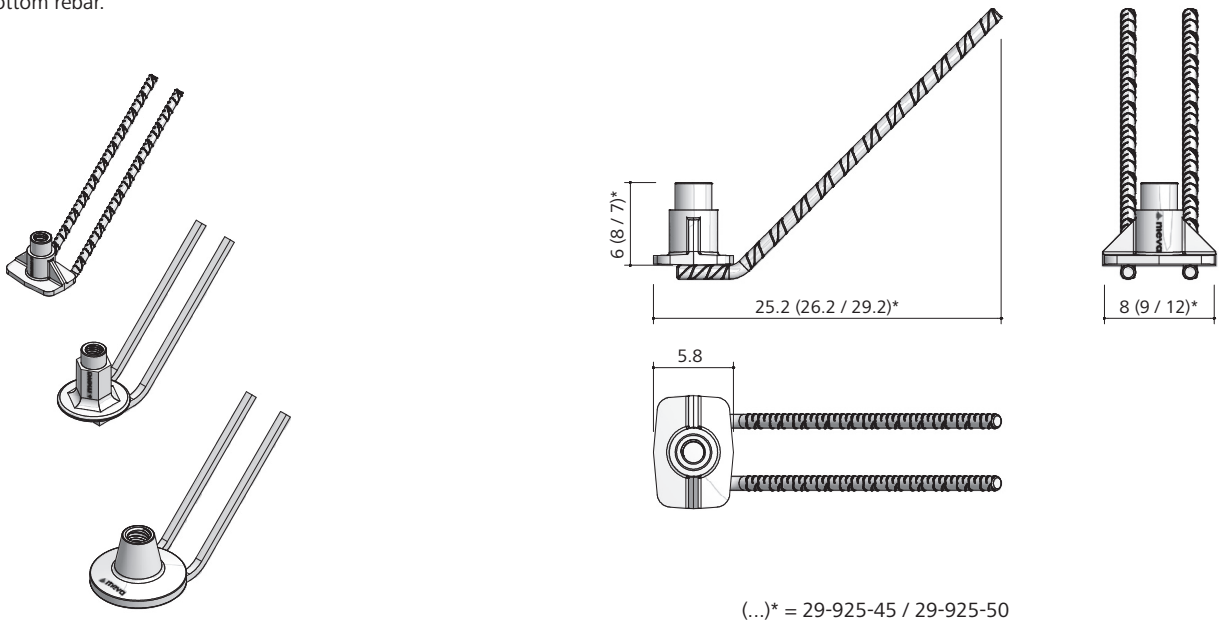

(...)* = 29-925-45 / 29-925-50

Double anchor DW

Steel, uncoated. Admissible load: DW 15 = 180 kN, DW 20 = 320 kN. Is used for 45° anchoring in the bottom slab when using support frames. Attachment at bottom rebar.

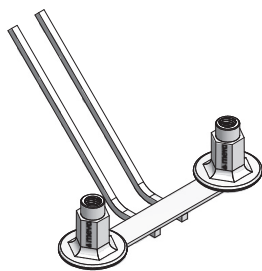

Ref. No.	Description / Application	m²	kg
29-925-60	Double anchor DW 15	1.90	
29-925-65	Double anchor DW 20	2.70	

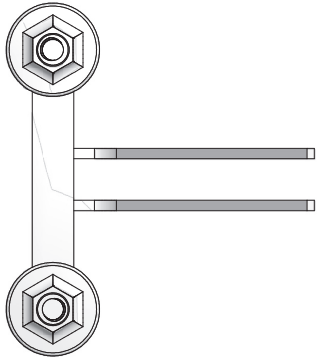
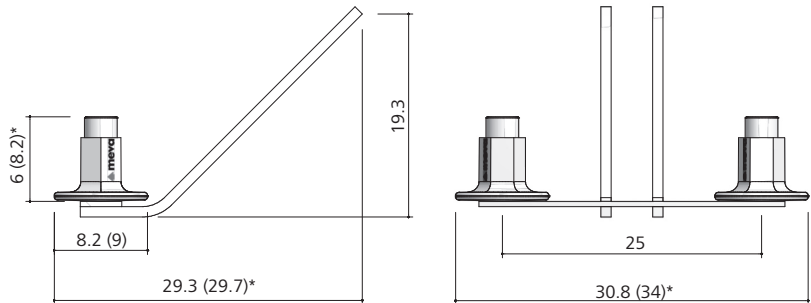

(...)* = 29-925-65

Anchor loop

Uncoated, not weldable. With DW thread. DIN 18216. Transfers the load from the support frame into the floor slab or foundation. Adm. load depends on loop diameter. Ø 15 mm: 2 x 90 kN = 180 kN. Ø 20 mm: 2 x 160 kN = 320 kN.

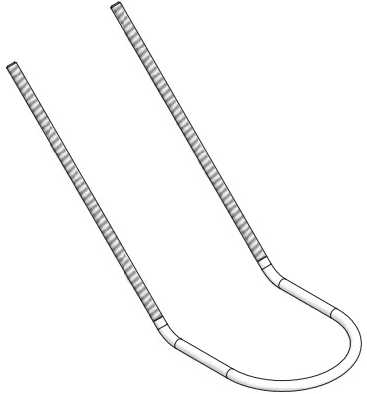

Ref. No.	Description / Application	m²	kg
29-001-20	Anchor loop 15	2.40	
29-001-25	Anchor loop 20	4.50	

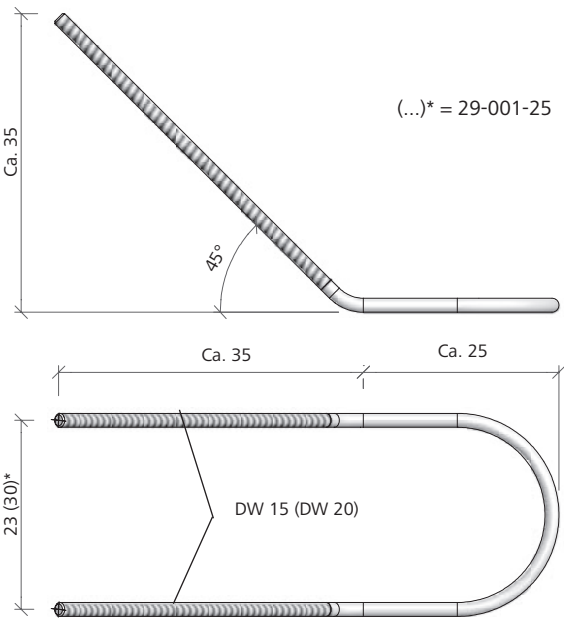

(...)* = 29-001-25

Upright bracket

Adjustment range 100 mm. Is used to brace upstand formwork.

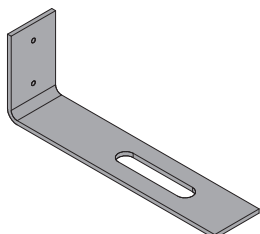

Ref. No.	Description / Application	m ²	kg
29-925-10 Upright bracket.....		1.00

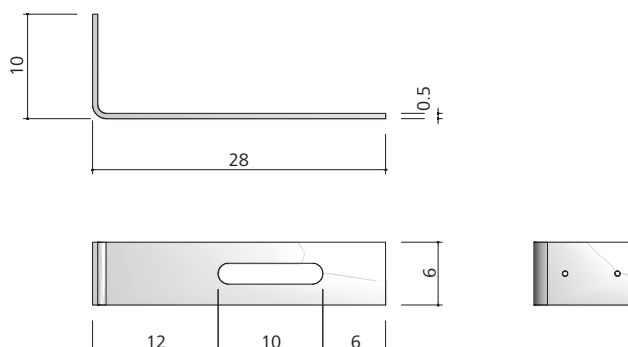

Fix anchor

Uncoated. Is used to anchor tie rods in the concrete with anchor supports.

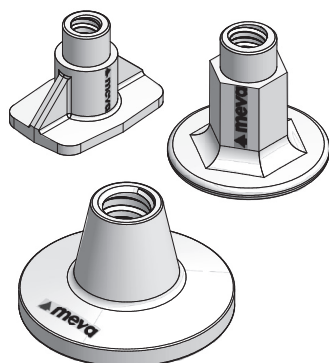

Ref. No.	Description / Application	m ²	kg
29-926-60 Fix anchor DW 15		0.52
29-926-65 Fix anchor DW 20		0.85
29-926-70 Fix anchor DW 26.5		1.90

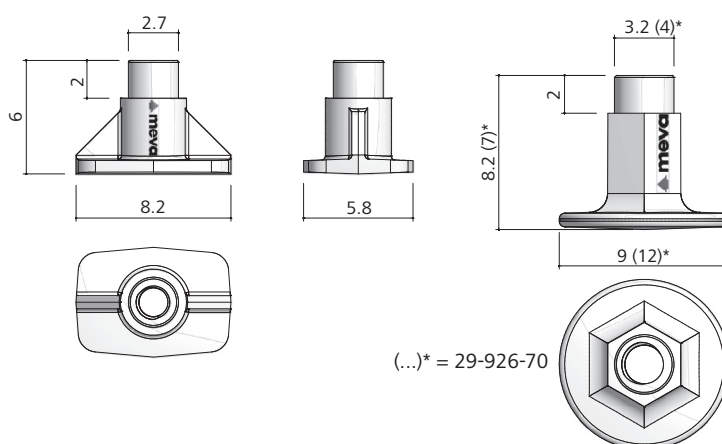

Planing cap DW

Hard foam, 13 cm long, 45° end piece. For DW 15 and DW 20 (or 26.5). Is plugged onto the DW tie rod or on a plastic sleeve for one-sided anchoring of support frames STB. Hole depth 5 cm.

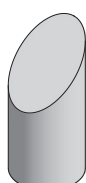

Ref. No.	Description / Application	m ²	kg
29-917-75 Planing cap DW 15.....		0.01
29-917-80 Planing cap DW 20.....		0.01
29-917-85 Planing cap DW 26,5.....		0.02

Spiral anchor DW 15/100

Steel spiral bead, 10 cm long, with styropore core. Is used to attach formwork equipment with tie rods DW 15, e.g. when adjusting the equipment when using push-pull props or the like. Remove the styropore with a 14 mm drill.



Ref. No.	Description / Application	m ²	kg
29-921-10 Spiral anchor DW 15/100	0.06	
29-921-20 Assembly bracket for Spiral anchor MFS	0.10	

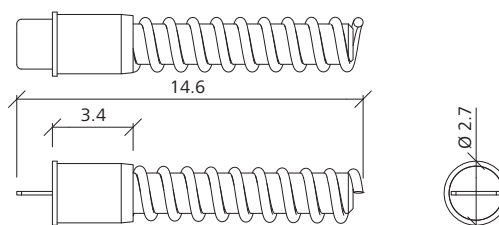

Betondruckfestigkeit	Ausziehenkraft	zulässige Belastung (bei Sicherheitsfaktor 3)
7 N/mm ²	25.5 kN	8.5 kN
13 N/mm ²	35.3 kN	11.8 kN
16 N/mm ²	44.2 kN	14.7 kN
24 N/mm ²	49.9 kN	16.6 kN

Adjustable spanner

Not shown. For DW 15, DW 20 and DW 26.5. Is used to loosen and unscrew recoverable tie rods.

Ref. No.	Description / Application	m ²	kg
29-926-95 Adjustable spanner.....	1.60	

Quick anchor

Including anchor plate and spiral spring. Is pressed into the fresh concrete. The thickness of the upper concrete layer is set by adjusting the anchor plate. Secured in the rebar with the quick anchor holder. Extraction force at 24 N/mm²; concrete strength 49.9 kN.

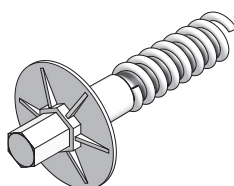

29-922-70 Quick anchor.....	0.30	
29-922-73 Quick anchor anchor plate	0.05	

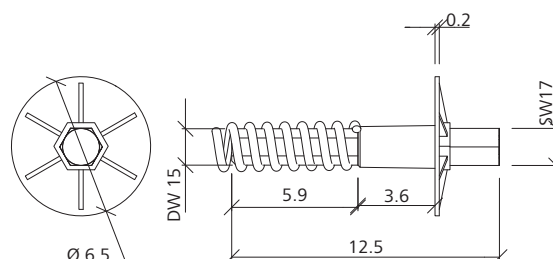

Quick-anchor fixture

To secure the spiral anchor or the quick anchor in the rebar.

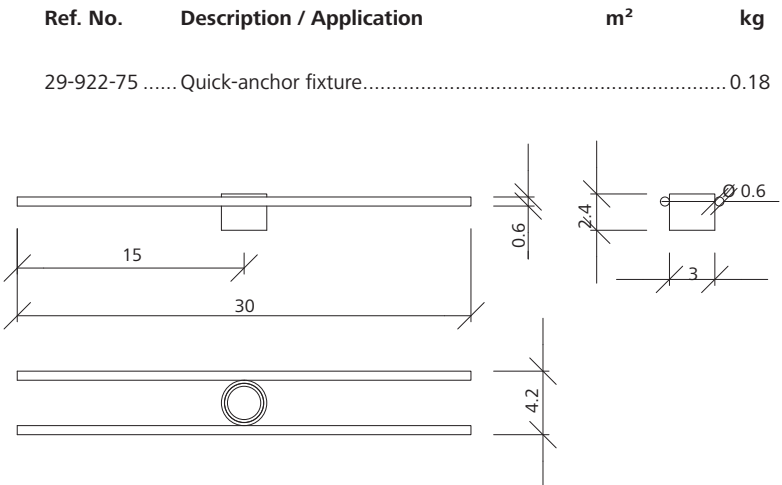
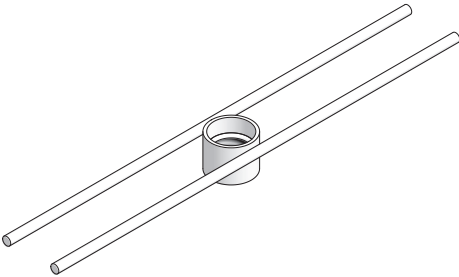

Spiral spring

Spare part, remains in concrete.

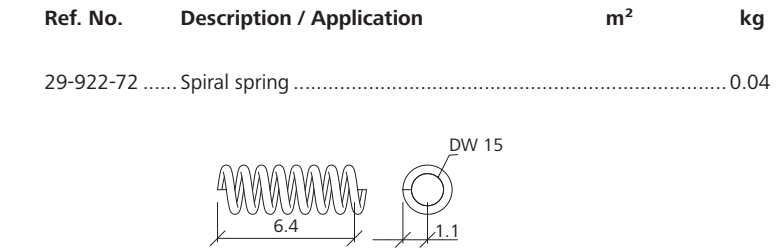

Nail plate DW 15 MFS

Galvanised, for fastening the box-out elements on the slab formwork panel with 4 nails d=65 mm.

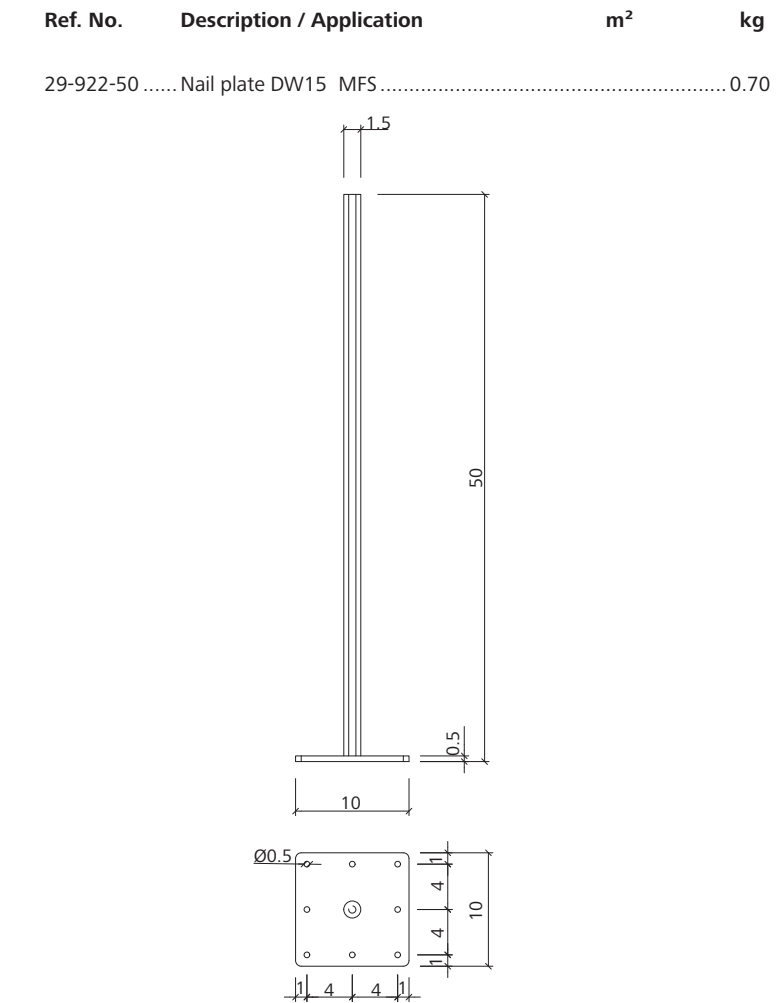
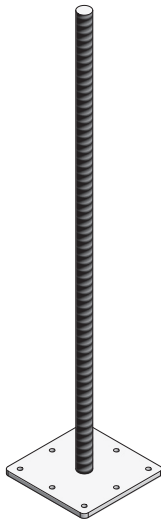

Anchor plate

Uncoated. Is used to anchor climbing cones in the concrete. The admissible load capacity depends on the installation depth of the anchor plate and concrete strength at the time of loading (see approval No. by the DIBt [German Institute for Construction Technology]).

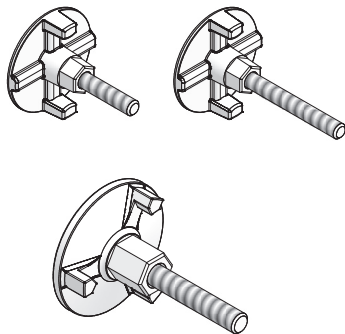

Ref. No.	Description / Application	m²	kg
29-412-30	Anchor plate 15/120	0.80	
29-412-35	Anchor plate 15/170	0.90	
29-412-37	Anchor plate 20/170	1.85	

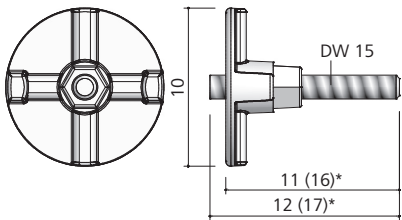

(...)* = 29-412-35

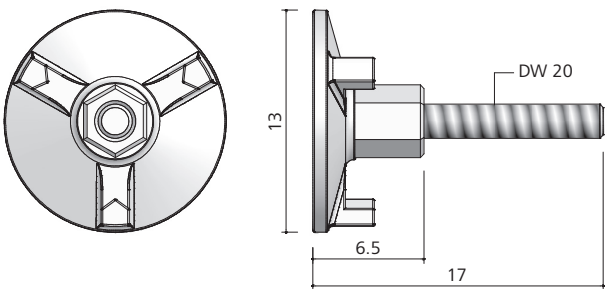

Double-headed ground nail 25/480

Is used to attach brace bracket 80. Double-headed. Is removed from the earth with the extractor (to be ordered separately).

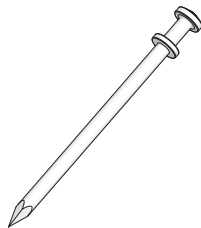

Ref. No.	Description / Application	m²	kg
29-800-45	Double-headed ground nail 25/480	2.00	

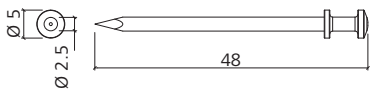

MEVA FormSet

Articulated flange nut

Forged, galvanized. DIN 18216. DW thread \varnothing 15 mm (\varnothing 20 mm), plate \varnothing 120 mm (140 mm). Max. inclination 10°, SW 27 mm (36 mm). Max. load capacity 90 kN (160 kN). Reduces wear of panel coating.

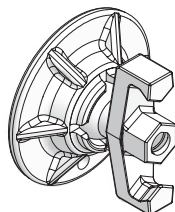

Ref. No.	Description / Application	m ²	kg
29-900-10	Articulated flange nut 15/120	1.81	
29-900-05	Articulated flange nut 20/140	2.40	

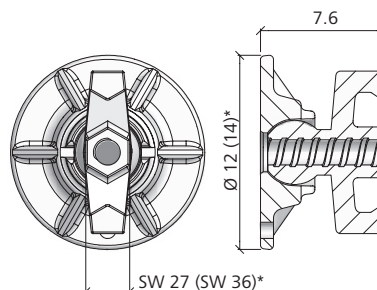

(...)* = 29-900-05

Flange nut 100

Forged, galvanized. DIN 18216. DW thread \varnothing 15 mm, plate \varnothing 100 mm, SW 27. Admissible load capacity 90 kN.

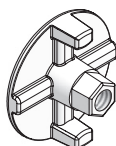

Ref. No.	Description / Application	m ²	kg
29-900-20	Flange nut 100 (SW 27, forged)	0.68	

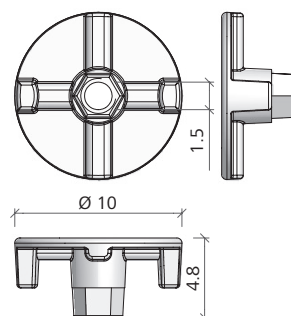

Spanner

Inset yellow chromated. Spanner width (SW) 27 mm. Is used to tighten and loosen flange nuts 100, articulated flange nuts 15/120 and flange screws. Is also used for articulated flange nuts 20/140 with SW 36 mm.

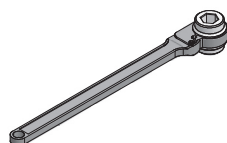

Ref. No.	Description / Application	m ²	kg
29-800-00	Spanner SW 26	1.80	
29-800-10	Spanner SW 27	1.80	
29-800-15	Spanner SW 36	3.30	

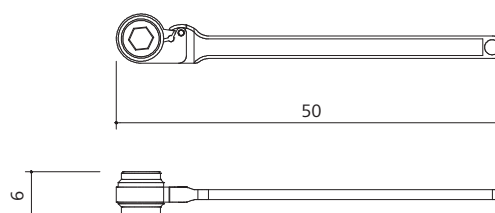

Drive nut 60

Galvanized. DIN 18216. DW thread \varnothing 15 mm, plate \varnothing 60 mm. Adm. load capacity 90 kN. Is used to anchor the formwork to the ground or a wall connection.



Ref. No.	Description / Application	m ²	kg
29-900-23	Drive nut 60	0.50	

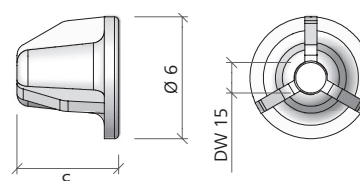

Hexagonal nut

Forged. With DW thread. DIN 18218. Is used to tie the anchors in the bottom slab and to the support frame with a counter plate. Adm. load capacity and SW depend on nut diameter: Ø 15 mm (90 kN, SW 30), Ø 20 mm (160 kN, SW 36), Ø 26.5 mm (250 kN, SW 46).



Ref. No.	Description / Application	m ²	kg
29-900-60	Hexagonal nut 15	0.20	
29-900-61	Hexagonal nut 20	0.50	
29-900-58	Hexagonal nut 26.5	0.50	

Coupling nut

With DW thread. Connect tie rods to the anchor loop when length extension is necessary. Adm. load capacity and SW depend on nut diameter: Ø 15 mm (90 kN, SW 30), Ø 20 mm (160 kN, SW 36), Ø 26.5 mm (250 kN, SW 46).

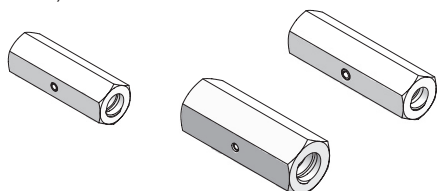

Ref. No.	Description / Application	m ²	kg
29-900-55	Coupling nut DW 15	0.43	
29-900-50	Coupling nut DW 20	0.70	
29-900-56	Coupling nut DW 26.5	1.40	

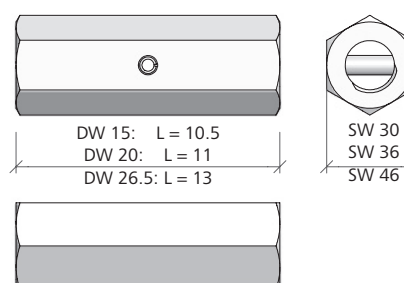

Washer plate

Galvanized. Is used with tie rods DW 15 and hexagonal nuts 15. Washer 40/80/8 for panels with a frame profile width of 40 mm. Washer 60/100/10 for panels with a frame profile width of 60 mm.

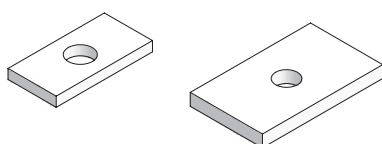

Ref. No.	Description / Application	m ²	kg
29-900-43	Washer plate 40/80/8, galv.	0.20	
29-900-46	Washer plate 60/100/10, galv.	0.50	

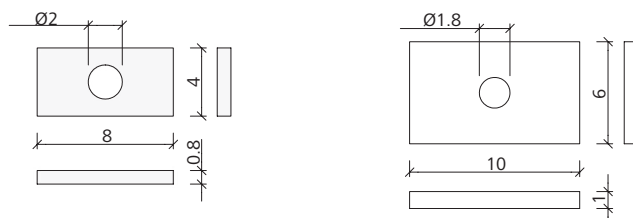

Plastic tube

Is used as a plastic sleeve for a tie rod that is to be recovered and re-used. 2 m long.

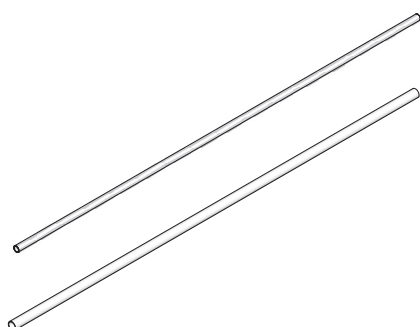

Ref. No.	Description / Application	m ²	kg
29-902-30	Plastic tube D22/200	0.35	
29-902-29	Plastic tube D26/200	0.40	
29-902-28	Plastic tube D32/200	0.40	

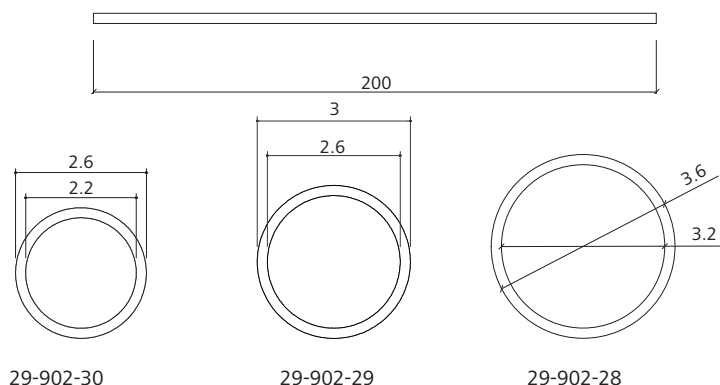

29-902-30

29-902-29

29-902-28

Counter plate

Galvanized. Is used with tie rods DW 15, 20 or 26.5 and the appropriate hexagonal nuts to anchor the support frame. Hole \varnothing 25 mm or 38 mm.

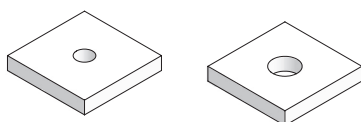

Ref. No.	Description / Application	m ²	kg
29-900-35	Counter plate 120 x 120 x 20/25, galv.....	2.10	
29-900-30	Counter plate 120 x 120 x 20/38, galv.....	2.10	

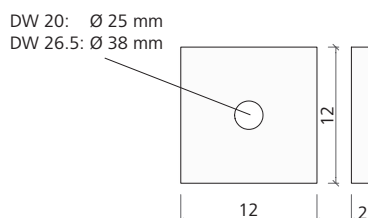

Pressure gauge

Not shown. Measures tractive force of anchors from 250 to 400 kN. Includes compensating plate for tie rods, with 50 mm hole diameter.

Ref. No.	Description / Application	m ²	kg
29-915-15	Pressure gauge 250 kN	6.40	
29-915-00	Pressure gauge 400 kN	6.40	

Spacer

Aluminum-sheet to maintain the distance between the wall thickness. Is inserted between the formwork at the top. For wall thickness 25 cm and 30 cm or 20 cm and 24 cm.

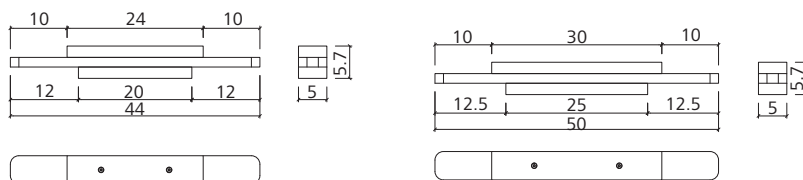
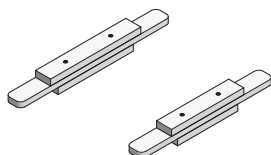

Ref. No.	Description / Application	m ²	kg
29-901-62	Spacer 25/30 AL20/17.....	0.72	
29-901-52	Spacer 20/24 AL20/17.....	0.60	

Foundation tape

Galvanized. Hole spacing 50 mm, hole \varnothing 16 mm, length 50 m. Adm. tractive force 10 kN. To be cut at hole center. Serves together with the appropriate tensioner as bottom anchoring when panels are assembled in horizontal position.

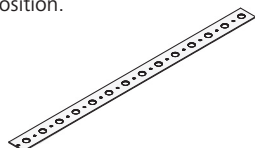

Ref. No.	Description / Application	m ²	kg
29-307-50	Foundation tape 50 m.....	20.00	

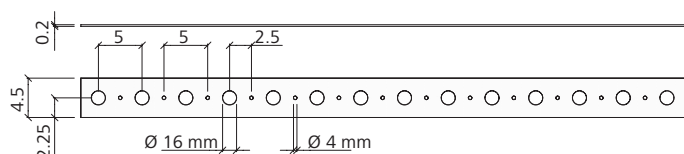

Trolley for foundation tape

Not shown. Is used to transport and cut foundation tapes to length. Suitable for one roll Pneumatic wheels.

Ref. No.	Description / Application	m ²	kg
29-307-55	Trolley for foundation tape.....	21.80	

Door spindle MFS

Steel, galvanized, DW 20. Adjustment range 70 - 110 cm or 55 - 90 cm. Is used to brace door and window blockouts. With nail holes. Torsion-proof and compression-proof. Integrated fail-safe device.

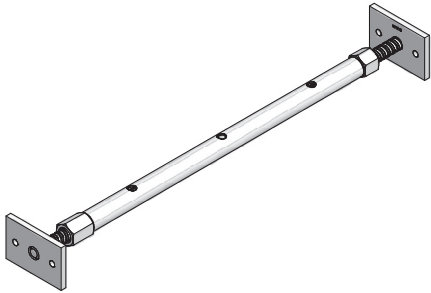

Ref. No.	Description / Application	m ²	kg
29-921-65	Door spindle MFS 700-1100 mm	4.70	
29-921-63	Door spindle MFS 550-900 mm	4.00	

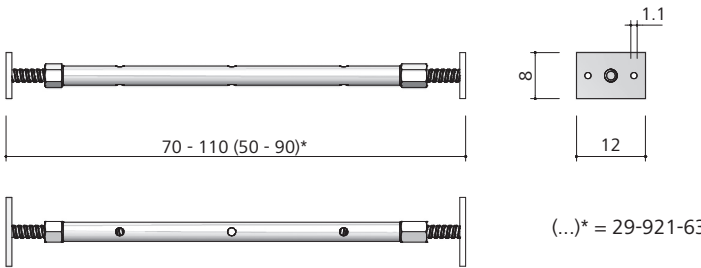

Magnet RS d = 60/80

Used to position small box-outs or electrical sockets. Several magnets are used for box-outs up to 40 cm. The full clamping force is only transmitted when pressed against the facing. Adjustment range 60 - 80 mm

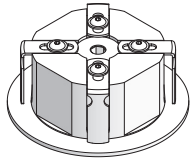

Ref. No.	Description / Application	m ²	kg
23-807-67	Magnet RS d=60/80	1.00	

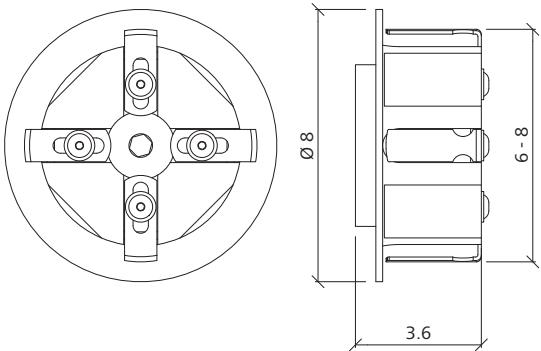

Chamfer strip magnet RS

Is used on steel facing, e.g. on the facing of the Radius circular system.

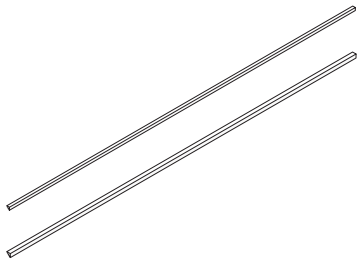

Ref. No.	Description / Application	m ²	kg
29-903-07	Chamfer strip magnet RS 20/20 L=2.00 m	3.20	
29-903-02	Chamfer strip magnet RS 15/15 L=2.00 m	2.24	

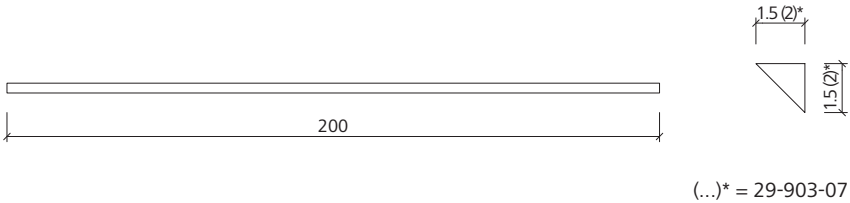

Trestle for beams 40/30

Galvanized. Is used as formwork for concrete beams or for stop ends at slab edges.

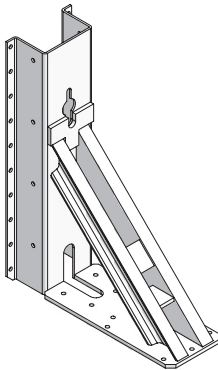

Ref. No.	Description / Application	m ²	kg
29-500-10	Trestle for beams 40/30	5.10	

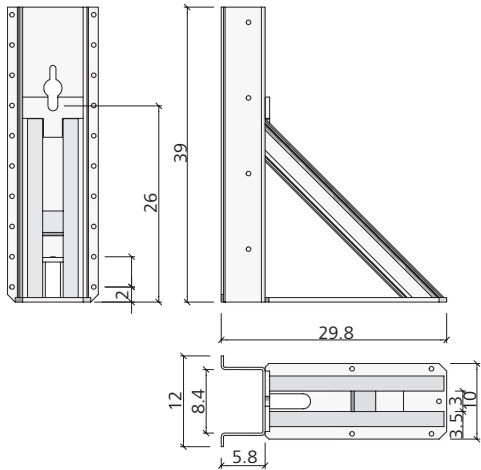

Brace bracket 50 MFS

Galvanised, for base plates and slab edge formwork up to the height of 50 cm. With integrated nailing strip. Fixing in the ground with soil nail. Fixing in the base plate with anchor dowel.

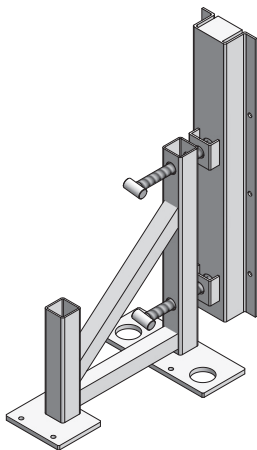

Ref. No.	Description / Application	m ²	kg
29-921-30	Brace bracket 50 MFS	5.80	

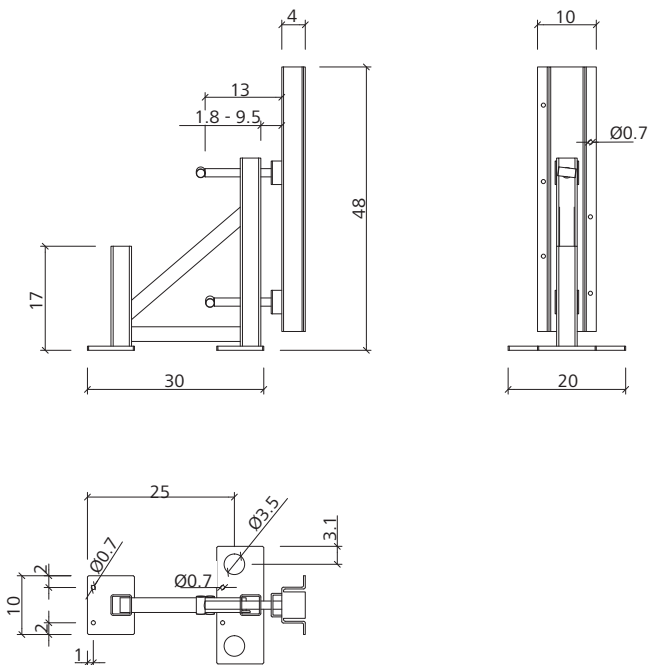

Brace bracket 80

Galvanized. Can be used for floor slabs and slab ends up to 80 cm high. Can be inclined by up to +/- 15°. With plastic nail bar. Can be folded for transport.

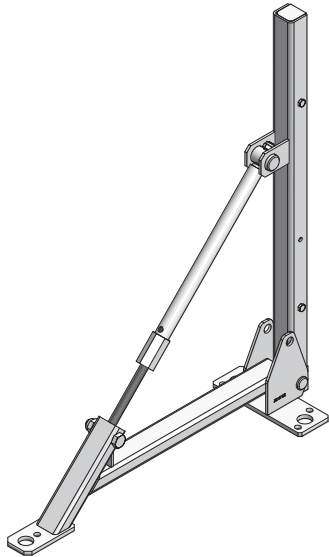

Ref. No.	Description / Application	m ²	kg
29-921-35	Brace bracket 80	11.50	

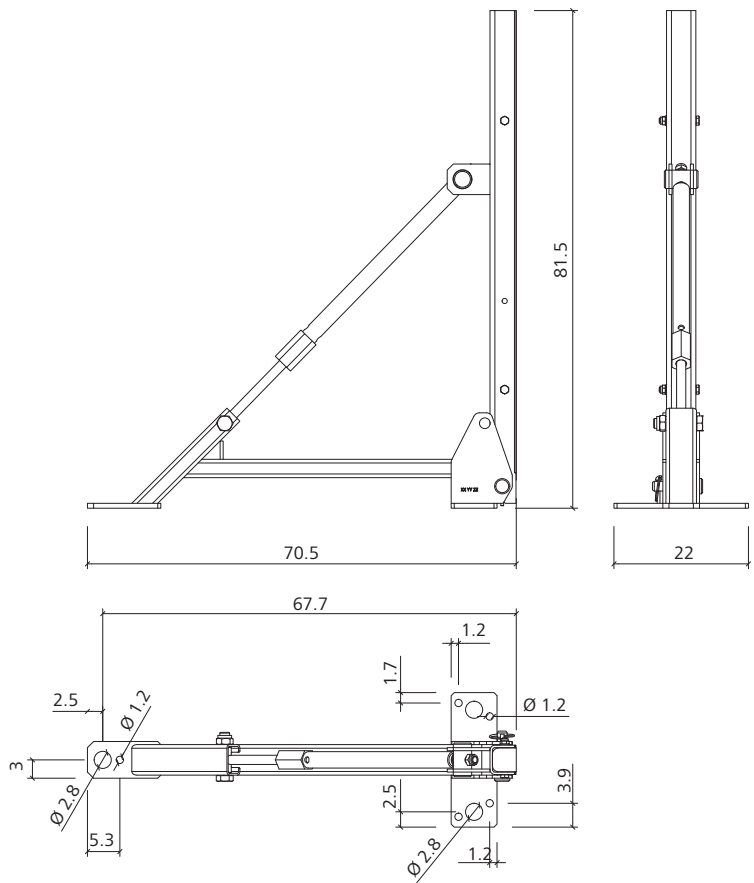

Stop-end bracket MFS

Steel, galvanized. Is used for cantilevering slabs up to 50 cm and slabs up to 40 cm thick. Delivery includes formwork support and support for MEVA guardrailing post.

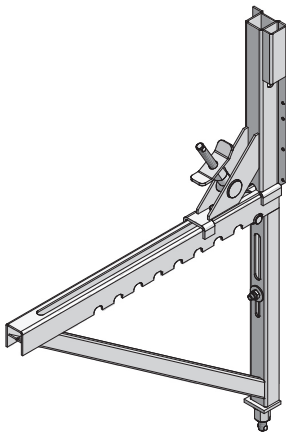

Ref. No.	Description / Application	m ²	kg
29-921-40	Stop end bracket MFS	14.50	

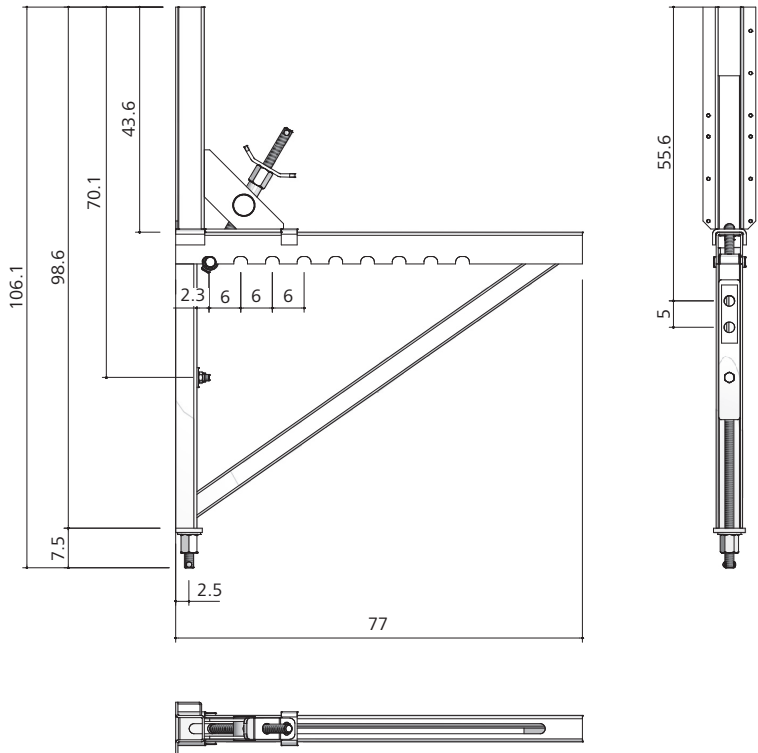

Stop-end rail MFS

Steel, galvanized. Is used to form slab ends for slabs up to 60 cm thick.

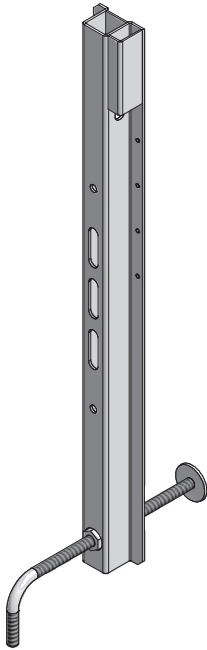

Ref. No.	Description / Application	m ²	kg
29-921-50	Stop end rail MFS		7.20

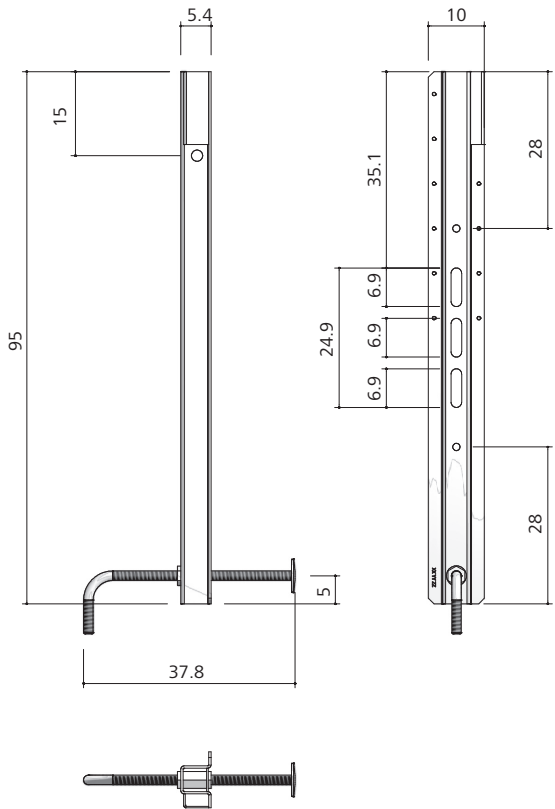

Stop-end spindle MFS

Steel, galvanized. DW 15. Is used as an anchor to adjust the stop-end rail and form-work.

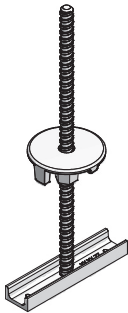

Ref. No.	Description / Application	m ²	kg
29-921-55	Stop end spindle MFS DW 15		1.90

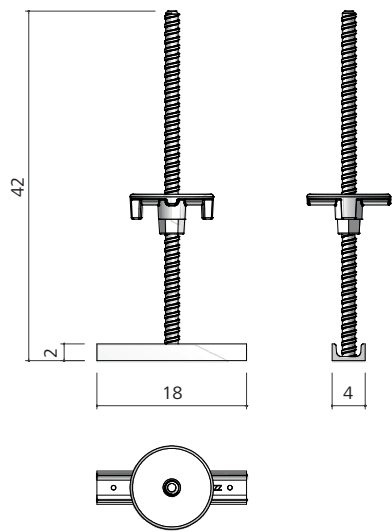

MTT base standard 221

made of steel, with moulded tube connector,
used at the base of the MTT without starter,
it is provided with 5 punched discs



Ref. No.	Description / Application	m²	kg
24-200-45 MTT base standard 221		10.00

MTT standard

Steel tube, Ø 48.3 x 3.2 mm, hot-dip galvanised,
with a punched disc every 50 cm for up
to 8 connections. The 4 small recesses are for
rectangular connections, the 4 large recesses
are for connections at any angle.

Ref. No.	Description / Application	m²	kg
24-200-39 MTT standard 250		12.20
24-200-44 MTT standard 221		11.50
24-200-40 MTT standard 200		10.20
24-200-41 MTT standard 150		7.80
24-200-42 MTT standard 100		5.50
24-200-43 MTT standard 50		3.20

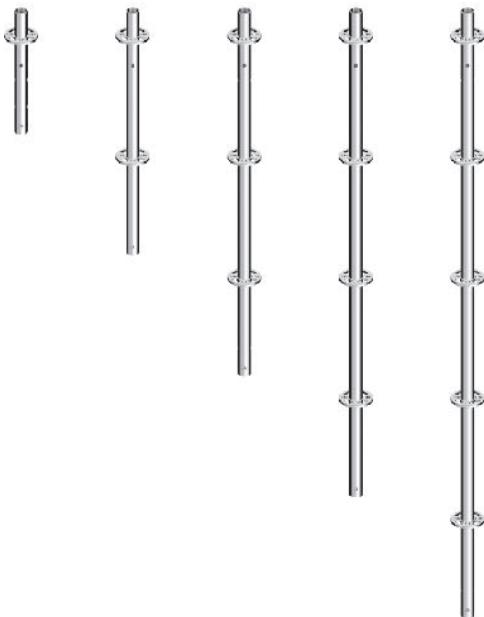

MTT ledger

Steel. Is used to support the steel deck, for bracing and as a railing. The gib and cotter connections ensure the tight and solid connection and central load application between MTT standards and ledgers. The gib and cotter connections provide maximum safety from the moment tower assembly is started because they prevent the loosely inserted ledgers from unhinging. Longitudinal ledgers are not required on steel deck level if the steel deck is protected against lifting and tilting by its safety device.

Ref. No.	Description / Application	m ²	kg
24-201-10 MTT ledger 257.....		9.40
24-201-20 MTT ledger 140.....		5.40
24-201-25 MTT ledger 109.....		4.00
24-201-30 MTT ledger 45.....		2.40



MTT ledger 190 wedge head

Is used as a guard rail on the stair tower's top level. With u-fork or rigid coupler.

Ref. No.	Description / Application	m ²	kg
24-201-40 MTT ledger 190 wedge head		7.80

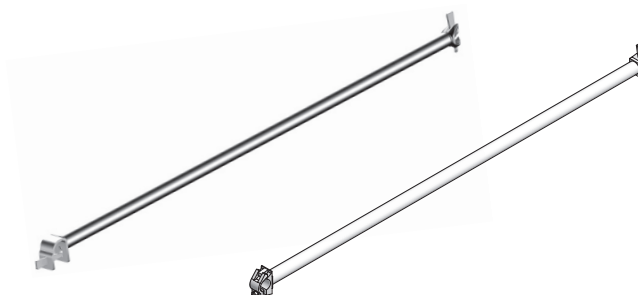

MTT diagonal brace

Steel. The diagonal braces with gib and cotter connections additionally brace the basic tower consisting of MTT standards and ledgers.

Ref. No.	Description / Application	m ²	kg
24-202-10 MTT diagonal brace 257/200		9.50
24-202-11 MTT diagonal brace 257/150		8.20
24-202-12 MTT diagonal brace 257/100		7.40
24-202-20 MTT diagonal brace 140/200		7.50
24-202-21 MTT diagonal brace 140/250		6.90
24-202-22 MTT diagonal brace 140/100		5.90
24-202-15 MTT diagonal brace 109/200		7.00



MTT base spindle 60

With robust and self-cleaning knuckle thread. Colour and groove marks protect the thread from overwinding. Make sure to place the spindle on a basis strong enough to transfer the load. Adjustment range: 41 cm.



Ref. No.	Description / Application	m ²	kg
24-202-60 MTT base spindle 60		3.60

MTT base collar

The base collar with punched disc and the height-adjustable base spindle 60 are the foot of the tower. When assembling the tower, the MTT standards at the tower's bottom are plugged into the base collars.



Ref. No.	Description / Application	m ²	kg
24-202-80 MTT base collar		1.41

MTT spindle holder

galvanized, safely connects the MTT base standard 221 with the base spindle 60 to prevent the spindle from falling down when the tower is lifted by crane.



Ref. No.	Description / Application	m ²	kg
24-202-72 MTT spindle holder.....		0.80

MTT spindle attachment with wedge head

Secures the base collar and the base spindle 60 against falling off when crane-lifting the stair tower.



Ref. No.	Description / Application	m ²	kg
24-202-70 MTT spindle attachment with wedge head.....		2.00

MTT spigot

Is used to connect 2 MTT standards. Attachment with 4 hinged pins, dia. 12 mm.



Ref. No.	Description / Application	m ²	kg
24-202-76 MTT spigot.....		1.60

MTT hinged pin, D=12

Connects the MTT standards with each other.



Ref. No.	Description / Application	m ²	kg
24-202-90 MTT hinged pin D=12		0.10

MTT stair with landing
Alu(minium)

Steps with a rise of 20 cm. Workers can ascend safely and without fatigue even when transporting material. Admissible load: 200 kg/m².



Ref. No.	Description / Application	m ²	kg
24-200-20 MTT stairs with landing Alu 257/ 64 H200		23.20
24-200-21 MTT stairs with landing Alu 257/ 64 H150		22.80
24-200-10 MTT starting stair Alu H100.....		14.80
24-200-23 MTT stairs with landing Alu 50		11.20

MTT steel deck 257/32

Perforated, antislip, with integrated swivelling safety device that prevents the deck from lifting and tilting. Is suspended on ledgers. The deck fulfills the requirements of the German standard DIN EN 12811.



Ref. No.	Description / Application	m ²	kg
24-200-50 MTT steel deck 257/32		18.90

MTT access hatch 257

aluminium, 0,61m wide with integrated ladder.

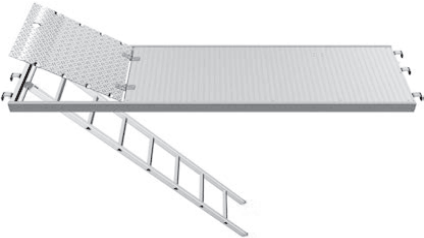

Ref. No.	Description / Application	m²	kg
24-200-60	MTT access hatch 257	26.50	

MTT stair rail

Is used as a fall-down protection.

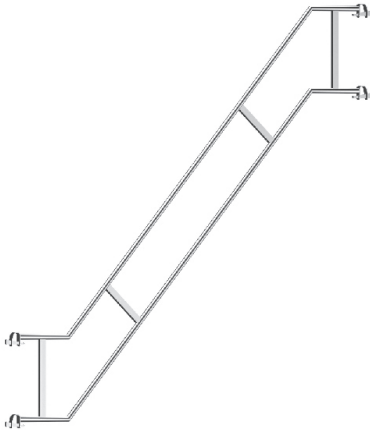

Ref. No.	Description / Application	m²	kg
24-200-70	MTT stair rail 257 H200	18.10	
24-200-71	MTT stair rail 257 H150	17.00	

MTT internal stair rail

Is used as a fall-down protection.

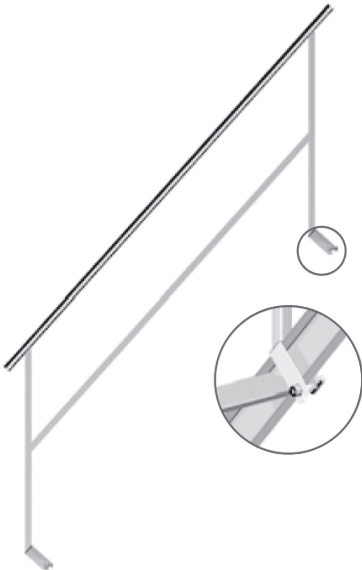

Ref. No.	Description / Application	m²	kg
24-200-78	MTT internal stair rail H200	12.50	
24-200-79	MTT internal stair rail H150	11.30	
24-200-80	MTT internal stair rail H100	10.20	

MTT stair railings circulation MTT

Galvanized. Is used as a fall-down protection for stairs at mid-level.



Ref. No.	Description / Application	m ²	kg
24-200-95	MTT stair railings circulation	6.20	

MTT stair rail adaptor

Is used to attach stair rails when no 1.40 m ledgers are available.



Ref. No.	Description / Application	m ²	kg
24-202-85	MTT stair rail adaptor	0.70	

MTT stair rail post 130

Is used to attach the 1.90 m ledger, wedge head and U-fork.



Ref. No.	Description / Application	m ²	kg
24-200-90	MTT stair rail post 130	6.10	

MTT wall tie 95

Scaffolds and stair towers must be anchored vertically and parallel to the facade of a building. Anchoring must be a pressure-proof and high-tensile. To achieve this, the wall tie 0.95 m must be attached to the MTT standard with a coupler and its Y-sheet be supported by ledger's U-profile.



Ref. No.	Description / Application	m ²	kg
24-202-50	MTT wall tie 95	3.70	

MTT swivel nut M 16

Galvanized. Is used for anchoring at the building wall.



Ref. No.	Description / Application	m ²	kg
24-202-97	MTT swivel nut 12x350, galv.	0.38	

Scaffold tube

Galvanized. Is used to reinforce large-size units of support frames or climbing scaffolds for crane ganging.

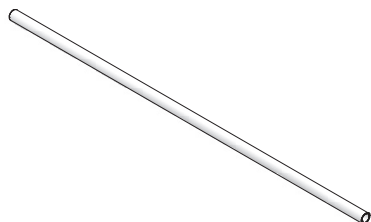

Ref. No.	Description / Application	m ²	kg
29-412-23	Scaffold tube 48/200.....	9.40	
29-412-26	Scaffold tube 48/300.....	14.10	
29-412-27	Scaffold tube 48/400.....	18.80	
29-412-25	Scaffold tube 48/500.....	23.50	
29-412-28	Scaffold tube 48/600.....	28.20	

Swivel-joint coupler 48/48

Galvanized. Connects two scaffold tubes with Ø 48.3 mm at any angle.

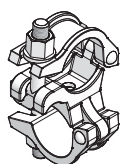

Ref. No.	Description / Application	m ²	kg
29-412-52	Swivel-joint coupler 48/48.....	1.20	
29-412-51	Swivel-joint coupler 48/34.....	1.20	
29-412-53	Swivel-joint coupler 48/60.....	1.20	

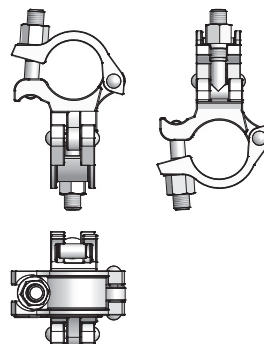

Rigid coupler 48/48

Galvanized. Connects 2 scaffold tubes with Ø 48.3 mm at an angle of 90° (SW 22).

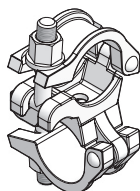

Ref. No.	Description / Application	m ²	kg
29-412-50	Rigid coupler 48/48.....	1.10	

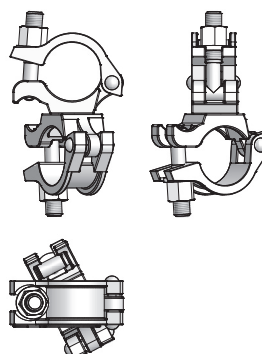

Swivel-joint coupler 48/63

Not shown. Galvanized. Connects a scaffold tube with Ø 48.3 mm and one with Ø 63 mm at any angle required.

Ref. No.	Description / Application	m ²	kg
29-412-54	Swivel-joint coupler 48/63.....	1.80	

Joint coupler 48/48 (SW 22)

Galvanized. Allows scaffold tubes Ø 48.3 mm to be attached at tube joints. Is used together with a tube connector 48.

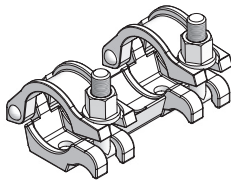

Ref. No.	Description / Application	m²	kg
29-412-55	Joint coupler 48/48 (SW 22)		1.40

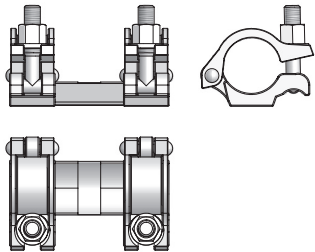

Tube connector 48

Galvanized. Supplement to rigid coupler 48/48. Is used to reinforce the joint of two tubes.

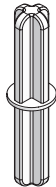

Ref. No.	Description / Application	m²	kg
29-412-57	Tube connector 48		1.10

MTT toe board

wood, for steel decks with O-shaped suspension, used for longitudinal and front sides.

Ref. No.	Description / Application	m²	kg
24-200-88	MTT toe board 109		2.50
24-200-86	MTT toe board 257		5.70



Bolt-on coupler 48/M14

Galvanized. Connects scaffold tubes with Ø 48.3 mm to the support frame, scaffolding bracket, etc.

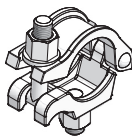

Ref. No.	Description / Application	m²	kg
40-080-70	Bolt-on coupler 48/M14		0.60

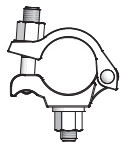

Flange clamp 40

Galvanized. Is used to connect two steel profiles with flanges. Clamping length 0 - 40 mm. Width 57 mm.

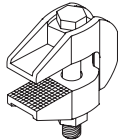

Ref. No.	Description / Application	m ²	kg
29-207-35 Flange clamp 40.....		1.20

MAB MEVA working platform

For work at low heights. Basic scaffold made of aluminium for alternating (first one side then the other) plug-in assembly; aluminium railings and diagonal braces can be easily and securely installed. Working floors made up of an aluminium frame and plywood inserts, also as an access bridge for safe internal access. Sturdy swivel-type castors (permanently mounted) for a high level of stability. Equipped with scaffold props. Working height 4.61 m, scaffold height 3.83 m, platform height 2.61 m. The permissible loading is 2.0 kN/m² on a maximum of one working level (scaffold group 3 according to DIN EN 1004:2005)



Ref. No.	Description / Application	m ²	kg
29-919-00 MAB MEVA working platform		145.50

Formwork-prop connector

Galvanized. Is used to connect a Triplex brace to the multi-function profile with a flange screw 18. Delivery includes head bolt 16/90 and cotter pin 4.

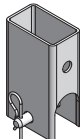

Ref. No.	Description / Application	m ²	kg
29-804-85 Formwork-prop connector		1.60

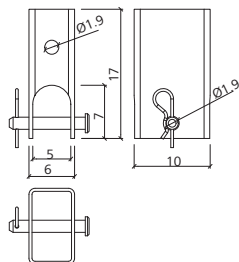

Push-pull prop R

Galvanized. Guarantee tensile and compression strength. Align and brace wall formwork. Length of thread 20.6 cm. Foot plates and formwork-prop-connectors to be ordered separately.

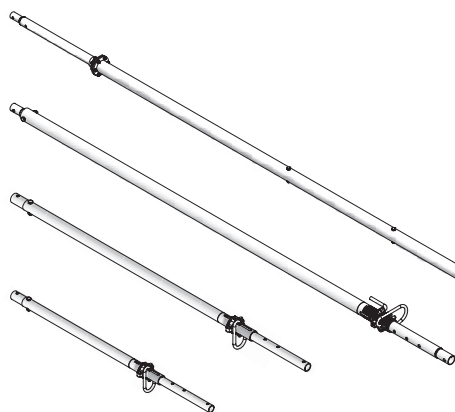

Ref. No.	Description / Application	m ²	kg
29-109-40 Push-pull prop R 160.....(135-200).....	12.60	
29-109-60 Push-pull prop R 250.....(190-320).....	17.20	
29-109-65 Push-pull prop SST 250(190-320).....	17.20	
29-109-80 Push-pull prop R 460(340-520).....	34.00	
29-109-85 Push-pull prop R 630.....(510-760).....	57.00	

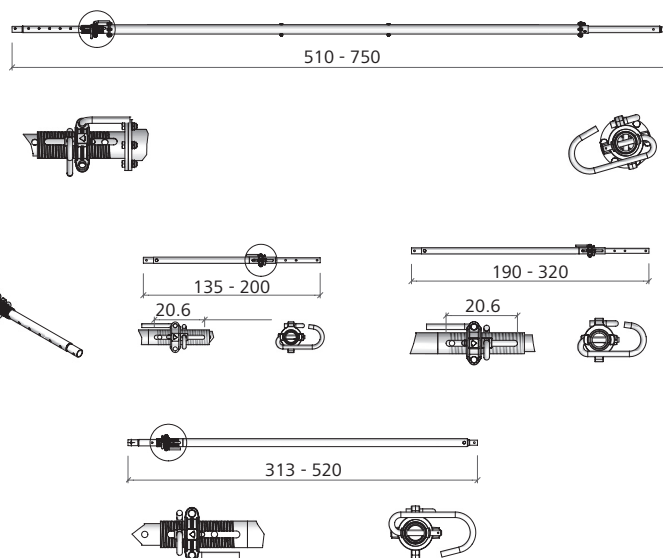

Brace SRL

Galvanized. Guarantees tensile and compression strength. Consists of a right and left-hand spindle as well as a revolving central part. Is used to align and support wall formwork. The footplate and the formwork-prop connector must be ordered separately.

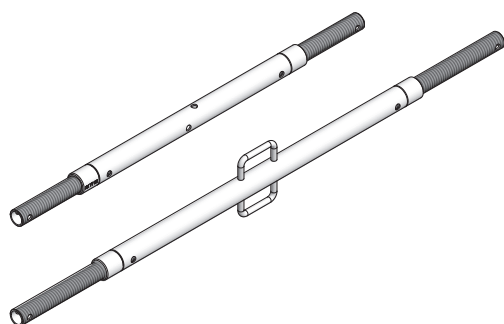

Ref. No.	Description / Application	m ²	kg
29-108-80 Brace SRL 120.....(90-150).....	8.79	
29-108-90 Brace SRL 170.....(120-220).....	11.50	

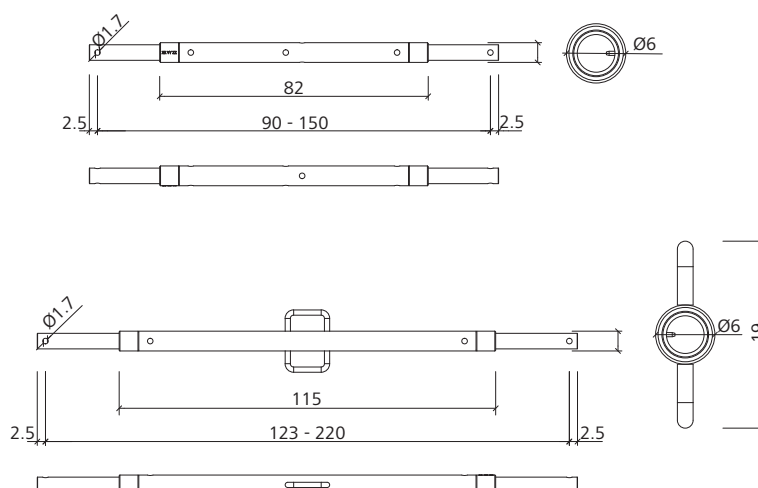

Double-jointed foot plate

Galvanized. Delivery includes head bolt 16/90 and cotter pin 4. Serves as foot plate for brace frames 250 and as connector for braces and push-pull props up to Ø 57 mm.

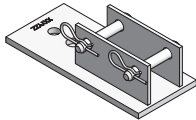

Ref. No.	Description / Application	m ²	kg
29-402-32	Double-jointed foot plate (prop diam. up to 57 mm)	4.00	

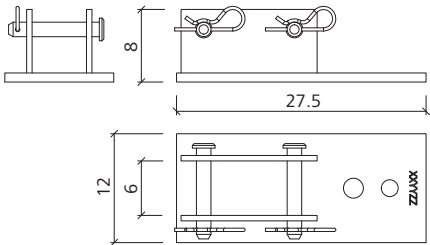

Head bolt 16/90

Galvanized. Is used to attach push-pull props and braces to foot plates and formwork-prop connectors.



Ref. No.	Description / Application	m ²	kg
42-413-50	Head bolt 16/90, galv.	0.17	

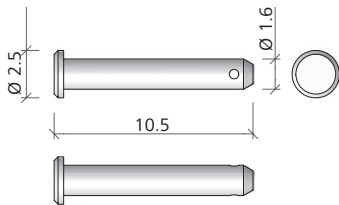

Cotter pin 4

Galvanized. Locks the head bolt.

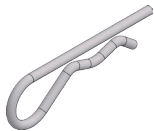

Ref. No.	Description / Application	m ²	kg
62-010-04	Cotter pin 4	0.02	

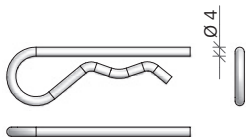

End plate connector DW15

Made of steel, painted in red (RAL 3020), overall width 50 mm, with DW15 thread, for tensioning by means of DW15 tie rods, suitable for MEVA foot plates. The tie rod must be screwed completely through the nut of the end plate connector and must not be used for adjustment. The load capacity in connection with MEVA foot plates has to be calculated for each project.

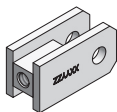

Ref. No.	Description / Application	m ²	kg
29-922-80	End plate connector DW15	1.40	

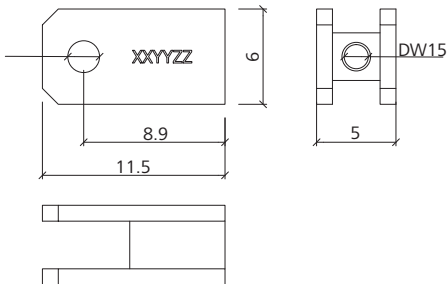

Triplex SB

Galvanized. Triplex SB braces are primarily used for additional load transfer when forming single-sided walls of 6.00 m or higher with support frames STB 450 and extensions 150. Triplex SB braces are delivered as modules without foot plates or formwork-prop connectors and are assembled on site to the required length. The necessary connecting bolts are provided with the height and base extensions. Triplex SB 630 can be ordered pre-assembled. Each Triplex SB 780/880/980 requires one SB 300 right/left-hand thread and an intermediate piece SB 100, 200 or 300 respectively.

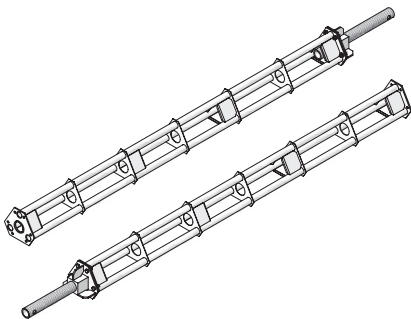

Ref. No.	Description / Application	m ²	kg
29-407-00	Triplex SB 630	140.00	
29-407-15	Triplex SB 300 (right-hand thread)	71.00	
29-407-17	Triplex SB 300 (left-hand thread)	71.00	

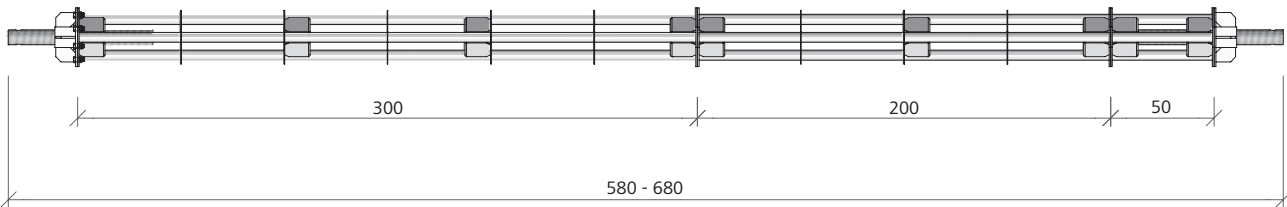
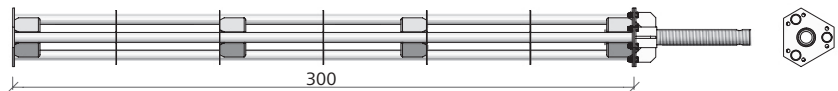
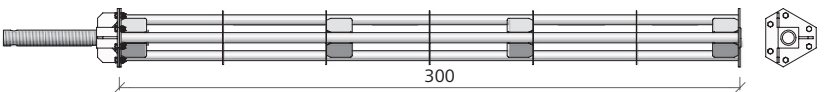

Triplex SB-R Connector 76-48

Steel, galvanized. Is inserted into the head pieces 73 on the right & left side and reduces the connection diameter from Ø73 mm to Ø48 mm. With this adapter, the Triplex SB can therefore be used at connections where this was previously only possible with the Triplex R. Accordingly, the permissible loads of the Triplex R must be observed as maximum loads when using the adapter on the Triplex SB. Pressure loads on the adapter are transferred to the spindles through the welded-on washer of the adapter. Tensile loads on the adapter are transferred to the Triplex SB spindles using the head bolt 17/80 (42 406-61).

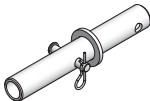

Ref. No.	Description / Application	m ²	kg
29-407-95	Triplex SB-R Connector 76-48	2.62	

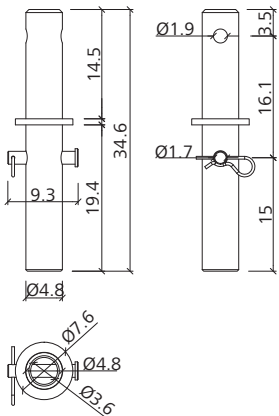

Triplex intermediate pieces SB

Galvanized basic components of different lengths to build Triplex SB units. Tube \varnothing 48.3 mm. Delivery includes the required connecting material (hexagonal screws M16x40 and locking nuts M16).

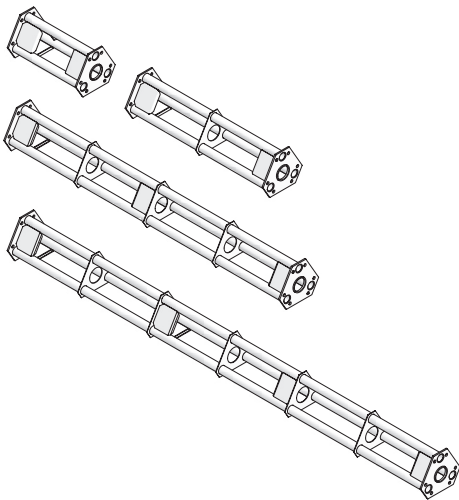

Ref. No.	Description / Application	m ²	kg
29-407-30	Triplex intermediate piece SB 50	15.21	
29-407-35	Triplex intermediate piece SB 100	22.14	
29-407-40	Triplex intermediate piece SB 200	37.72	
29-407-45	Triplex intermediate piece SB 300	53.30	
63-120-49	Hexagonal bolt M16 x 40, galv., DIN 933	0.09	
63-130-00	Hexagonal locking nut M16, galv., DIN 985	0.03	

Top unit 73

Galvanized. With adjustable spindle (\varnothing 73 mm). 1 top unit 73 left and 1 top unit 48 right are required to assemble a Triplex brace. Top unit 73 right includes hexagonal screws M16x40 and locking nuts M16.

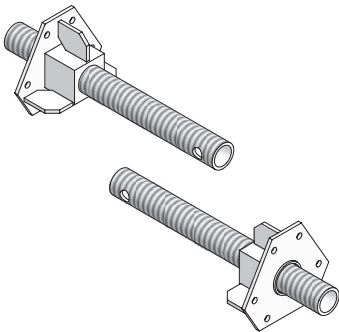

Ref. No.	Description / Application	m ²	kg
29-407-25	Top unit 73 (left-hand thread) black spindle, without screws	18.60	
29-407-20	Top unit 73 (right-hand thread) silver spindle, with screws	19.00	

Foot plate 73

Galvanized. Particularly sturdy foot plate for Triplex SB. Delivery includes screw M30x150 and nut M30.

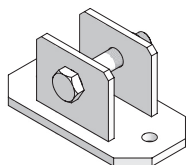

Ref. No.	Description / Application	m ²	kg
29-407-74 Foot plate 73	9.60	

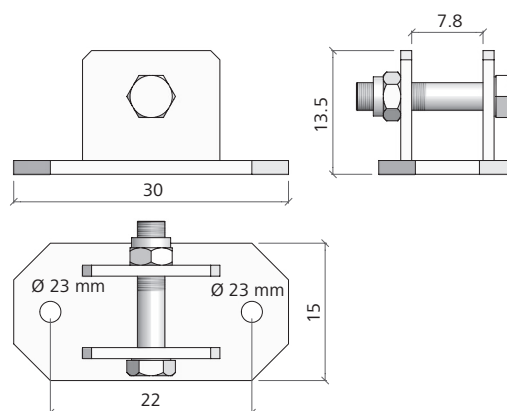

Safety mesh ... /2490

Painted steel. Robust steel mesh with reinforced edges and closed steel sheet to prevent small items from falling down. The mesh replaces railings, toe board and net in one single part. DIN EN 13374 Class A.

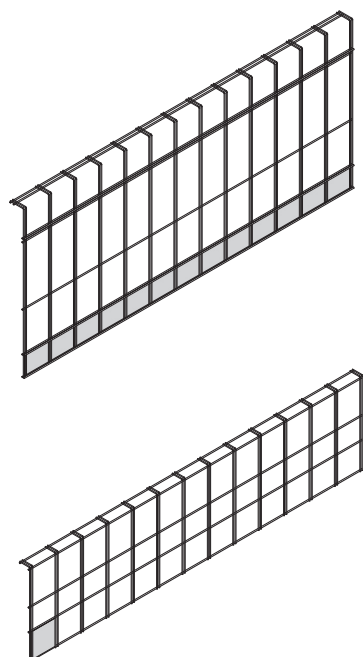

Ref. No.	Description / Application	m ²	kg
29-920-00 Safety mesh 1100/2490	15.00	
29-920-05 Safety mesh 600/2490	9.80	

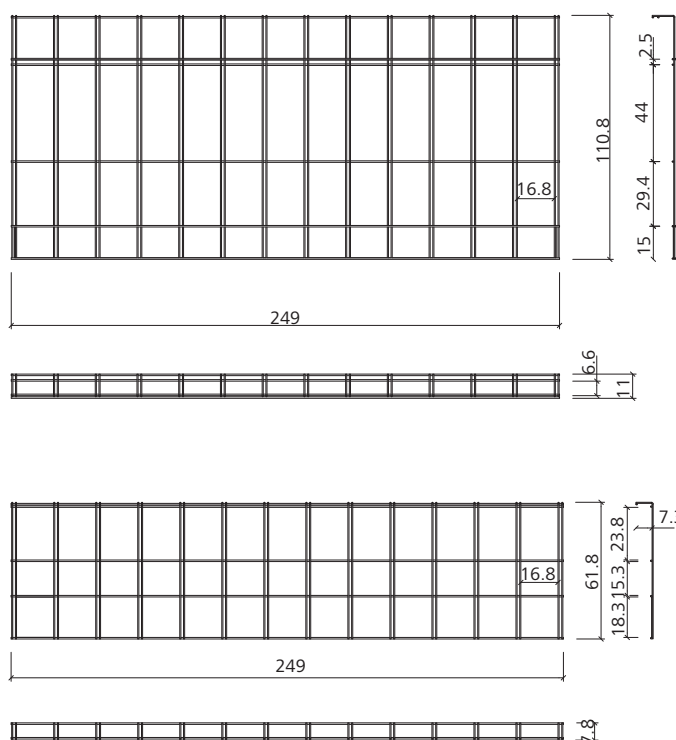

Tension belt

Not shown. For safety against wind load. 50 mm wide, reinforced loop 200 mm, cranked snap hook with safety flap, DIN EN 12195. Adm. load: 25 kN (straight), 50 kN (strapped). Is attached to climbing bracket KKK or bracket extension and with safety eye to concrete wall. This can be done at the cone from the previous pour.

Ref. No.	Description / Application	m ²	kg
29-930-10 Tension belt with hook and loop	3.80	
29-930-15 Tension belt with hook on both ends	3.90	

Holding plate

Galvanised, for base plates and slab edge formwork up to the height of 50 cm. With integrated nailing strip. Fixing in the ground with soil nail. Fixing in the base plate with anchor dowel.

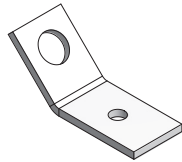

Ref. No.	Description / Application	m ²	kg
29-930-95 Holding plate	0.61	

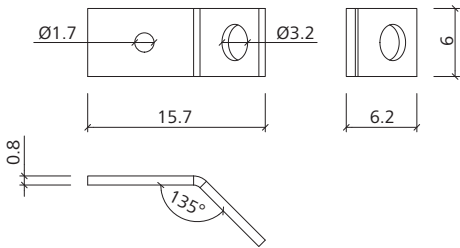

Side protection net 200/1000

Not shown. Size 2,00 m x 10,00 m, mesh width 100 mm, red colour. Integrated quick-release belt fasteners allow for a quick assembly of the protection net. Complies with German DIN 4420 standard and is approved by building authorities.

Ref. No.	Description / Application	m ²	kg
29-108-60 Side protection net 200/1000.....	6.50	

Quick-release belt fastener

Not shown. Allows for a quick assembly of side protection nets. Length 55 cm, belt width 25 mm, red colour. Approved by building authorities.

Ref. No.	Description / Application	m ²	kg
29-108-65 Quick-release belt fastener	0.01	

Railing clamp

Coated. Can be clamped to all types of beams and to free slab edges. Railing clamp 100: 100 cm high, clamping length 45 cm. Railing clamp 140: 140 cm high, clamping length 50 cm.

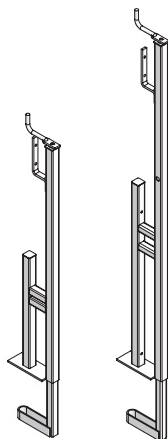

Ref. No.	Description / Application	m ²	kg
29-107-20 Railing clamp 100.....	7.90	
29-107-25 Railing clamp 140.....	10.10	

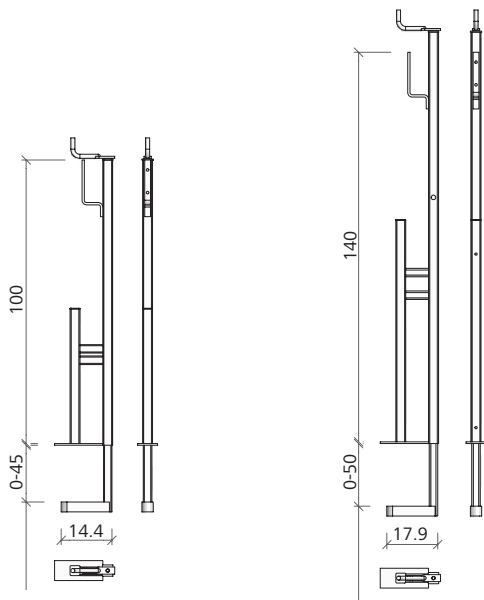

Guardrailing post

Galvanized. Is plugged into the walkway bracket.

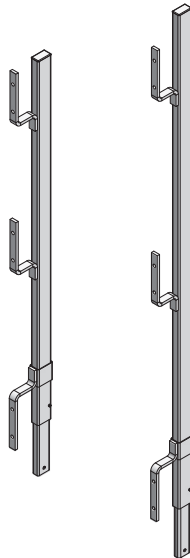

Ref. No.	Description / Application	m ²	kg
29-106-75	Guardrailing post 100.....	3.70	
29-106-85	Guardrailing post 140.....	4.70	

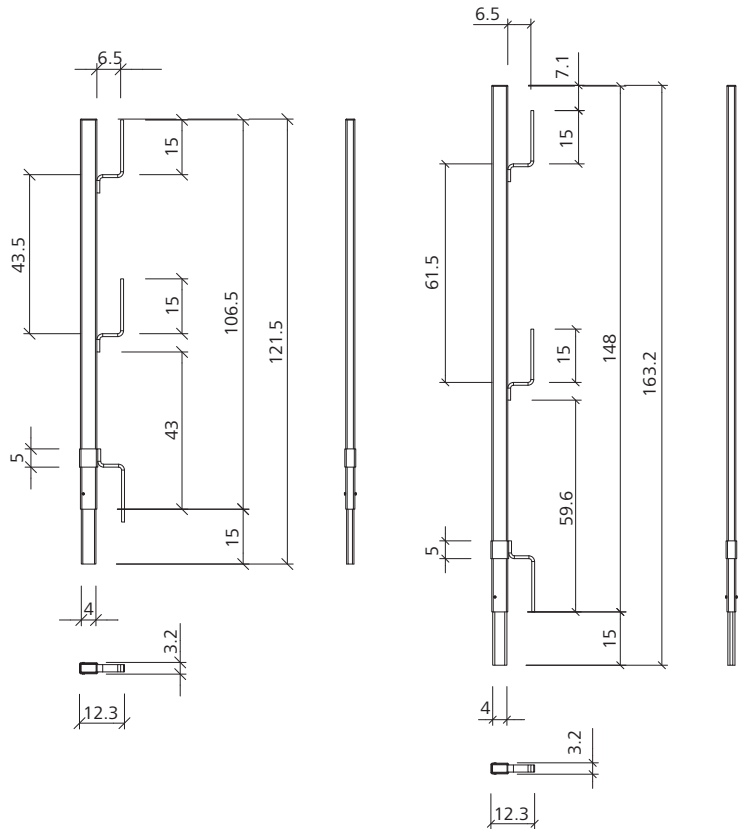

Guardrailing post 48

Galvanized. With manifold to be plugged into the walkway bracket and with 48 mm Ø tube to attach scaffold couplers.



Ref. No.	Description / Application	m ²	kg
29-106-80	Guardrailing post 48/120 (UK).....	5.50	

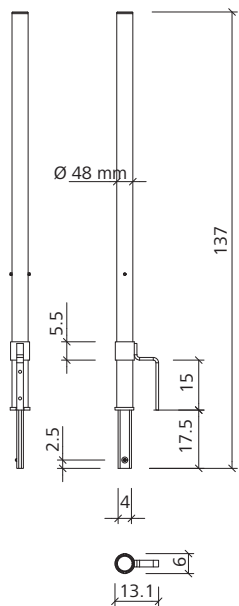

Universal shoe MFS

Galvanised; forms a fall protection device in conjunction with the MEVA guardrailing post and the safety mesh MFS. Can be used to provide lateral protection on horizontal and vertical components.

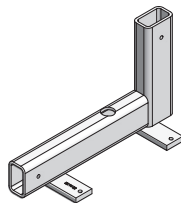

Ref. No.	Description / Application	m ²	kg
29-921-72 Universal shoe MFS	2.10	

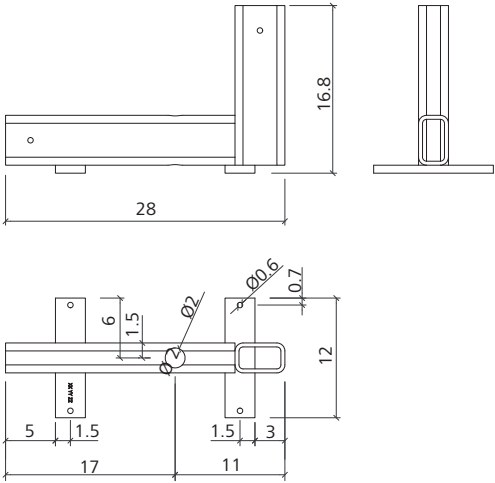

Clamp for Guardrailing post

Galvanized. Sliding part with spindle. suited for all common MEVA guardrailing posts (round and square). Adjustment range 0 - 45 cm. Usable for stop ends at slab edges and parapets.

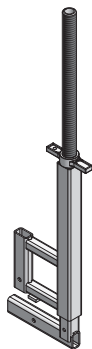

Ref. No.	Description / Application	m ²	kg
29-107-35 Universal clamp for guardrail post	9.80	

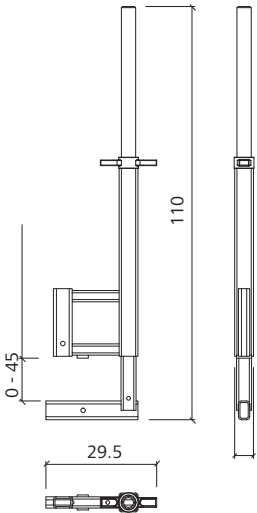

Concrete scraper

To remove remnants of concrete and other deposits on larger areas. with 10 replaceable hard metal plates. a ledge made of tool steel and wooden handle.

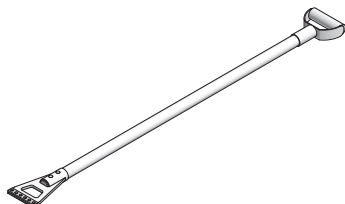

Ref. No.	Description / Application	m ²	kg
29-905-25	Concrete scraper 102/1300		1.50

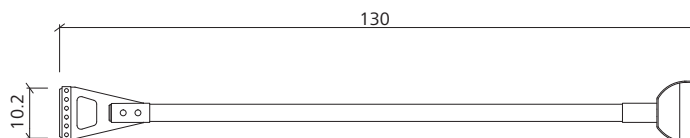

Concrete scraper – frame

To remove remnants of concrete on panel frames and alkus sheets. with 3. 6 or 10 replaceable hard metal plates. a ledge made of tool steel and wooden handle.

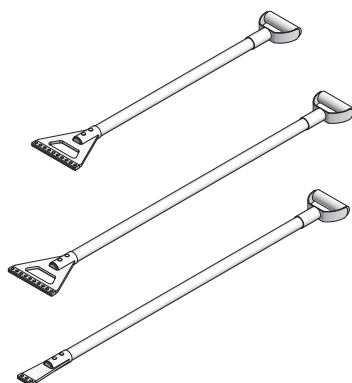

Ref. No.	Description / Application	m ²	kg
29-905-30	Concrete scraper 170/ 850		1.60
29-905-20	Concrete scraper 170/1300		1.90
29-905-17	Concrete scraper 54/1300		1.20

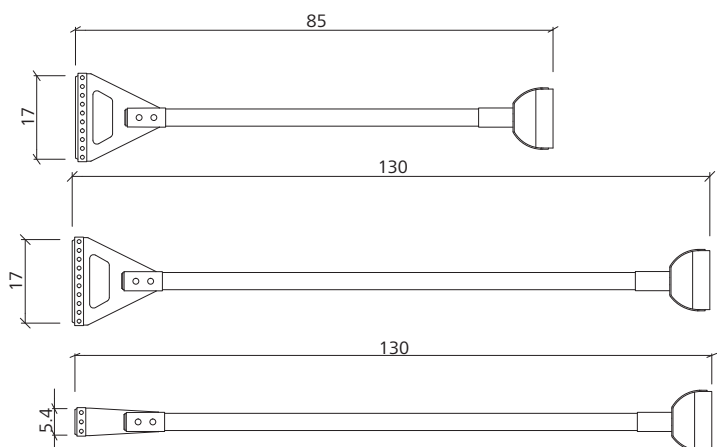

Concrete scraper – alkus

With convex edged blade. to scrape rough areas on alkus sheets. e.g. nail holes or scratches. It is only of limited use for removing remnants of concrete.

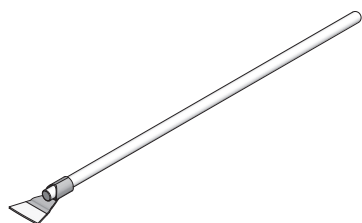

Ref. No.	Description / Application	m ²	kg
29-905-15	Concrete scraper 110/1300 alkus		0.80

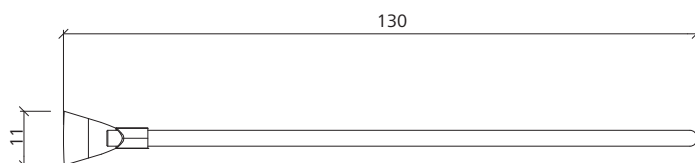

Spare ledge

Not shown. Replaceable steel ledge.

Ref. No.	Description / Application	m ²	kg
29-905-40	Spare ledge 170		0.10
29-905-45	Spare ledge 102		0.10

Hard-metal plates

Not shown. Set of 6 spare plates with bolts and nuts.

Ref. No.	Description / Application	m ²	kg
29-905-35	Hard-metal plates		0.13

Divinol Wax

Not shown. Paste-like solvent-based wax suitable for all formwork (wood, steel, plastic-coated). Rain resistant. Recommended for use on the XT taper ties.

Ref. No.	Description / Application	m ²	kg
29-203-30	Divinol pasty wax		1.10

MevaTrenn classic

Not shown. Universal release agent that can be applied to all types of facing. Usable for civil engineering and building projects as well as in precast concrete factories. Without solvents. Fast biodegradable according to CEC-L-33-A-94. Viscosity is 17 mm²/s/20°C. Water hazard class 1.

Ref. No.	Description / Application	m ²	kg
29-931-50	MevaTrenn classic (20 l can)		1.00
29-931-60	MevaTrenn classic (200 l barrel)		1.10

MevaTrenn pro

Not shown. Suited for absorbent and non-absorbent forming faces. Solvent-based. Evaporates when applied, leaving a very thin film of release agent on the facing. Especially recommended for formwork with alkali facing (apply sparingly by using the stainless steel jet). Water hazard class 1, i.e. generally not hazardous to water. Consumption: 1 litre for approx. 50 - 90 m².

Ref. No.	Description / Application	m ²	kg
29-203-45	MevaTrenn pro (20 l can)		1.00
29-203-97	MevaTrenn pro (200 l barrel)		0.90

MevaTrenn eco

Not shown. MevaTrenn eco carries the EU Eco-label of RAL gGmbH and fulfils Giscode BTM 10. Release agent based on environmentally neutral ester oils that contains no mineral oils or solvents and is not water-polluting. Suitable for all formwork up to a working temperature of 70°. Can be used up to DGNB quality level 3 according to the manufacturer.

Ref. No.	Description / Application	m ²	kg
29-931-75	MevaTrenn eco (20 l can)		1.00

Sprayer

Not shown. To allow for an even and sparing spraying of the forming surface. suited for (5 litre) MevaTrenn and wax.

Ref. No.	Description / Application	m ²	kg
29-903-71 MevaSprayer		5.50

Stainless steel jet

Not shown. For an evenly spread thin layer of MevaTrenn on alkus sheets which evaporates quickly. Sprays 0.26 l at 3 Bar.

Ref. No.	Description / Application	m ²	kg
29-203-94 Stainless steel jet		0.10

Tap for can

Not shown. Suitable for a 20 l container of MevaTrenn. it permits easy filling of smaller bins.

Ref. No.	Description / Application	m ²	kg
29-203-49 Tap for can		0.30

Storage box 120/100

Coated. Stackable. Can be used to store assembly locks, anchoring parts and other accessories. With removable partitions and a hinged front part. Stacking height 60 cm.

Ref. No.	Description / Application	m ²	kg
27-000-10 MEVA storage box 120/100		102.00

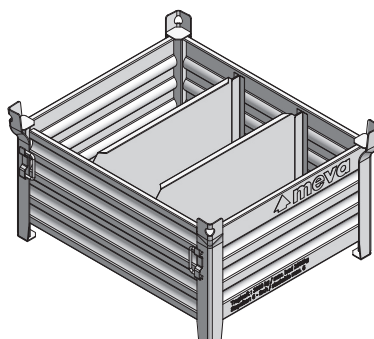

MEVA packing crate

Not shown. Wooden packaging for MEVA accessories. Height 80 cm (50 cm). L x W 120 x 80 cm.

Ref. No.	Description / Application	m ²	kg
27-000-90 Meva packing crate 80		48.00
27-000-92 Meva packing crate 50		38.00

Stacking rack

Coated. Is used to store and transport props. wooden girders. etc.

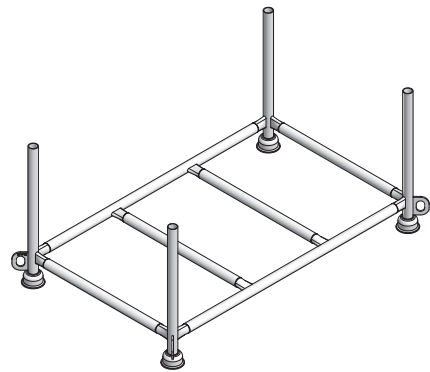

Ref. No.	Description / Application	m ²	kg
27-000-20	Stacking rack		34.56

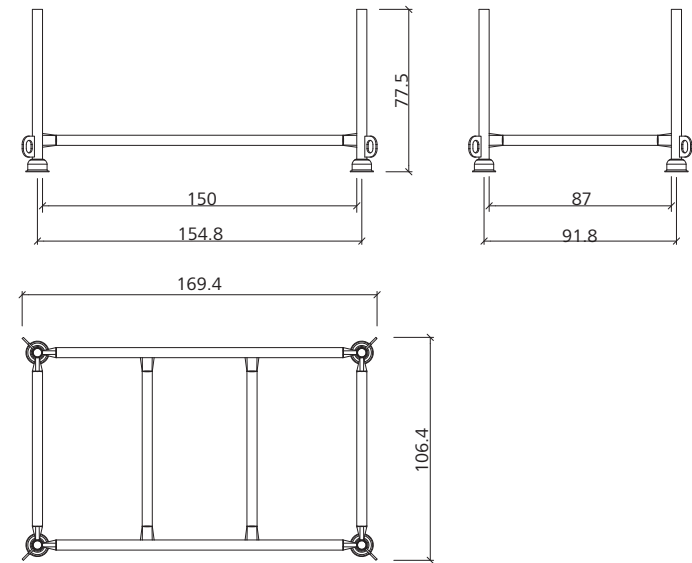

End plate connector DW15

Made of steel. galvanized. The rack is used to stack formwork panels (placed vertically, side by side) and is provided with crane eyes. For 10 panels with a profile height of 10 cm or 8 panels with a profile height of 12 cm. 4 retaining brackets 270/405 are used for panel height 270 cm. 4 retaining brackets 300/555 are used for panel height 300 cm

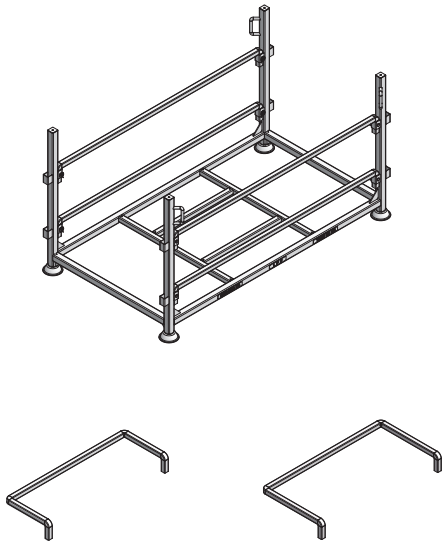

Ref. No.	Description / Application	m ²	kg
29-132-70	MEVA-Eco stacking rack for panels	85.00	
29-132-72	Eco retaining bracket 270/405	2.00	
29-132-74	Eco retaining bracket 300/555	3.00	
S23-0200	Strapping Machine Set	22.00	

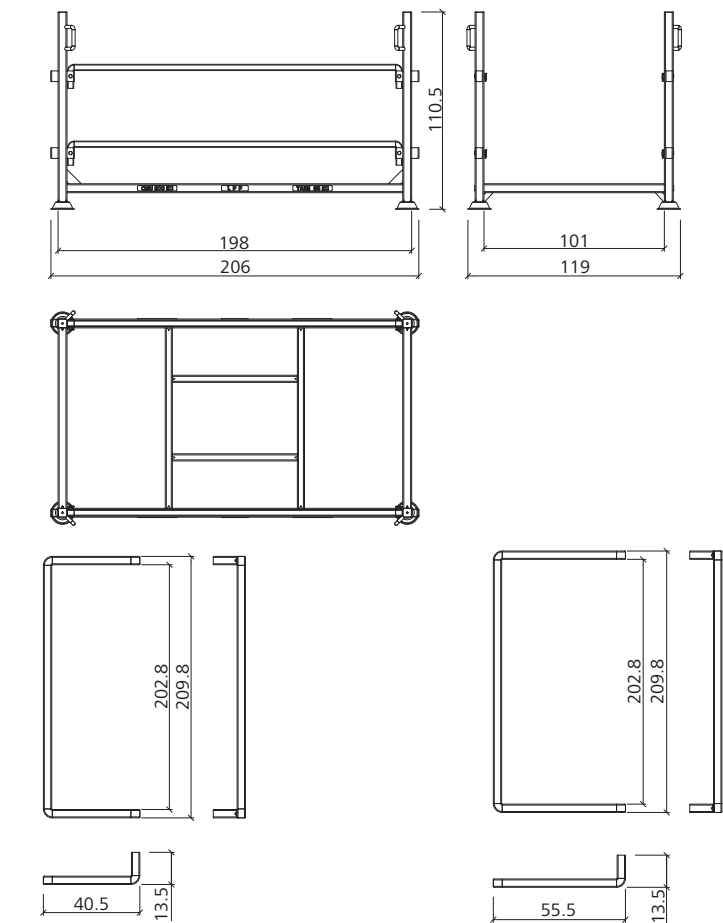

Filling nozzle

Is used when concrete can-not be poured from above. e.g. tunnel formwork. Connection with a manual gate valve. Operating pressure: 20 bar.

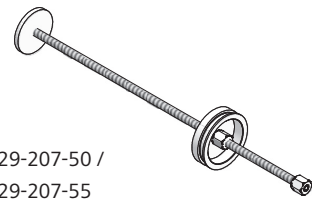
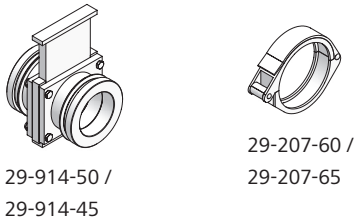

Ref. No.	Description / Application	m ²	kg
29-914-50	Manual gate valve SK 100 - 4½	19.00	
29-207-60	Lever coupling SK-H DN 100 - 4½	3.80	
29-207-50	Filling nozzle cleaner SK 100/800	7.20	
29-914-45	Manual gate valve SK 125 - 5½	15.60	
29-207-65	Lever coupling SK-H DN 125 - 5½	5.10	
29-207-55	Filling nozzle cleaner SK 125/800	9.60	

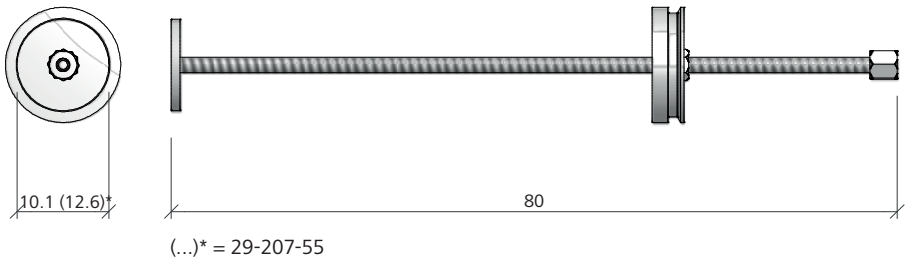
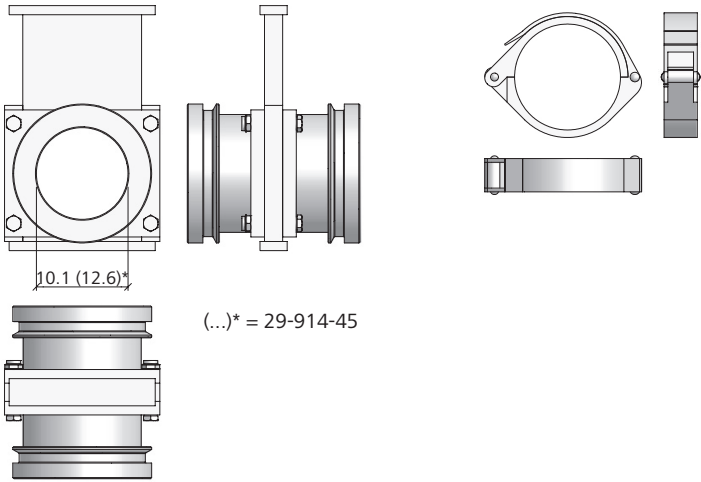

Notes

Grid of dots for notes.

Notes

Notes



MEVA Schalungs-Systeme GmbH

Industriestrasse 5
72221 Haiterbach
Germany

Tel. +49 7456 692-01
Fax +49 7456 692-66
info@meva.net
www.meva.net