

Product list

Please note

This product list includes all parts necessary for most applications.
For parts required for special applications, please refer to the MEVA
price list. Dimensions are in centimetres (cm) unless another measure
is shown.

Contents

AS assembly lock	26
Brace frame 250	27
Brace SRL.....	28
CF access platform.....	30
CF cantilever angle.....	31
CF column formwork.....	24
CF-column panel 60.....	25
CF-column panel 120.....	25
CF-column panel 270.....	25
CF-column panel 360.....	25
CF front railing.....	31
CF ladder fixture	33
CF scaffold bracket	30
CF spanner	26
CF steel sheet for sliding	34
CF transport device 130.....	35
CF transport wheel	34
Chamfer strip 15/15.....	27
Cotter pin 4	29
Double-jointed foot plate.....	29
Extension ladder	32
Flange screw 18.....	26
Formwork-prop connector	27
Head bolt 16/90	29
Ladder	32
Ladder connector	33
Linchpin 4.5.....	29
Push-pull prop R	28
Safety cage.....	33

CF column formwork

Construction height 12 cm, frame profile width 30 mm. The panels frames are made of closed steel profiles and are torsion-proof, corrosion-resistant. The panels are equipped with alkus facing. AS assembly locks guarantee a stepless, tight and perfectly aligned connection of stacked panels. Multi-function profiles allow for an easy, fast and safe attachment of accessories. Column cross sections are possible from 20 cm to 60 cm in increments of 5 cm. The panels are assembled like a windmill and tied with CF spanners across the corners.

Ref. No.	Description / Application	m ²	kg
23-603-10	CF column panel AL 20 360	2.16	200.00
23-603-20	CF column panel AL 20 270	1.62	150.50
23-603-30	CF column panel AL 20 120	0.72	72.20
23-603-40	CF column panel AL 20 60	0.36	39.30

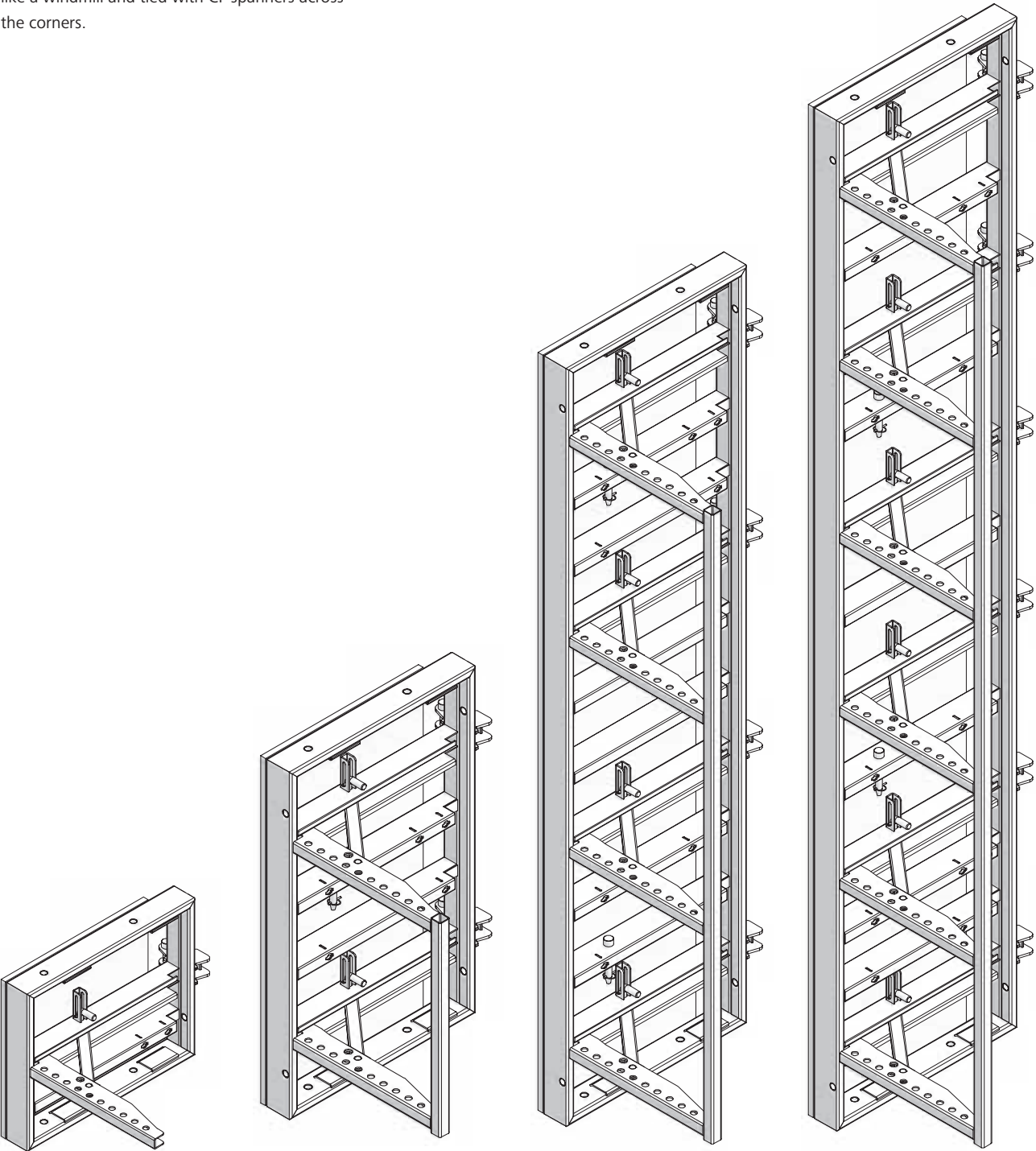

Column Formwork

CF-column panel 360

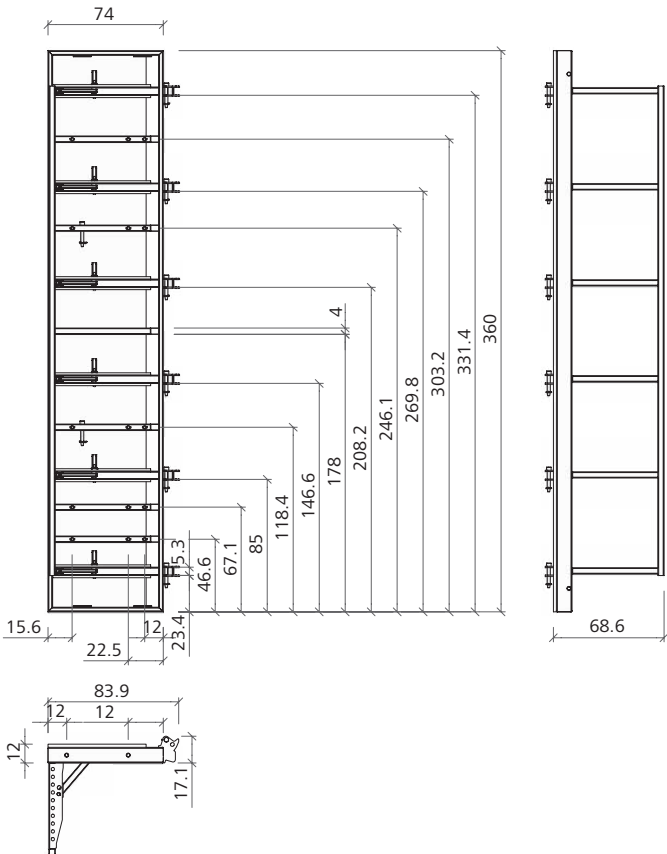

CF-column panel 120

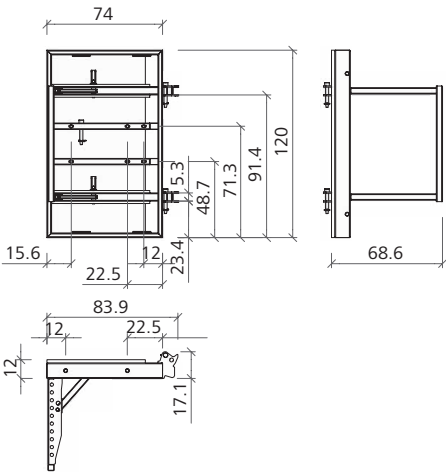

CF-column panel 270

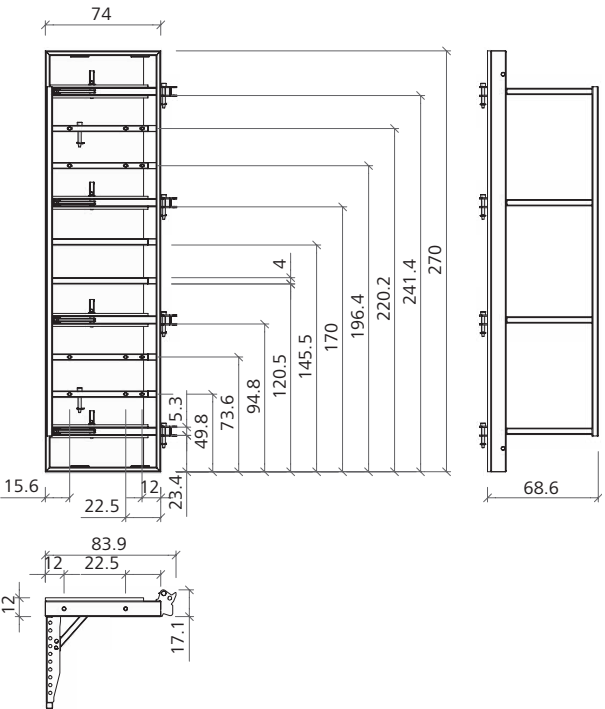

CF-column panel 60

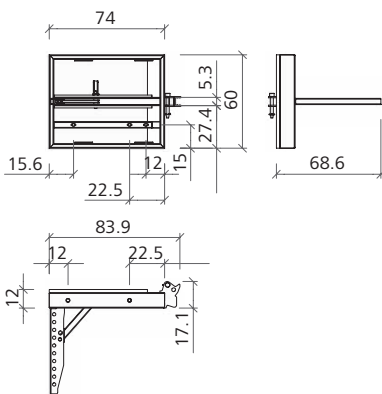

Column Formwork

CF spanner

Galvanized. Is used to open and close the CaroFalt. The required quantity depends on the panel height (h):
6 for h 360 cm, 4 for h 270 cm, 2 for h 120 cm, 1 for h 60 cm.

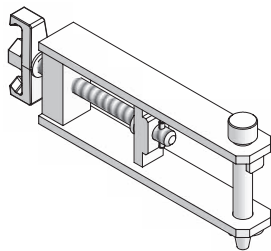

Ref. No.	Description / Application	m ²	kg
29-413-65 CF spanner		4.63

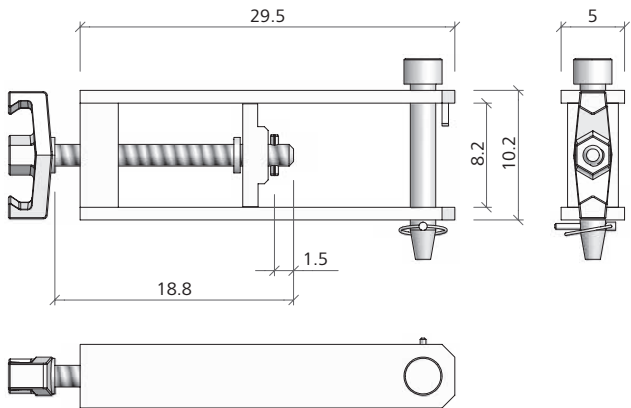

Flange screw 18

Galvanized. DW thread Ø 15 mm. Is used to attach accessories such as brace frames, push-pull props, CF brackets, CF-ladder fixtures, etc. Length of thread 18 cm.

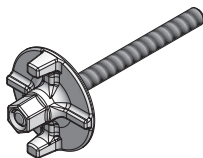

Ref. No.	Description / Application	m ²	kg
29-401-10 Flange screw 18		1.05

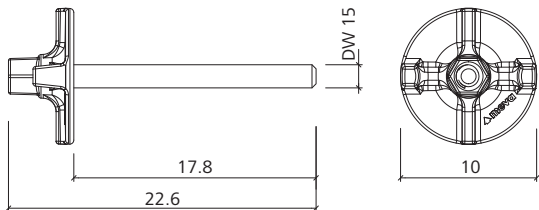

AS assembly lock

Galvanized. Tightly connects and aligns CaroFalt panels.
Clamping length 8 cm. 2 AS assembly locks are required per panel joint.

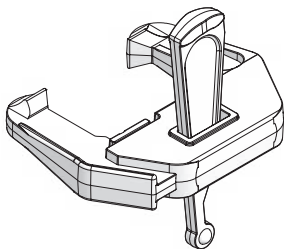

Ref. No.	Description / Application	m ²	kg
29-205-00 AS assembly lock		2.00

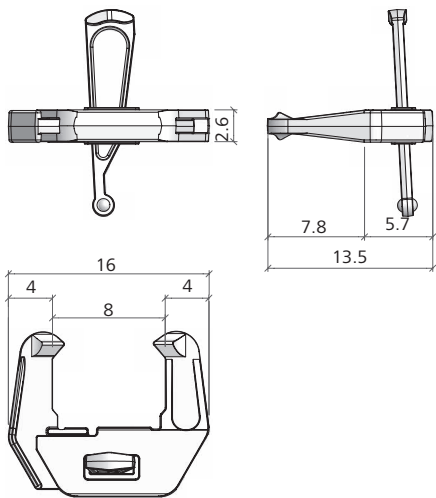

Column Formwork

Chamfer strip 15/15

PVC; with perforated strip. Length 2.50 m.

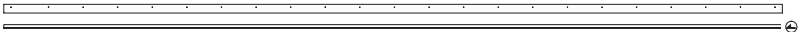
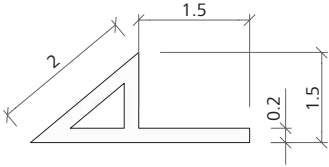

Ref. No.	Description / Application	m ²	kg
29-902-90 Chamfer strip 15/15, PVC.....		0.50

Brace frame 250

Galvanized. Available with formwork-prop connector. Is used to align and brace the formwork. Consists of a push-pull prop R 250 (190 - 320 cm), a brace SRL 120 (90 - 150 cm) and a double-jointed footplate. The formwork-prop connectors are attached to the formwork with flange screws 18.

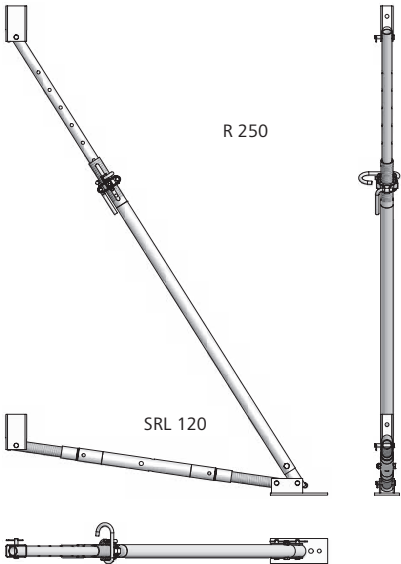
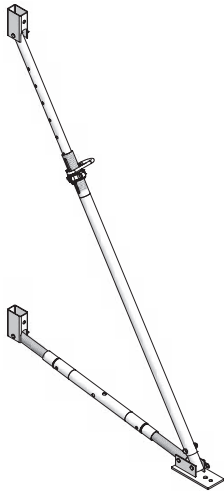

Ref. No.	Description / Application	m ²	kg
29-109-20 Brace frame 250 with formwork-prop connector.....		33.20

Formwork-prop connector

Galvanized. Connects braces, brace frames and push-pull props (max. Ø 48 mm) to the multi-function profile with a flange screw 18. Delivery includes head bolt 16/90 and cotter pin 4.

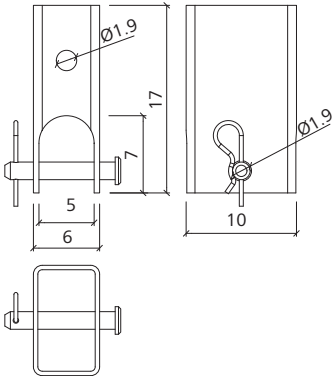
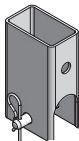

Ref. No.	Description / Application	m ²	kg
29-804-85 Formwork-prop connector		1.65

Column Formwork

Push-pull prop R

Galvanized. Guarantee tensile and compression strength. Align and brace wall formwork. Length of thread 20.6 cm. Foot plates and formwork-prop-connectors to be ordered separately.

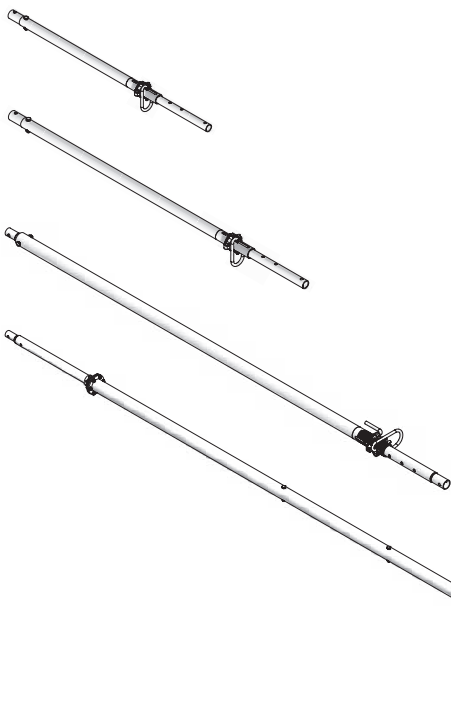

Ref. No.	Description / Application	m ²	kg
29-109-40 Push-pull prop R 160.....(135-200).....	12.60	
29-109-60 Push-pull prop R 250.....(190-320).....	17.20	
29-109-80 Push-pull prop R 460(340-520).....	34.00	
29-109-85 Push-pull prop R 630.....(510-760).....	57.00	

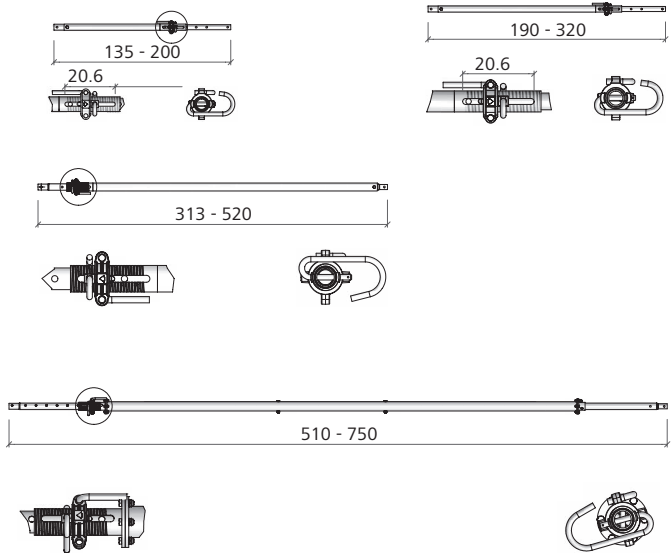

Brace SRL

Galvanized. Guarantees tensile and compression strength. Consists of a right and left-hand spindle as well as a revolving central part. Is used to align and support wall formwork. The footplate and the formwork-prop connector must be ordered separately.

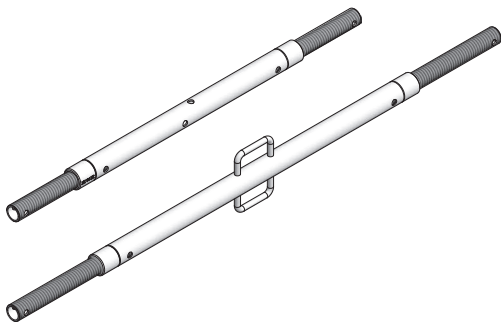

Ref. No.	Description / Application	m ²	kg
29-108-80 Brace SRL 120.....(91-150).....	8.79	
29-108-90 Brace SRL 170.....(120-220).....	11.50	

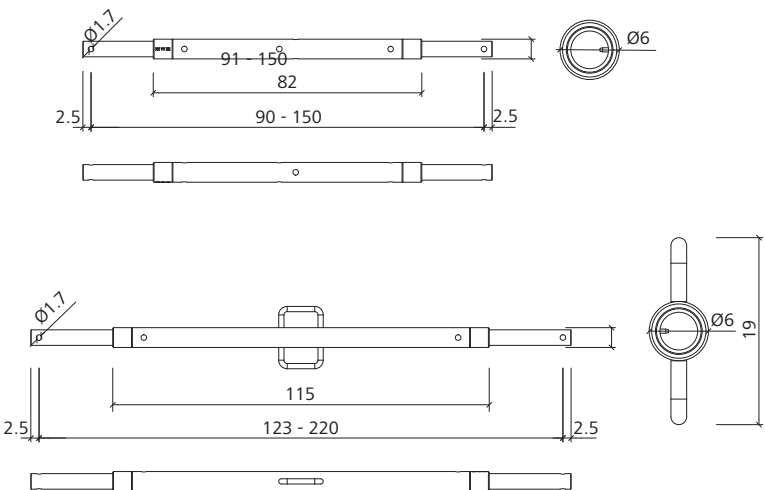

Column Formwork

Double-jointed foot plate

Galvanized. Delivery includes head bolt 16/90 and cotter pin 4. Serves as foot plate for brace frames 250 and as connector for braces and push-pull props up to Ø 57 mm.

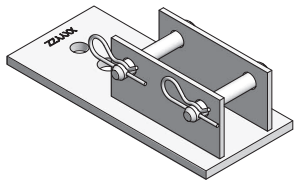

Ref. No.	Description / Application	m²	kg
29-402-32 Double-jointed foot plate		4.00

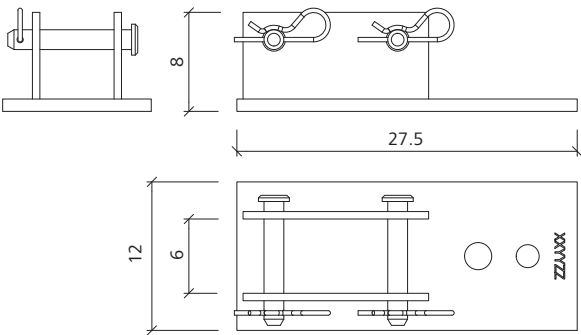

Head bolt 16/90

Galvanized. Is used to attach push-pull props and braces to foot plates and formwork-prop connectors.



Ref. No.	Description / Application	m²	kg
42-413-50 Head bolt 16/90, galv.		0.17

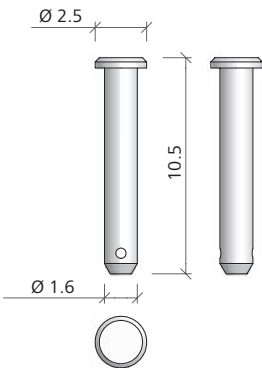

Cotter pin 4

Galvanized. Locks the head bolt.

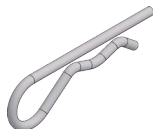

Ref. No.	Description / Application	m²	kg
62-010-04 Cotter pin 4		0.02

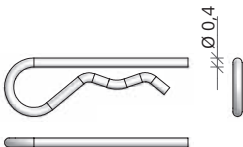

Linchpin 4.5

Not shown. Galvanized. Locks the head bolt.

Ref. No.	Description / Application	m²	kg
62-010-03 Linchpin 4.5		0.01

Column Formwork

CF access platform

With pluggable guard-railing; galvanized steel frame covered with non-slipping aluminium.
Load capacity 2 kN/m². Is attached to the CF column panels with a CF scaffold bracket and a CF cantilever angle.

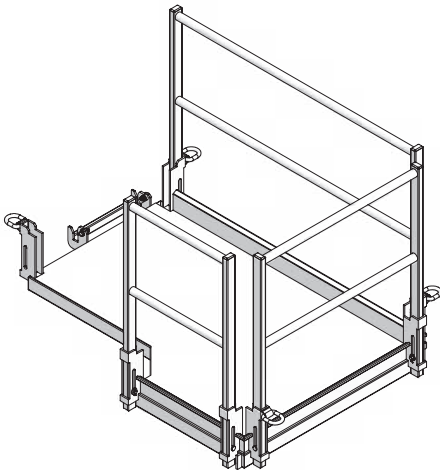

Ref. No.	Description / Application	m ²	kg
29-414-10 CF access platform		106.50

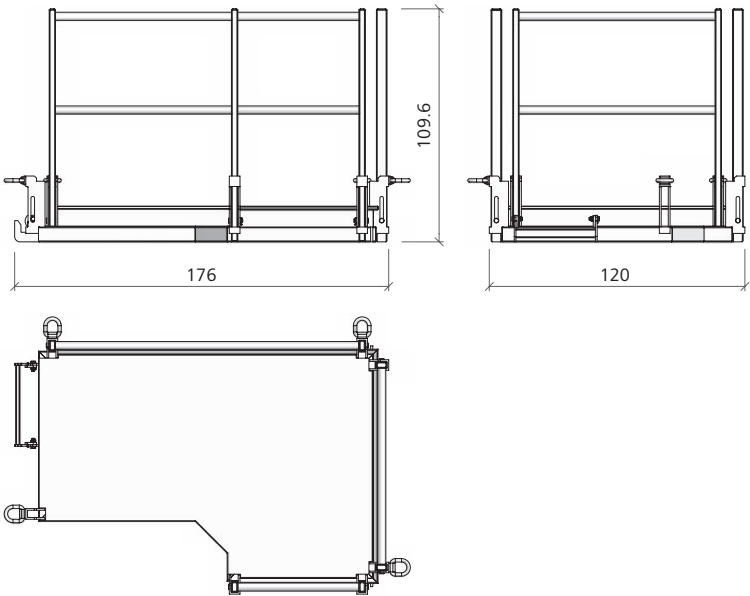

CF scaffold bracket

Galvanized. Connects the CaroFalt and the CF access platform. Is attached to the CF column panel with a flange screw 18 and a CF transport device 130 through the transport hole. The CF access platform is attached with the integrated hammerhead screw.

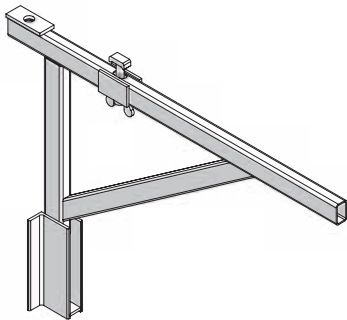

Ref. No.	Description / Application	m ²	kg
29-414-15 CF scaffold bracket.....		9.50

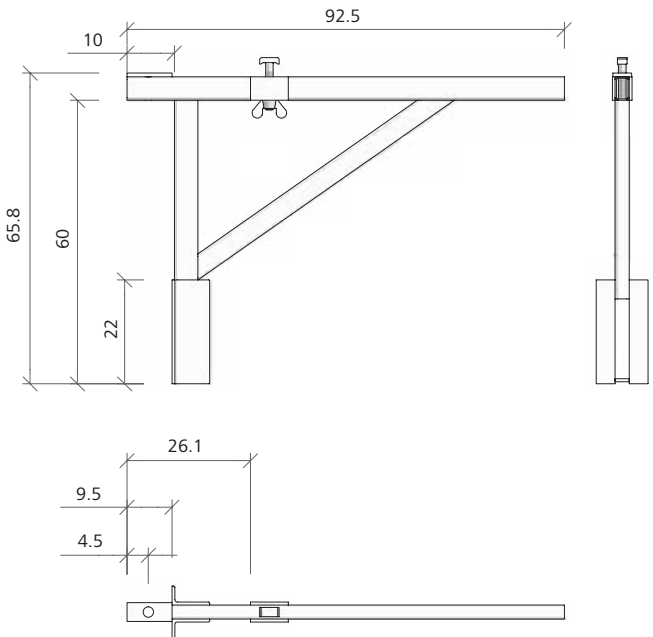

Column Formwork

CF cantilever angle

Galvanized. Is attached to the CF column panel with CF transport device 130 through the transport hole. The CF access platform is secured with the integrated hammerhead screw.

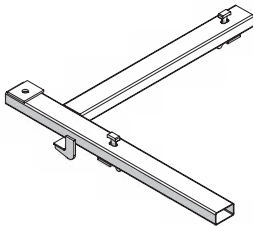

Ref. No.	Description / Application	m²	kg
29-414-20	CF cantilever angle		14.70

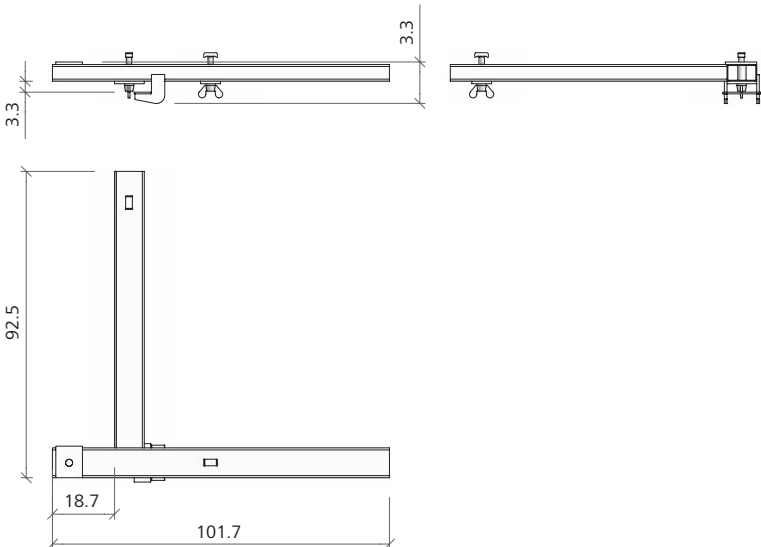

CF front railing

Galvanized. Is plugged into the CF-access platform.

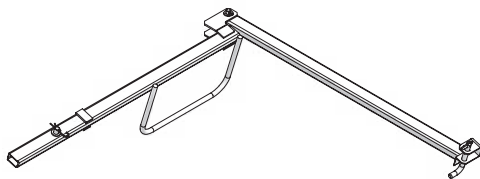

Ref. No.	Description / Application	m²	kg
29-414-25	CF front railing		11.00

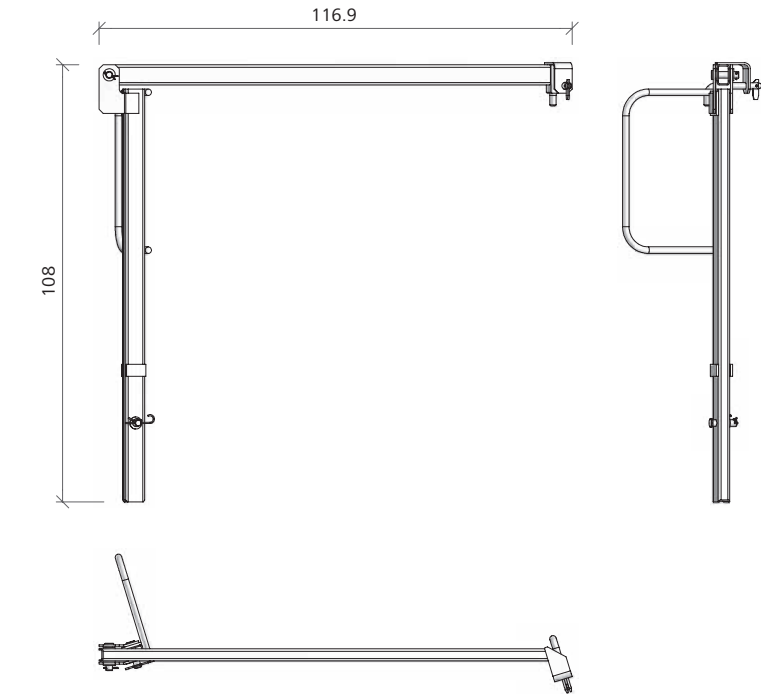

Column Formwork

Ladder

Galvanized. Is hooked into the CF-access platform and automatically secured. Can be extended with extension ladders. Safety cages are required for operational safety.

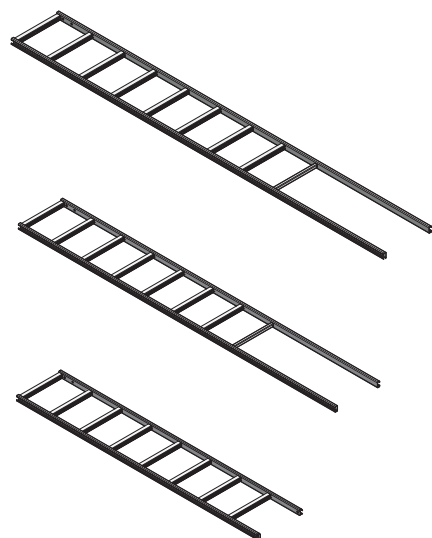

Ref. No.	Description / Application	m ²	kg
29-414-50 Ladder 348	23.20	
29-414-55 Ladder 318	21.10	
29-416-50 Ladder 243	17.20	

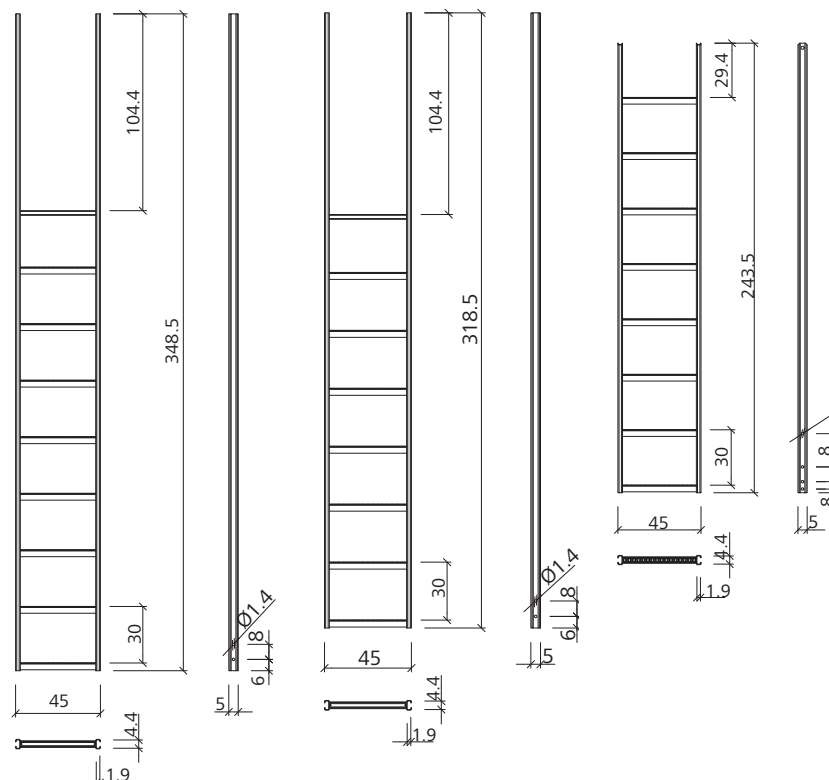

Extension ladder

Galvanized. Depending on the required height, the extension ladder is either hooked into the steps of the ladder or bolted to the ladder with the ladder connector. The extension ladder must be secured with the CF-ladder fixture. An additional extension in increments of 30 cm is achieved by hooking an extension ladder into the appropriate step.

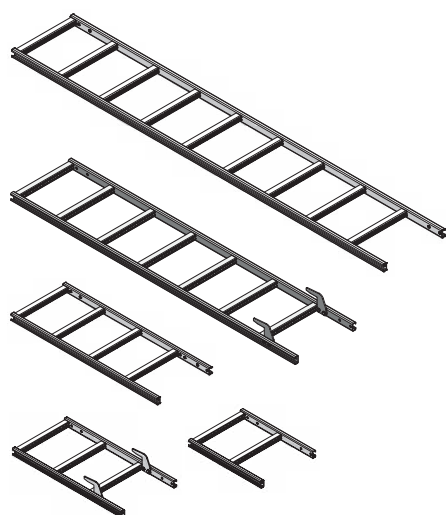

Ref. No.	Description / Application	m ²	kg
29-416-52 Extension ladder 270	19.20	
29-414-60 Extension ladder 210	15.80	
29-416-55 Extension ladder 120	8.50	
29-416-60 Extension ladder 90	7.40	
29-416-62 Extension ladder 60	4.40	

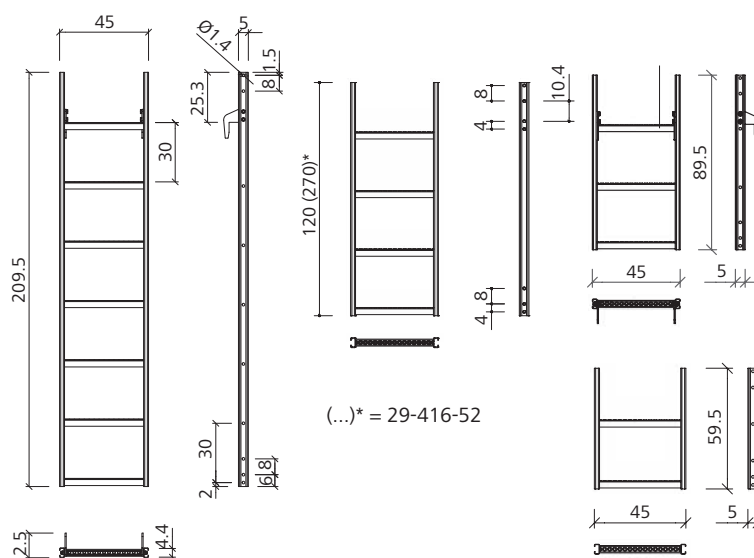

Column Formwork

Ladder connector

Galvanized. Connects the joint of two extension ladders without the need to hook one ladder into a step of the other.

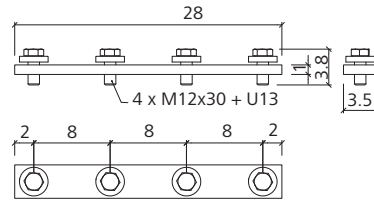
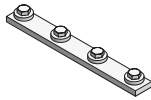

Ref. No.	Description / Application	m ²	kg
29-414-70 Ladder connector.....		1.03

Safety cage

Galvanized. Internal Ø 70 cm. Protects workers when ascending and descending the ladder. The safety cages are attached to the (extension) ladders with the integrated hammerhead screws.

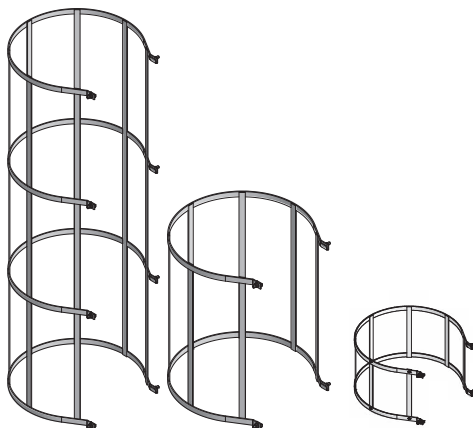

Ref. No.	Description / Application	m ²	kg
29-414-85 Safety cage 210	27.60	
29-414-90 Safety cage 85	12.10	
29-416-90 Safety cage 40	8.20	

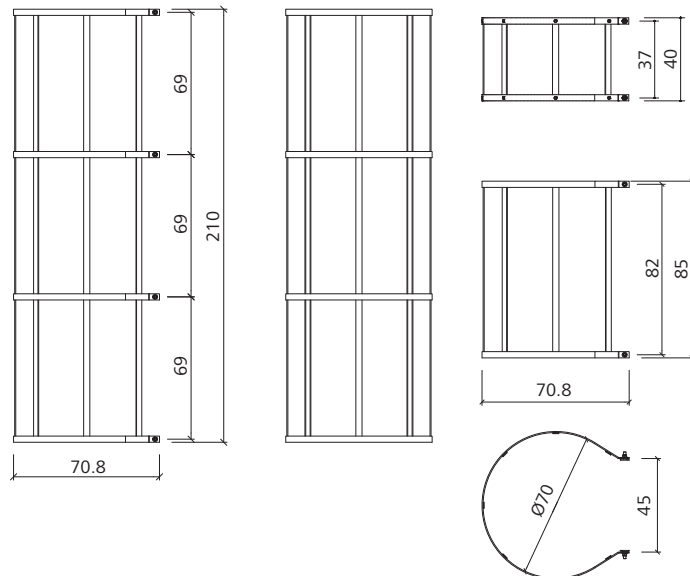

CF ladder fixture

Galvanized. Is attached to a multi-function profile of the CaroFalt with a flange screw 18. Two CF-ladder fixtures are required for heights from 3.60 m, three for heights from 4.80 m.

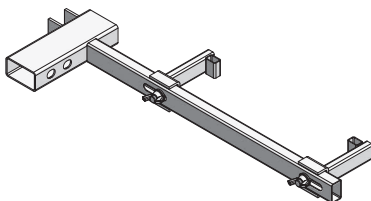

Ref. No.	Description / Application	m ²	kg
29-414-65 CF ladder fixture.....		5.00

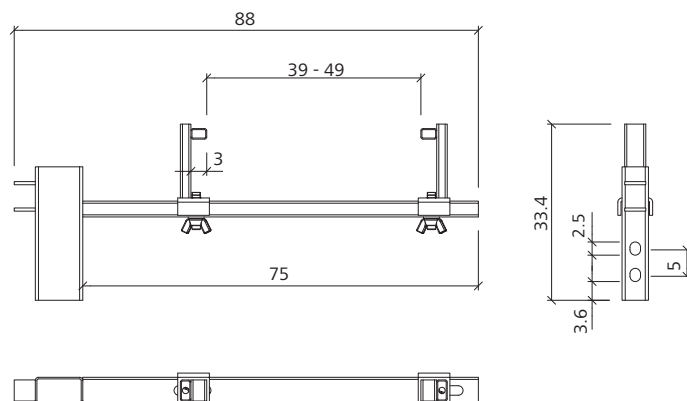

Column Formwork

CF transport wheel

Galvanized. Hard rubber wheels with little rolling friction. For the horizontal transport of closed column formwork. Load capacity 600 kg per wheel. Spindle range 7.5 cm. Always 4 wheels are required for a formwork unit. May be used up to a formwork height of 3.60 m.

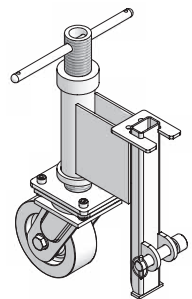

Ref. No.	Description / Application	m ²	kg
29-413-50 CF transport wheel.....		14.50

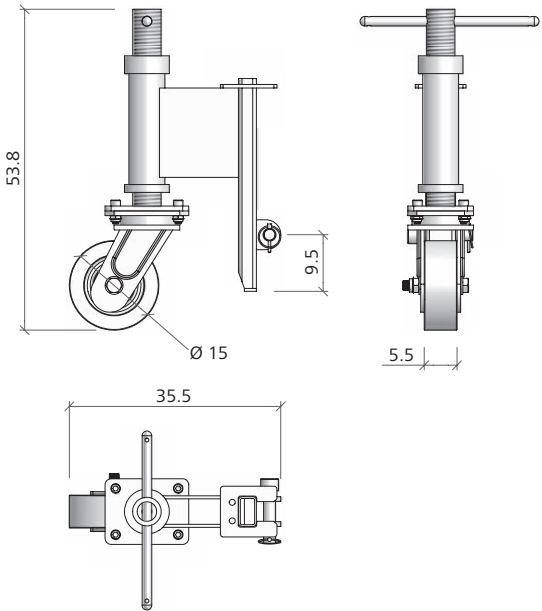

CF steel sheet for sliding

Galvanized. Protects the alkus facing and the panel frames from damage when opening and closing the formwork. Is attached to tranport holes and secured with clip pins. Four steel sheets are required per column from. Delivery includes clip pins.

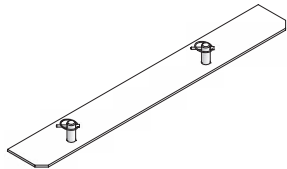

Ref. No.	Description / Application	m ²	kg
29-413-60 CF steel sheet for sliding.....		3.15

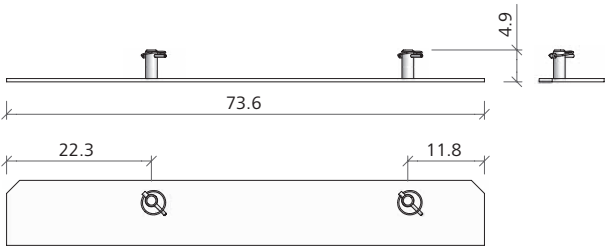

CF transport device 130

For the vertical transport of the CF-column formwork. Is bolted. Load capacity 12 kN (1.2 tons). Always 3 CF transport devices are required per column unit. For use and safety test of the CF transport device refer to its Operating Instructions.

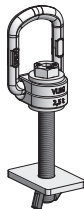

Ref. No.	Description / Application	m²	kg
29-413-70 CF transport device 130		1.65

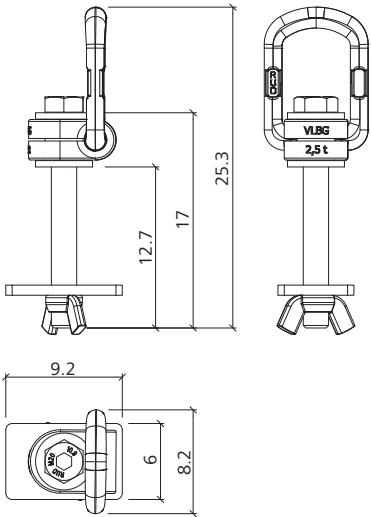



MEVA Schalungs-Systeme GmbH

Industriestrasse 5
72221 Haiterbach
Germany

Tel. +49 7456 692-01
Fax +49 7456 692-66
info@meva.net
www.meva.net